

SHARP®

DIGITAL FULL COLOR MULTIFUNCTIONAL SYSTEM
MX-2610N/MX-3110N/MX-3610N

QUICK START GUIDE

Keep this manual close at hand for reference whenever needed.



For the users of the fax function

ABOUT THE TELEPHONE CONSUMER PROTECTION ACT OF 1991

The Telephone Consumer Protection Act of 1991 makes it unlawful for any person to use a computer or other electronic device, including FAX machines, to send any message unless such message clearly contains in a margin at the top or bottom of each transmitted page or on the first page of the transmission, the date and time it is sent and an identification of the business or other entity, or other individual sending the message and the telephone number of the sending machine or such business, other entity, or individual.
(The telephone number provided may not be a 900 number or any other number for which charges exceed local or long-distance transmission charges.)

In order to program this information into your FAX machine, you should complete the following steps:
See "Own Name and Destination Set" of Operation Guide.

Important safety instructions

- If any of your telephone equipment is not operating properly, you should immediately remove it from your telephone line, as it may cause harm to the telephone network.
- Never install telephone wiring during a lightning storm.
- Never install telephone jacks in wet locations unless the jack is specifically designed for wet locations.
- Never touch uninsulated telephone wires or terminals unless the telephone line has been disconnected at the network interface.

■ FCC Notice to users:

This equipment complies with Part 68 of the FCC rules and the requirements adopted by the ACTA.

On this equipment is a label that contains, among other information, a product identifier in the format US:AAAEQ##TXXXX.

If requested, this number must be provided to the telephone company.

The REN is used to determine the number of devices that may be connected to a telephone line.

Excessive RENs on a telephone line may result in the devices not ringing in response to an incoming call.

In most but not all areas, the sum of RENs should not exceed five (5.0).

To be certain of the number of devices that may be connected to a line, as determined by the total RENs, contact the local telephone company.

For products approved after July 23, 2001, the REN for this product is part of the product identifier that has the format US:AAAEQ##TXXXX.

The digits represented by ## are the REN without a decimal point (e.g., 03 is a REN of 0.3).
For earlier products, the REN is separately shown on the label.

If this equipment causes harm to the telephone network, your telephone company may disconnect your service temporarily. If possible, They will notify you in advance. If advance notice is not practical, you will be notified as soon as possible. You will also be advised of your right to file a complaint with the FCC.

Your telephone company may make changes in its facilities, equipment, operations, or

- Use caution when installing or modifying telephone lines.
- Avoid using a telephone (other than a cordless type) during an electrical storm. There may be a remote risk of electric shock from lightning.
- Do not use a telephone to report a gas leak in the vicinity of the leak.
- Do not install or use the machine near water, or when you are wet. Take care not to spill any liquids on the machine.
- Save these instructions.

procedures that could affect the operation of your equipment. If this happens, the telephone company will provide advance notice in order for you to make necessary modifications to maintain uninterrupted service. If the equipment is causing harm to the telephone network, your telephone company may ask you to disconnect the equipment until the problem is resolved.

If you have any questions or problems which cannot be solved by reading this manual, please contact.

Sharp Electronics Corporation 1 Sharp Plaza, Mahwah, NJ 07495 Telephone: 1-800-BE-SHARP
--

A plug and jack used to connect this equipment to the premises wiring and telephone network must comply with the applicable FCC Part 68 rules and requirements adopted by the ACTA. A compliant telephone cord and modular plug is provided with this product. It is designed to be connected to a compatible modular jack that is also compliant. See installation instructions for details.

This equipment connects to the telephone network through a standard USOC RJ-11C network interface jack.

If your home has specially wired alarm equipment connected to the telephone line, ensure the installation of this equipment does not disable your alarm equipment.

If you have questions about what will disable alarm equipment, consult your telephone company or a qualified installer.

NOTICE for users in the USA

BE SURE TO ASK YOUR AUTHORIZED SHARP DEALER ABOUT THE WARRANTY THAT YOUR SELLING DEALER EXTENDS TO YOU. In order to assure you, the end-user, of warranty protection, Sharp extends a limited warranty to each of its authorized dealers and, in turn, requires each of its authorized dealers to extend its own warranty to you on terms that are no less favorable than those given to the dealer by Sharp. You should be aware, however, that Sharp does not itself extend any warranties, either express or implied, directly to you, the end-user, and no one is authorized to make any representations or warranties on behalf of Sharp. Specifically, SHARP DOES NOT EXTEND TO YOU, THE END-USER, ANY EXPRESS WARRANTY OR ANY IMPLIED WARRANTY OF MERCHANTABILITY, FITNESS FOR USE OR FITNESS FOR ANY PARTICULAR PURPOSE IN CONNECTION WITH THE HARDWARE, SOFTWARE OR FIRMWARE EMBODIED IN, OR USED IN CONJUNCTION WITH THIS PRODUCT. Sharp is not responsible for any damages or loss, either direct, incidental or

NOTICE FOR USERS IN CANADA

“NOTICE : This product meets the applicable Industry Canada technical specifications.”

“NOTICE : The Ringer Equivalence Number is an indication of the maximum number of devices allowed to be connected to a telephone interface. The termination on an interface may consist of any combination of devices subject only to the requirement that the sum of the RENs of all the devices does not exceed five.”

The REN of this equipment is indicated on the facsimile expansion kit.

This equipment may not be used on coin service provided by the telephone company.

Connection to party lines service is subject to state tariffs.

Contact your state's public utility commission, public service commission or corporation commission for more information.

consequential, which you, the end-user, may experience as a result of your purchase or use of the hardware, software or firmware embodied in or used in conjunction with this Product. Your sole remedy, in the event that you encounter any difficulties with this Product, is against the authorized dealer from which you purchased the Product.

MX-2610N/MX-3110N/MX-3610N Digital Full color Multifunctional System

In the event that this authorized dealer does not honor its warranty commitments, please contact the General Manager, Business Products Group, Sharp Electronics Corporation, 1 Sharp Plaza, Mahwah, NJ 07495-1163, so that Sharp can try to help assure complete satisfaction of all the warranty rights to which you are entitled from the authorized dealer.

AVIS POUR NOS UTILISATEURS AU CANADA

AVIS : Le présent matériel est conforme aux spécifications techniques applicables d'Industrie Canada.

Remarque : L'indice d'équivalence de la sonnerie (IES) sert à indiquer le nombre maximal de terminaux qui peuvent être raccordés à une interface téléphonique. La terminaison d'une interface peut consister en une combinaison quelconque de dispositifs, à la seule condition que la somme d'indices d'équivalence de la sonnerie de tous les dispositifs n'excède pas 5.

L'indice d'équivalence de la sonnerie (IES) de cet équipement est indiqué sur le kit d'extension télécopieur.

Sharp Electronics of Canada Ltd.

335 Britannia Road East,
Mississauga, Ontario, L4Z 1W9
Canada

Each instruction also covers the optional units used with these products.

■ **Caution!**

For complete electrical disconnection, pull out the main plug.

The socket-outlet shall be installed near the equipment and shall be easily accessible.

■ **FAX interface cable and Line cable**

These special accessories must be used with the device.

To reduce the risk of fire, use only UL-Listed No.26 AWG or larger telecommunication line cord.

■ **FOR YOUR RECORDS ...**

To protect against loss or theft, record and retain for reference the machine's serial number located at the lower left corner of the left side of the machine.

Model Number _____

Serial Number _____

Date of Purchase _____

Place of Purchase _____

Authorized Sharp Printer _____

Service Department Number _____

■ **Notice for Users in U.S.A.**

EMC (this machine and peripheral devices)

■ **WARNING:**

FCC Regulations state that any unauthorized changes or modifications to this equipment not expressly approved by the manufacturer could void the user's authority to operate this equipment.

Shielded interface cables must be used with this equipment to maintain compliance with EMC regulations.



This equipment has been tested and found to comply with the limits for a Class A digital device, pursuant to Part 15 of the FCC Rules.

These limits are designed to provide reasonable protection against harmful interference when the equipment is operated in a commercial environment. This equipment generates, uses, and can radiate radio frequency energy and, if not installed and used in accordance with the instruction manual, may cause harmful interference to radio communications. Operation of this equipment in a residential area is likely to cause harmful interference in which case the user will be required to correct the interference at his own expense.

This machine contains the software having modules developed by Independent JPEG Group.

This product includes Adobe® Flash® technology of Adobe Systems Incorporated.
Copyright© 1995-2007 Adobe Macromedia Software LLC. All rights reserved.

SOFTWARE LICENSE

The SOFTWARE LICENSE will appear when you install the software from the CD-ROM. By using all or any portion of the software on the CD-ROM or in the machine, you are agreeing to be bound by the terms of the SOFTWARE LICENSE.

The explanations in this manual are based on American English and the North American version of the software.
Software for other countries and regions may vary slightly from the North American version.



- The explanations in this manual assume that you have a working knowledge of your Windows or Macintosh computer.
- For information on your operating system, please refer to your operating system manual or the online Help function.
- The explanations of screens and procedures in this manual are primarily for Windows Vista® in Windows® environments. The screens may vary depending on the version of the operating system.
- Considerable care has been taken in preparing this manual. If you have any comments or concerns about the manual, please contact your dealer or nearest SHARP Service Department.
- This product has undergone strict quality control and inspection procedures. In the unlikely event that a defect or other problem is discovered, please contact your dealer or nearest SHARP Service Department.
- Aside from instances provided for by law, SHARP is not responsible for failures occurring during the use of the product or its options, or failures due to incorrect operation of the product and its options, or other failures, or for any damage that occurs due to use of the product.



Products that have earned the ENERGY STAR® are designed to protect the environment through superior energy efficiency.

■ Warranty

While every effort has been made to make this document as accurate and helpful as possible, SHARP Corporation makes no warranty of any kind with regard to its content. All information included herein is subject to change without notice. SHARP is not responsible for any loss or damages, direct or indirect, arising from or related to the use of this operation manual.

© Copyright SHARP Corporation 2010. All rights reserved. Reproduction, adaptation or translation without prior written permission is prohibited, except as allowed under copyright laws.

Contents

OPERATION MANUALS AND HOW TO USE THEM	7
--	----------

CAUTIONS	8
-----------------	----------

Symbols in this manual	8
------------------------	---

Power notes	8
-------------	---

Installation notes	9
--------------------	---

About consumables	10
-------------------	----

Handling precautions	10
----------------------	----

NAMES OF PARTS AND COMPONENTS, TURNING ON THE POWER	12
--	-----------

HOME SCREEN	13
--------------------	-----------

For operating the touch panel and functions the icon.

OVERVIEW OF COPY OPERATION	14
-----------------------------------	-----------

OVERVIEW OF OTHER OPERATIONS	16
-------------------------------------	-----------

For functions other than copy.

MAINTENANCE	17
--------------------	-----------

SPECIFICATIONS	18
-----------------------	-----------

SUPPLIES	23
-----------------	-----------

OTHERS	24
---------------	-----------

TO THE ADMINISTRATOR OF THE MACHINE	25
--	-----------

TRADEMARK ACKNOWLEDGMENTS	26
----------------------------------	-----------

OPERATION MANUALS AND HOW TO USE THEM

Quick Start Guide (this document)

Features important safety notes, names of parts and components, information about the power-on procedure, operation overviews, information for people who manage the machine, and information about other aspects of this machine.

Read this section before using the machine for the first time.



Software Setup Guide (CD-PDF)

Explains how to install the various drivers needed when using this machine as a printer, network scanner, or fax machine. Refer to this document when using this machine from a computer. The Software Setup Guide can be found on the "Software CD-ROM".

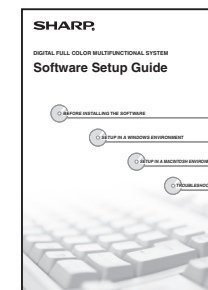

Operation Guide (PC)

Can be downloaded from the machine to a computer and viewed. Refer to this document to learn more about printer mode and settings mode, and to learn about the details of each type of mode.

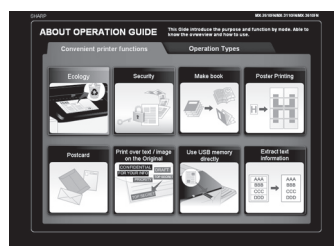

Operation Guide (Built-in)

Can be viewed by touching the operation guide icon on the machine's touch panel. When you are using this machine, use this document to see an overview of a particular mode or when you are having trouble operating the machine.



Downloading the Operation Guide (PC)

You can download the [Operation Guide (PC)] by following the procedures below while the machine is connected to the network.

1 Confirm the machine's IP address

First, press the [Settings] key on the operation panel and then touch [List Print (User)] when it appears on the touch panel.

Next, touch the [Print] key in the [All Custom Setting List], and confirm the IP address in the printed list.

2 Insert the machine's IP address into the address bar of your web browser to access the machine.

<http://machine's IP address/>
User verification may be required depending on the machine's settings. Please check with the machine's administrator to obtain the account information necessary for verification.

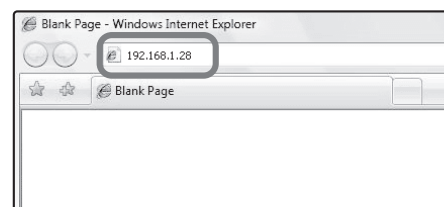

3 Download the [Operation Guide (PC)]

Click [Download Operation Guide] on the displayed page. Next, select the desired language from the "Language to download" list, and then click the [Download] button.

4 Double-click on the downloaded file to display the Operation Guide (PC).

CAUTIONS

Symbols in this manual

To ensure safe use of the machine, this manual uses various safety symbols. The safety symbols are classified as explained below. Be sure you understand the meaning of the symbols when reading the manual.



Indicates a risk of death or serious injury.



Indicates a risk of human injury or property damage.

Meaning of the symbols



CAUTION!
HOT



PINCH POINT
KEEP CLEAR



PROHIBITED
ACTIONS



DO NOT
DISASSEMBLE



MANDATORY
ACTIONS

Power notes



WARNING



Be sure to connect the power cord only to a power outlet that meets the specified voltage and current requirements. Also make certain the outlet is properly grounded. Do not use an extension cord or adapter to connect other devices to the power outlet used by the machine. Using an improper power supply may cause fire or electrical shock.

* For the power supply requirements, see the name plate in the lower left corner of the left side of the machine.



Do not damage or modify the power cord.

Placing heavy objects on the power cord, pulling it, or forcibly bending it will damage the cord, resulting in fire or electrical shock.

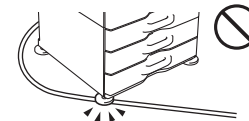

Do not insert or remove the power plug with wet hands.

This may cause electrical shock.



CAUTION



When removing the power plug from the outlet, do not pull on the cord.

Pulling on the cord may cause damage such as wire exposure and breakage, and may result in fire or electrical shock.



If you will not use the machine for a long time, be sure to remove the power plug from the outlet for safety.



When moving the machine, switch off the main power and remove the power plug from the outlet before moving.

The cord may be damaged, creating a risk of fire or electrical shock.

Installation notes

CAUTION



Do not install the machine on an unstable or slanted surface. Install the machine on a surface that can withstand the weight of the machine.

Risk of injury due to the machine falling or toppling.
If peripheral devices are to be installed, do not install on an uneven floor, slanted surface, or otherwise unstable surface. Danger of slippage, falling, and toppling. Install the product on a flat, stable surface that can withstand the weight of the product.



Do not install in a location with moisture or dust.

Risk of fire and electrical shock.
If dust enters the machine, dirty output and machine failure may result.

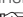

Locations that are excessively hot, cold, humid, or dry (near heaters, humidifiers, air conditioners, etc.)

The paper will become damp and condensation may form inside the machine, causing misfeeds and dirty output.
 **SPECIFICATIONS** (page 18)
If the location has an ultrasonic humidifier, use pure water for humidifiers in the humidifier. If tap water is used, minerals and other impurities will be emitted, causing impurities to collect on the inside of the machine and create dirty output.

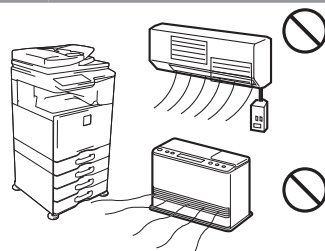

When the machine is installed, the adjusters (5) must be lowered to the floor to secure the machine (prevent it from moving).

Rotate the adjusters in the locking direction until they are in firm contact with the floor.

If you find it necessary to reposition the machine due to rearrangement of your office layout or other reason, retract the adjusters from the floor, turn off the power, and then move the machine.

(After moving the machine, lower the adjusters again to secure the machine.)

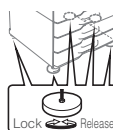

Locations exposed to direct sunlight

Plastic parts may become deformed and dirty output may result.

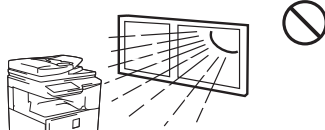

Locations with ammonia gas

Installing the machine next to a diazo copy machine may cause dirty output.



Do not install the machine in a location with poor air circulation.

A small amount of ozone is created inside the machine during printing. The amount of ozone created is not sufficient to be harmful; however, an unpleasant odor may be noticed during large copy runs, and thus the machine should be installed in a room with a ventilation fan or windows that provide sufficient air circulation. (The odor may occasionally cause headaches.)
* Install the machine so that people are not directly exposed to exhaust from the machine. If installed near a window, ensure that the machine is not exposed to direct sunlight.

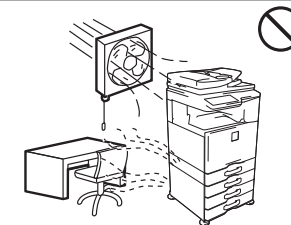

Near a wall

Be sure to allow the required space around the machine for servicing and proper ventilation. (The machine should be no closer than the distances indicated below from walls. The indicated distances are for the case when a saddle finisher and large capacity paper tray are not installed.)

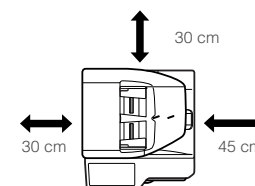

Locations subject to vibration.

Vibration may cause failure.

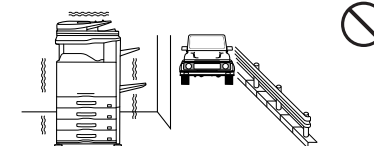

CAUTION

The machine includes a built-in hard drive. Do not subject the machine to shock or vibration. In particular, never move the machine while the power is on.

- The machine should be installed near an accessible power outlet for easy connection.
- Connect the machine to a power outlet which is not used for other electric appliances. If a lighting fixture is connected to the same outlet, the light may flicker.

CAUTIONS

About consumables

CAUTION



Do not throw a toner cartridge into a fire.

Toner may fly and cause burns.



Store a toner cartridge out of the reach of children.

Handling precautions

WARNING



Do not place a container of water or other liquid, or a metal object that might fall inside, on the machine.

If the liquid spills or the object falls into the machine, fire or electrical shock may result.



Do not remove the machine casing.

High-voltage parts inside the machine may cause electrical shock.



Do not make any modifications to this machine.

Doing so may result in personal injury or damage to the machine.



Do not use a flammable spray to clean the machine.

If gas from the spray comes in contact with hot electrical components or the fusing unit inside the machine, fire or electrical shock may result.



If you notice smoke, a strange odor, or other abnormality, do not use the machine.

If used in this condition, fire or electrical shock may result. Immediately switch off the main power and remove the power plug from the power outlet. Contact your dealer or nearest SHARP Service Department.



If a thunder storm begins, switch off the main power and remove the power plug from the outlet to prevent electrical shock and fire due to lightning.



If a piece of metal or water enters the machine, switch off the main power and remove the power plug from the power outlet.

Contact your dealer or nearest SHARP Service Department. Using the machine in this condition may result in electrical shock or fire.

⚠ CAUTION



Do not look directly at the light source.

Doing so may damage your eyes.

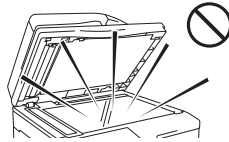

Do not block the ventilation ports on the machine. Do not install the machine in a location that will block the ventilation ports.

Blocking the ventilation ports will cause heat to build up in the machine, creating a risk of fire.



The fusing unit and paper exit area are hot. When removing a misfeed, do not touch the fusing unit and paper exit area. Take care not to burn yourself.

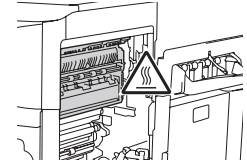

When loading paper, removing a misfeed, performing maintenance, closing the front and side covers, and inserting and removing trays, take care that your fingers are not pinched.

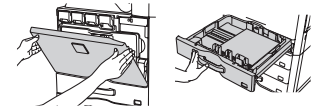

The machine includes the document filing function, which stores document image data on the machine's hard drive. Stored documents can be called up and printed or transmitted as needed. If a hard drive failure occurs, it will no longer be possible to call up the stored document data. To prevent the loss of important documents in the unlikely event of a hard drive failure, keep the originals of important documents or store the original data elsewhere. With the exception of instances provided for by law, Sharp Corporation bears no responsibility for any damages or loss due to the loss of stored document data.

Laser information

Wave length	790 nm \pm 10 nm
Pulse times	Normal paper mode (P/S = 104 mm/s) = (5.15 μ s \pm 0.03 ns) / 7 mm Heavy paper mode (P/S = 70 mm/s) = (3.83 μ s \pm 0.03 ns) / 7 mm
Output power	Max 0.405 mW

■ Caution

Use of controls or adjustments or performance of procedures other than those specified herein may result in hazardous radiation exposure.

This Digital Equipment is CLASS 1 LASER PRODUCT (IEC 60825-1 Edition 2-2007)

■ SAFETY PRECAUTIONS

This Digital Equipment is rated Class 1 and complies with 21 CFR 1040.10 and 1040.11 of the CDRH standards. This means that the equipment does not produce hazardous laser radiation. For your safety, observe the precautions below.

- Do not remove the cabinet, operation panel or any other covers.
- The equipment's exterior covers contain several safety interlock switches. Do

not bypass any safety interlock by inserting wedges or other items into switch slots.

■ "BATTERY DISPOSAL"

THIS PRODUCT CONTAINS A LITHIUM PRIMARY MEMORY BACK-UP BATTERY THAT MUST BE DISPOSED OF PROPERLY. PLEASE CONTACT YOUR LOCAL SHARP DEALER OR AUTHORIZED SERVICE REPRESENTATIVE FOR ASSISTANCE IN DISPOSING OF THIS BATTERY.

This product utilizes a CR coin Lithium battery which contains a Perchlorate material. Special handling for this material may apply, California residents, See www.dtsc.ca.gov/hazardouswaste/perchlorate/ Others, consult local environmental officers.

This product utilizes tin-lead solder, and fluorescent lamp containing a small amount of mercury. Disposal of these materials may be regulated due to environmental consideration. For disposal or recycling information, please contact your local authorities, the Electronics Industries Alliance: www.eiae.org, the lamp recycling organization: www.lamprecycle.org or Sharp at 1-800-BE-SHARP. (For U.S.A. Only)

NAMES OF PARTS AND COMPONENTS, TURNING ON THE POWER

This machine has a main power switch, found at the bottom left after the front cover is opened, and a power button (⏻), located on the operation panel.

Turning on the power

- Switch the main power switch to the “I” position. The main power indicator will light in orange. The power button (⏻) does not function while the main power indicator is lit in orange.
- After the main power indicator lights in green, press the power button (⏻).

Turning off the power

- (1) Press the power button (⏻) to turn off the power.
- (2) Switch the main power switch to the “O” position.

Restarting the machine

In order for some settings to take effect, the machine must be restarted. If a message in the touch panel prompts you to restart the machine, press the power button (⏻) to turn off the power and then press the key again to turn the power back on.

⚠ CAUTION

- When turning off the power, make sure that the indicators on the operation panel turn off as well.
- If the machine suddenly turns off, such as in the event of a power failure, turn the machine on again, and then turn off the machine following the correct procedure for turning off the machine.

Switching off the main power switch or removing the power cord from the outlet while any of the indicators are lit or blinking may damage the hard drive and cause data to be lost.

- Switch off both the power button (⏻) and the main power switch and unplug the power cord if you suspect a machine failure, if there is a bad thunderstorm nearby, or when you are moving the machine.

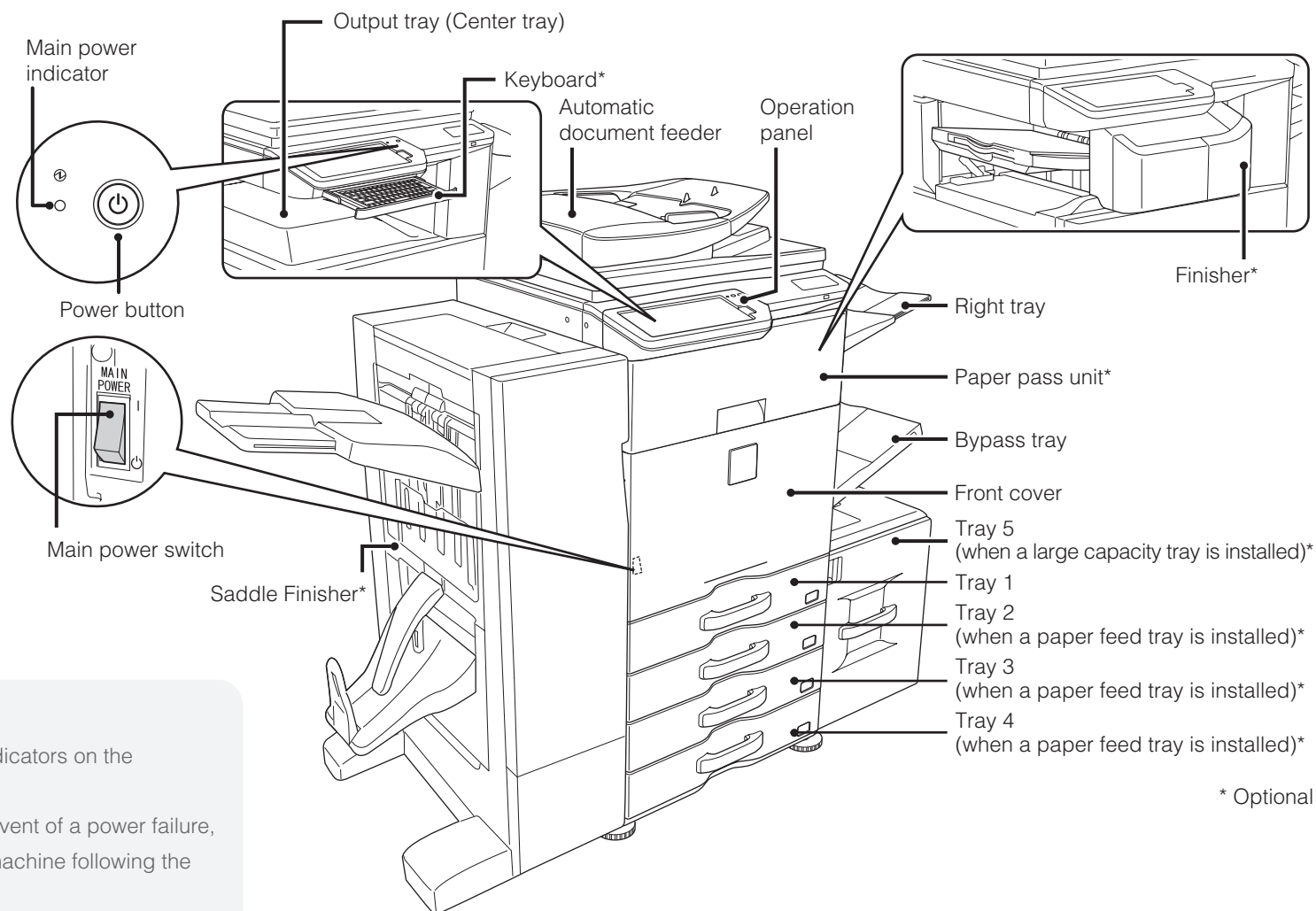

* Optional



- When using the fax or Internet fax function, always keep the main power switch in the “I” position.
- In some states of the machine, pressing the power button (⏻) to restart will not make the settings take effect. In this case, use the main power switch to switch the power off and then on.

HOME SCREEN

The home screen is the first screen to be displayed. Touch an icon to display the corresponding screen. When the  button is pressed on the operation panel, this home screen is displayed.

* The actual screen displayed may vary depending on the model or how the machine has been customized.

Copy
The scanned original is printed.

Scroll area
Up to 12 icons are displayed.
Icons that are not displayed can be displayed by scrolling horizontally.

Fixed area
Up to 10 icons are always displayed.

HDD file retrieve
The scanned original is saved.
Saved data can be edited and used again for another operation.

Operation Guide Refer to the Operation Guide when you have questions about operating the machine.

Image send The scanned original is sent to the specified destination.

E-mail The scanned original is attached to an e-mail and sent.

Fax The scanned original is sent using the telephone line.

FTP/Desktop
The scanned file is sent to a specified directory of an FTP server or to a specified folder on a computer connected to the network.

Network folder
The scanned original is sent to the specified shared folder on a computer connected to the Windows network.

PC scan
A TWAIN-compliant application on a computer connected to the network is used to scan a document or image.







Job status
Displays the status of the current job.

System settings
Allows various settings to be adjusted according to how the machine will be used or its current state of use.



OPERATING THE TOUCH PANEL

In addition to the conventional "single tap" operation, you can also operate the touch panel using long touches, flicks, and slides.

Tap 	Touch and then quickly release the finger. Used to select keys, tabs, checkboxes, etc.	Double-tap 	Lightly strike the touch panel two times. Used to change the preview display mode, or enlarge the preview image.	Slide 	Slide the finger on the scroll bar to move up or down through a long list.
Long-touch 	Touch a key and keep the finger on the key for a short time.	Flick 	Flick (quickly swipe with the finger) to scroll the preview image.	Drag 	Drag (slide the finger in the desired direction) to rotate or delete original pages displayed as a preview.

OVERVIEW OF COPY OPERATION

Step 1 Select a function

Select the Copy icon.



Step 2 Place the original

Select the automatic document feeder or the document glass according to the type of original.

Place the original in the automatic document feeder

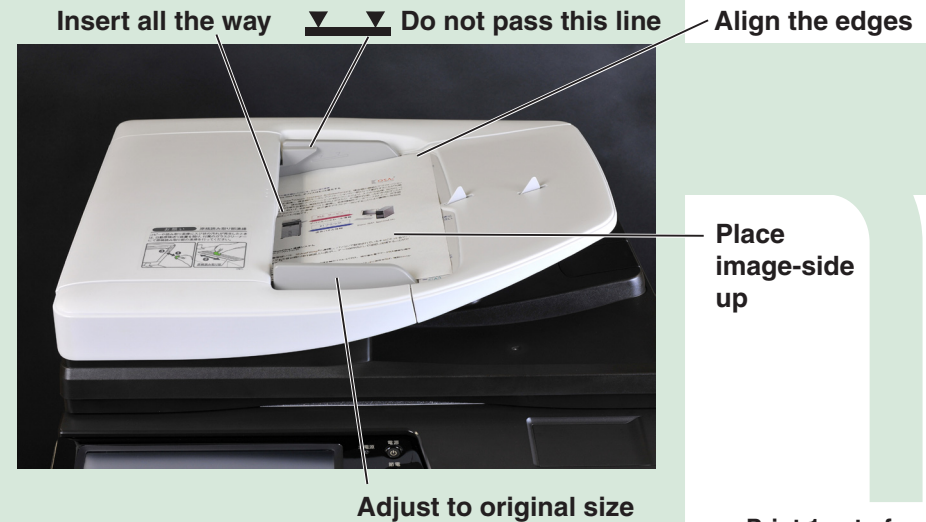
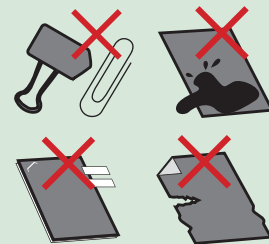

Place the original on the document glass



Placing a thick book

Lift open



Align to corner

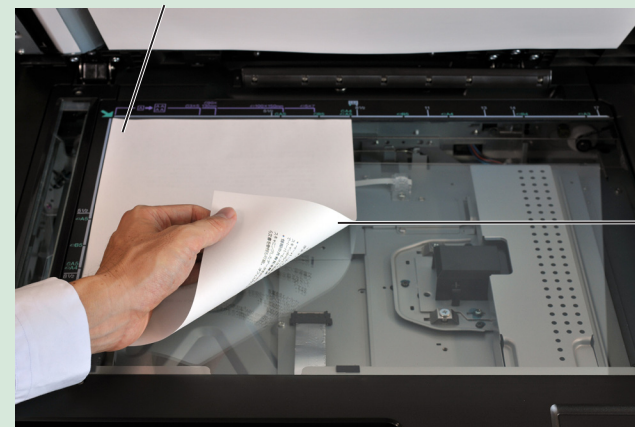

Print 1 set of copies

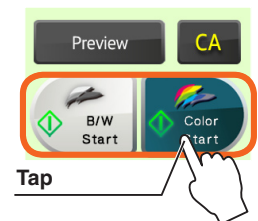

Place image-side down

Step 3 Scan

Step 4 Confirming while viewing the preview

Step 5 Start

Confirm the results of the scan and any edits or settings.

Enter the number of prints and start printing.

Scan the original

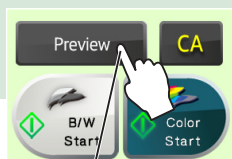

Tap

Scan another original

Additional Scan

Tap



Confirmation Face up/down, orientation, missing pages, folded pages

Output settings



Editing

Page editing, deleting, etc.



Drag



Tap

Print

Document filing

The scanned original and the settings are saved on the hard disk and can be used again.

OVERVIEW OF OTHER OPERATIONS For functions other than copy.

Step 1 Select a function **Step 2** Place the original **Step 3** Scan **Step 4** Confirmation **Step 5** Start

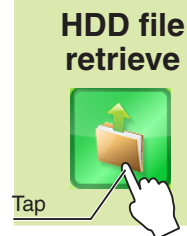
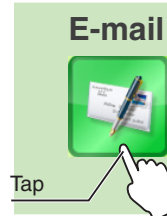
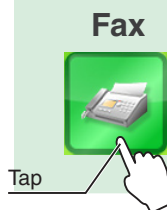

Scan and store the file

Place the original in the automatic document feeder
Insert all the way **Do not pass this line**
Align the edges



Place the original on the document glass
Adjust to original size
Align to corner

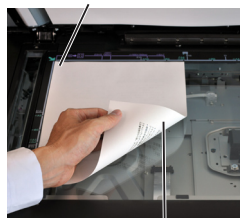

Downward

Placing a thick book



Lift open

Confirmation

Face up/down
Orientation
Missing pages
Folded pages

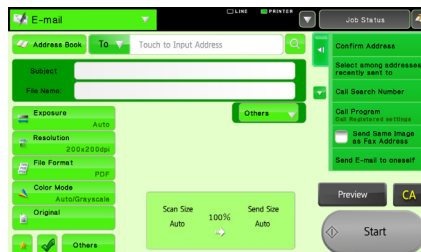
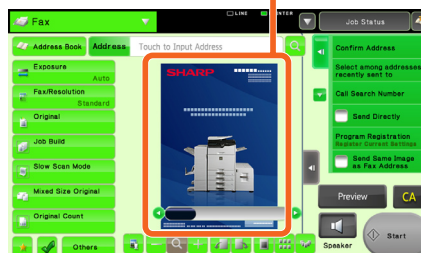

Select the address

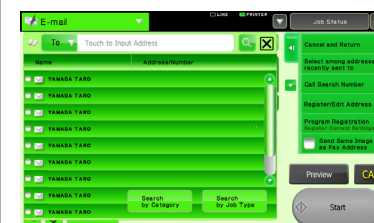

Transmission

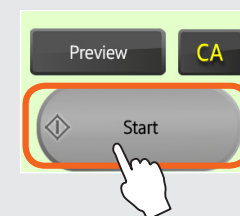

Storing

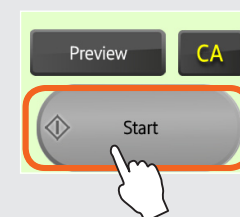

Select the folder

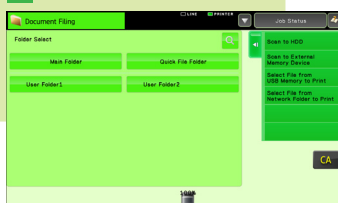

MAINTENANCE

Replacing a toner cartridge

When toner runs low, the color and the message “Prepare a new toner cartridge.” appears.

Prepare a new toner cartridge for the indicated color.

When toner runs out, the color and the message “Replace the toner cartridge.” appears.

Replace the toner cartridge for the indicated color.

Example: Replacing the yellow toner cartridge

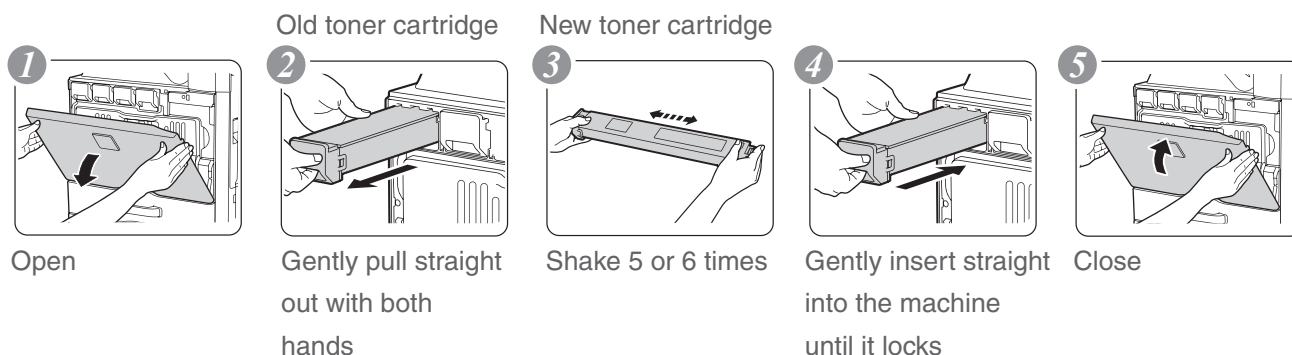

Caution

- Do not throw toner cartridges into a fire. Toner may fly and cause burns.
- Store toner cartridges out of the reach of small children.
- Always store toner cartridges on their sides. If toner cartridges are stored on end, the toner may harden and become unusable.
- Please use SHARP-recommended toner cartridges. If toner cartridges other than SHARP-recommended toner cartridges are used, the machine may not attain full quality and performance and there is a risk of damage to the machine.



- Do not dispose of used toner cartridges. Place them in a plastic bag and keep them. The technician will collect the used toner cartridges when performing maintenance.
- To view the approximate amount of toner remaining, continually touch the [Home Screen] key during printing or when the machine is idle. The percentage of toner remaining will appear in the display while the key is touched.
- When the percentage falls to “25-0%”, obtain a new toner cartridge and keep it ready for replacement.
- Depending on your conditions of use, the color may become faint or the image blurred.

Removing misfeeds

When a paper misfeed occurs, the message “A misfeed has occurred.” will appear in the touch panel and printing and scanning will stop.

In this event, touch the [Check how to remove misfeeds.] key in the touch panel.

When the key is touched, instructions for removing the misfeed will appear. Follow the instructions. When the misfeed is cleared, the message will automatically clear.



Caution

- The fusing unit and the output unit are hot.
- Take care not to touch the fusing unit when removing a misfeed.
- There is a risk of burning.



SPECIFICATIONS

Basic Specifications / Copier specifications

Name	MX-2610N/MX-3110N/MX-3610N				
Type	Desktop				
Color	Full color				
Copier system	Laser electrostatic copier				
Scanning resolution	Scan (B/W): 600 × 600 dpi, 600 × 400 dpi, 600 × 300 dpi Scan (full color): 600 × 600 dpi Print: 600 × 600 dpi, equivalent to 9,600 dpi × 600 dpi				
Gradation	Scan: equivalent to 256 levels / Print: equivalent to 256 levels				
Original paper sizes	Max. 11" x 17" (A3) for sheets and bound documents				
Copy sizes	12" × 18" (A3 wide) to 5-1/2" × 8-1/2"R, A5R, Transparency film, Heavy paper, Envelopes				
	Tray 1-4: 11" × 17", 8-1/2" × 14", 8-1/2" × 13-1/2", 8-1/2" × 13-2/5", 8-1/2" × 13", 8-1/2" × 11", 8-1/2" × 11"R, 7-1/4 × 10-1/2"R, 5-1/2" × 8-1/2"R A3, B4, A4, A4R, B5, B5R, A5R				
	Multi-bypass tray: 12" × 18" (A3 wide) to 5-1/2" × 8-1/2"R, A5R, Transparency film, Heavy paper, Envelopes				
	Lost margin (leading edge): 11/64" (4 mm) ± 3/64" (± 1 mm) Lost margin (trailing edge): 6/64" (2 mm) - 13/64" (- 5 mm) Leading edge / trailing edge: total 21/64" (8 mm) or less Near edge / far edge: total 11/64" (4 mm) ± 6/64" (± 2 mm) or less				
Warm-up time	20 seconds or less ● This may vary depending on the ambient conditions.				
First-copy time		MX-2610N	MX-3110N	MX-3610N	
	Full color:	8.1 seconds	7.9 seconds	6.8 seconds	
	B/W:	5.9 seconds	5.8 seconds	5.2 seconds	
	● This may vary depending on the state of the machine.				
Continuous copying speeds* (when shifter is not in operation)		MX-2610N	MX-3110N	MX-3610N	
	8-1/2" × 11"R, A4R	7-1/4" × 10-1/2"R, B5	26 copies/min.	31 copies/min.	36 copies/min.
	8-1/2" × 11", A4	7-1/4" × 10-1/2", B5	19 copies/min.	20 copies/min.	23 copies/min.
	8-1/2" × 14", B4		16 copies/min.	17 copies/min.	20 copies/min.
	11" × 17", A3		14 copies/min.	15 copies/min.	17 copies/min.
	* Continuous speed for same original source. Output may be temporarily interrupted to stabilize image quality.				

Copy ratios	Same size: 1:1 ± 0.8 % Enlarge: 115 %, 122 %, 141 %, 200 %, 400 % Reduce: 25 %, 50 %, 70 %, 81 %, 86 % Zoom range: 25 to 400 % (25 - 200 % using RSPF) in 1 % increments, total 376 increments. Can calculate zoom rate when mm is specified.	
Paper feed / capacity	500 sheets in one tray plus 100-sheet multi-bypass tray ● Using 21 lbs. (80 g/m²) weight paper	
Max. paper feed / max. capacity	5,600 sheets in 4 trays (500 × 4) plus 100-sheet multi-bypass tray plus 3,500 sheets in large capacity tray ● Using 21 lbs. (80 g/m²) weight paper	
Continuous copy	Max. 999 copies	
Memory	Standard: 2 GB HDD: 160 GB SD card 4 GB PCL accelerator 1 GB ● 1 GB = One billion bytes when referring to hard drive capacity. Actual format capacity is less.	
Ambient environment	Operating environment	54 °F (10 °C) to 91 °F (35 °C) (20 % to 85 % RH) 590 - 1,013 hpa
	Standard environment	68 °F (20 °C) to 77 °F (25 °C) (65 ± 5 % RH)
Required power supply	AC 120V ±10% 60Hz Power consumption Max. 1.44 kW (including options such as the desk)	
Dimensions	MX-2610N/MX-3110N 22-61/64" (W) × 25-29/32" (D) × 32-27/32" (H) (583 mm (W) × 658 mm (D) × 834 mm (H))	
	MX-3610N 24-5/16" (W) × 26-25/32" (D) × 32-27/32" (H) (608 mm (W) × 680 mm (D) × 834 mm (H))	
Weight	MX-2610N/MX-3110N MX-3610N Approx. 165 lbs. (75 kg) Approx. 171 lbs. (78 kg)	
Overall dimensions	With multi-bypass tray extended	MX-2610N/MX-3110N 33-15/32" (W) × 25-29/32" (D) (850 mm (W) × 658 mm (D)) MX-3610N 34-31/64" (W) × 26-25/32" (D) (876 mm (W) × 680 mm (D))
	With right side exit tray extended	MX-2610N/MX-3110N 37-59/64" (W) × 25-29/32" (D) (963 mm (W) × 658 mm (D)) MX-3610N 39-31/32" (W) × 26-25/32" (D) (1,015 mm (W) × 680 mm (D))

Automatic document feeder (Standard equipment)

Name	Reversing Single Pass Feeder (RSPF)		
Document feeder types	Reversing Single Pass Feeder (RSPF)		
Original paper sizes	11" × 17" (A3) to 5-1/2" × 8-1/2" (A5)		
Original paper types	Paper weight	Thin paper 9 lbs. (35 g/m ²) to 13 lbs. (49 g/m ²)	
		Plain paper 13 lbs. (50 g/m ²) to 34 lbs. (129 g/m ²)	
	Two-sided	13 lbs. (50 g/m ²) to 28 lbs. (105 g/m ²)	

Paper storage capacity	100 sheets (21 lbs. (80 g/m ²)) (or maximum stack height of 33/64" (13 mm)) B/W: 50 one-sided sheets/minute (8-1/2" × 11" (A4) horizontal) (600 × 400 dpi)
Scan speed (copy)	Color: 36 one-sided sheets/minute (8-1/2" × 11" (A4) horizontal) (600 × 600 dpi)

Tray

Name	Tray 1 (MX-DE12)	Tray 2 (MX-DE13)	Tray 3 (MX-DE14)	Large capacity tray (MX-LC11)
Paper sizes	11" × 17" (A3) to 5-1/2" × 8-1/2"R (A5R)			8-1/2" × 11" (A4, B5)
Useable paper	16 lbs. (60 g/m ²) to 56 lbs. (209 g/m ²)			16 lbs. (60 g/m ²) to 28 lbs. (105 g/m ²)
Paper capacity	500 sheets	1,000 (500 × 2)	1,500 (500 × 3)	3,500

Dimensions	MX-DE12/13/14 22-61/64" (W) × 22-46/64" (D) × 15-3/64" (H) (583 mm (W) × 577 mm (D) × 382 mm (H))
	MX-LC11 14-53/64" (W) × 20-19/32" (D) × 22-41/64" (H) (376 mm (W) × 523 mm (D) × 575 mm (H))
Weight	MX-DE12: Approx. 46 lbs. (21 kg)
	MX-DE13: Approx. 53 lbs. (24 kg)
	MX-DE14: Approx. 64 lbs. (29 kg)
	MX-LC11: Approx. 66 lbs. (30 kg)

Finisher

Name	Finisher (MX-FN17)		
Paper sizes	Depends on feeder specifications		
Useable paper	Paper weight	15 lbs. (55 g/m ²) to 68 lbs. (256 g/m ²)	
No. of trays	1		
Tray capacity (21 lbs. (80g/m ²))	Non-stapled	12" × 18" (A3 wide) / 11" × 17" (A3) / 8-1/2" × 14" (B4): 250 sheets 8-1/2" × 11" (A4) / 8-1/2" × 11"R (A4R, B5) / 7-1/4" × 10-1/2"R (B5R) / 5-1/2" × 8-1/2"R (A5R): 500 sheets	
	Staple function	11" × 17" (A3) / 8-1/2" × 14" (B4): 30 units or 250 sheets 8-1/2" × 11" (A4) / 8-1/2" × 11"R (A4R, B5) / 30 units or 500 sheets	
		● Offset output is not available for 12" × 18" (A3 wide) / 7-1/4" × 10-1/2"R (B5R) / 5-1/2" × 8-1/2"R (A5R).	

Max. no. of stapled sheets	Max. no. of 50 sheets (8-1/2" × 11" (A4), 8-1/2" × 11"R (A4R, B5)) Max. no. of 30 sheets (11" × 17" (A3), 8-1/2" × 14" (B4))
Staple position	1 bottom, 1 top, 2 middle
Required power supply	Supplied from this machine
Weight	Approx. 33 lbs. (15 kg)
Dimensions	When output paper tray is stored 16-55/64" (W) × 23-22/64" (D) × 7-51/64" (H) (428 mm (W) × 593 mm (D) × 198mm (H))
	When output paper tray is extended 24-6/64" (W) × 23-22/64" (D) × 7-51/64" (H) (612 mm (W) × 593 mm (D) × 198 mm (H))

SPECIFICATIONS

Saddle Finisher

Name	Finisher (MX-FN10)
Paper sizes	Depends on feeder specifications
Useable paper	Paper weight 15 lbs. (55 g/m ²) to 68 lbs. (256 g/m ²)
No. of trays	1
Tray capacity (21 lbs. (80g/m ²))	<div>Non-stapled</div> <div>12" × 18" (A3 wide) / 11" × 17" (A3) / 8-1/2" × 14" (B4) / 5-1/2" × 8-1/2"R (A5R): 500 sheets</div> <div>8-1/2" × 11" (A4) / 8-1/2" × 11"R (A4R, B5) / 7-1/4" × 10-1/2"R (B5R): 1,000 sheets</div> <div>Staple function</div> <div>11" × 17" (A3) / 8-1/2" × 14" (B4): 50 units or 500 sheets</div> <div>8-1/2" × 11" (A4) / 8-1/2" × 11"R (A4R, B5, B5R): 50 units or 1,000 sheets</div> <div>● Offset output is not available for 12" × 18" (A3 wide) / 5-1/2" × 8-1/2"R (A5R).</div>
Required power supply	Supplied from this machine

Weight	Approx. 88 lbs. (40 kg)
Dimensions	When output paper tray is stored 19-9/16" (W) × 24-27/32" (D) × 38-57/64" (H) (497 mm (W) × 631 mm (D) × 988 mm (H)) When output paper tray is extended 25-53/64" (W) × 24-27/32" (D) × 38-57/64" (H) (656 mm (W) × 631 mm (D) × 988 mm (H))
Max. no. of stapled sheets	Max. no. of 50 sheets (8-1/2" × 11" (A4), 8-1/2" × 11"R (A4R, B5, B5R)) Max. no. of 25 sheets (11" × 17" (A3), 8-1/2" × 14" (B4))
Staple position	1 bottom, 1 top, 2 middle
Staple method (for saddle stitch)	Centered fold with stapling in 2 center places
Saddle stitch fold position	Centered fold
Saddle usable sizes	11" × 17" (A3) / 8-1/2" × 14" (B4) / 8-1/2" × 11"R (A4R)
Saddle usable paper weight	16 lbs. (60 g/m ²) to 56 lbs. (209 g/m ²)

Punch module (for finisher)

Name	Punch module MX-PN11B
Paper size for punch module	11" × 17" (A3) to 7-1/4" × 10-1/2"R (A4)
Holes	3 holes

Required power supply	Supplied from finisher
Dimensions	3-55/64" (W) × 18-50/64" (D) × 5-26/64" (H) (98 mm (W) × 477 mm (D) × 137 mm (H))
Weight	Approx. 7 lbs. (3 kg)

Punch module (for saddle finisher)

Name	Punch module MX-PNX5B
Paper size for punch module	11" × 17" (A3) to 7-1/4" × 10-1/2"R (A4)
Holes	3 holes

Required power supply	Supplied from saddle finisher
Dimensions	4-27/32" (W) × 24-5/32" (D) × 9-59/64" (H) (122 mm (W) × 604 mm (D) × 248 mm (H))
Weight	Approx. 7.7 lbs. (3.5 kg)

Fax Specifications

Name	Facsimile expansion kit (MX-FX11)
Useable lines	General phone lines (PSTN), private branch exchange (PBX)
Scanning line density	Normal characters: 8 dot/mm × 3.85 chars/mm Small characters: 8 dot/mm × 7.7 line/mm Fine characters: 8 dot/mm × 15.4 line/mm High-definition: 16 dot/mm × 15.4 line/mm
Connection speed	Super G3: 33.6 kbps, G3: 14.4 kbps
Coding method	MH, MR, MMR, JBIG
Connection mode	Super G3 / G3
Original paper sizes for transmission	11" × 17" (A3) to 5-1/2" × 8-1/2" (A5) (Paper with a max. length of 1,000 mm* can be transmitted (one-sided and B/W only).)
Registered paper size	11" × 17" (A3) to 5-1/2" × 8-1/2" (A5)

Transmission time	Approx. 2 seconds *1 (8-1/2" × 11" (A4) Sharp standard paper, normal characters, Super G3 (JBIG)) Approx. 6 seconds (G3 ECM)	
Memory	1 GB	
Notes	Touch dial memory	Max. of 2,000 entries (Including group dialing for fax, scanner, and Internet fax)
	Entries per group	Max. of 500 entries
	Mass transmissions	Max. of 500 recipients

- *1 Complies with the 33.6 kbps transmission method for Super G3 facsimiles standardized by the International Telecommunications Union (ITU-T). This is the speed for when sending an 8-1/2" × 11" (A4) size piece of paper of around 700 characters at standard image quality (8 × 3.85 chars/mm) in Hi-speed mode (33.6 kbps). This is the transmission speed for image information only and does not include time for transmission control. The actual time needed for a transmission depends on the content of the text, type of receiving fax machine, and telephone line conditions.

Network Printer Specifications

Type	Built-in type
Continuous print speed	Same as continuous copy speed
Resolution	Data processing: 600 × 600 dpi, 1,200 × 1,200 dpi Print: 600 × 600 dpi, equivalent to 9,600 dpi × 600 dpi, 1,200 × 1,200 dpi
Page description language	Standard: PCL6 emulation, PS3 emulation *1
Compatible protocols	TCP/IP, IPv4/IPv6, IPX/SPX, NetBEUI, IPP, EtherTalk *1
Compatible OS	Windows 2000, Windows XP, Windows 2000 Server, Windows Server 2003, Windows Vista, Windows Server 2008, Windows 7 Macintosh (Mac OS 9.0 ~ 9.2.2, OS X 10.2.8, 10.3.9, 10.4 ~ 10.4.11, 10.5 ~ 10.5.8, 10.6 ~ 10.6.2)*1

Internal fonts (options)	80 fonts for PCL, 136 fonts for PS3 emulation
Memory	Machine system memory and hard disk
Interface	10BASE-T/100BASE-TX/1000BASE-T, USB 1.1, USB 2.0 (high speed mode)

- *1: When equipped with a PS extension kit (MX-PK11).

SPECIFICATIONS

Network Scanner Specifications

Type	Color scanner
Scan resolution (main × vertical)	100 × 100 dpi, 150 × 150 dpi, 200 × 200 dpi, 300 × 300 dpi, 400 × 400 dpi, 600 × 600 dpi (push scan) 50 to 9,600 dpi *1 (pull scan)
Scan speed (8-1/2" × 11" (A4))	B/W: 50 sheets/minute (one-sided) Color: 50 sheets/minute (one-sided) ● When in standard mode using Sharp standard paper (8-1/2" × 11" (A4) size with 6% coverage) and the auto color detector is turned off. The speed varies depending on the data volume of the original.
Interface	10BASE-T/100BASE-TX/1000BASE-T, USB 2.0 (during USB memory scanning)
Compatible protocols	TCP/IP (IPv4/IPv6)
Compatible OS *2	Pull scan (TWAIN) Windows 2000, Windows XP, Windows 2000 Server, Windows Server 2003, Windows Vista, Windows Server 2008, Windows 7

Output format	(B/W) TIFF, PDF, PDF/A, encrypted PDF, XPS *3 Compression method: decompression, G3 (MH), G4 (MMR) (Gray scale/color) TIFF, JPEG, PDF, PDF/A, encrypted PDF, high compression PDF, XPS *3 Compression method: JPEG (high, mid, and low compression, Emphasis black letter)
Driver	TWAIN compliant

*1: You must decrease the scan size when increasing the resolution.



*2: There are cases when a connection cannot be established. Please contact your local dealer for more information.

*3: XPS (XML Paper Specification)

SUPPLIES

Standard supplies for this product that can be replaced by the user include paper, toner cartridges, and staple cartridges for the finisher.

Be sure to use only SHARP-specified products for the toner cartridges, finisher staple cartridge, and transparency film.



GENUINE SUPPLIES

For best copying results, be sure to use only Sharp Genuine Supplies which are designed, engineered, and tested to maximize the life and performance of Sharp products. Look for the Genuine Supplies label on the toner package.

Storage of supplies

■ Proper storage

1. Store the supplies in a location that is:
 - clean and dry,
 - at a stable temperature,
 - not exposed to direct sunlight.
2. Store paper in the wrapper and lying flat.
3. Paper stored in packages standing up or out of the wrapper may curl or become damp, resulting in paper misfeeds.

■ Storing toner cartridges

Store a new toner cartridge box horizontally with the top side up. Do not store a toner cartridge standing on end. If stored standing on end, the toner may not distribute well even after shaking the cartridge vigorously, and will remain inside the cartridge without flowing out.

■ Staple cartridge

The finisher and saddle finisher require the following staple cartridge:

MX-SCX1 (for finisher and saddle finisher)

Approx. 5000 per cartridge x 3 cartridges

AR-SC3 (for saddle stitch of saddle finisher)

Approx. 2000 per cartridge x 3 cartridges

Supply of spare parts and consumables

The supply of spare parts for repair of the machine is guaranteed for at least 7 years following the termination of production. Spare parts are those parts of the machine which may break down within the scope of the ordinary use of the product, whereas those parts which normally exceed the life of the product are not to be considered as spare parts. Consumables too, are available for 7 years following the termination of production.

Emission of noise and chemicals

Noise emission values

Noise emission values as measured according to ISO7779 are listed to the right.

Sound power level L_{WAd}

	MX-2610N	MX-3110N	MX-3610N
Printing mode (continuous printing)	7.3 B	7.6 B	7.5 B
Standby mode	-	-	-

Sound pressure level L_pA (actual measurement)

	MX-2610N	MX-3110N	MX-3610N
Printing mode (continuous printing)	56 dB	58 dB	57 dB
Standby mode	-	-	-

Emission density (measured according to RALUZ122: Edition Jun.2006)

Measured chemicals	Condition of copier	Color mode	Diffusion speed	
Ozone	When copier is in operation	Color	3.0 mg/h or less	
		Black and white	1.5 mg/h or less	
Dust		Color	4.0 mg/h or less	
		Black and white		
Styrene		Color	-	
		Black and white		
Benzene		Color		
		Black and white		
TVOC		Color	18 mg/h or less	
		Black and white	10 mg/h or less	
	When on standby	-	2.0 mg/h or less	

TO THE ADMINISTRATOR OF THE MACHINE

Forwarding all transmitted and received data to the administrator (document administration function)

This function is used to forward all data transmitted and received by the machine to a specified destination (Scan to E-mail address, Scan to FTP destination, Scan to Network Folder destination, or Scan to Desktop destination).

This function can be used by the administrator of the machine to archive all transmitted and received data.

To configure the document administration settings, click [Application Settings] and then [Document Administration Function] in the [Settings mode] (Administrator-level access privileges are required.)



- The format, exposure, and resolution settings of transmitted and received data remain in effect when the data is forwarded.
- When forwarding is enabled for data sent in fax mode,
 - The [Direct TX] key does not appear in the touch panel.
 - Quick online transmission and dialing using the speaker cannot be used.

Settings mode password

The administrator password is required to change the machine's settings mode. Settings mode can be changed from either the operation panel or using a computer web browser. After setting up the machine, refer to [Settings mode] in the Operation Guide (PC) to set a new password.



The same passwords are used for logging in from the operation panel and from a web browser. If the administrator changes a password, that password will be effective when logging in from both the operational panel and a web browser.

Password for logging in from a computer

There are three accounts that can log in from a web browser: "Administrator", "System Administrator" and "User". The factory default passwords for each account are shown on the below. Logging in as an "Administrator" or "System Administrator" will allow you to manage all the settings available via web browser.



	Account	Password
User	users	users
Administrator	admin	admin
System Administrator	sysadmin	sysadmin



Please take care not to forget newly set administrator passwords.



(Cut along the dotted line and keep in a safe place.)

TRADEMARK ACKNOWLEDGMENTS

The following trademarks and registered trademarks are used in conjunction with the machine and its peripheral devices and accessories.

- Microsoft®, Windows®, Windows® 2000, Windows® XP, Windows Server® 2003, Windows Vista®, Windows Server® 2008, Windows® 7 and Internet Explorer® are registered trademarks or trademarks of Microsoft Corporation in the U.S.A. and other countries.
- PostScript is a registered trademark of Adobe Systems Incorporated.
- Adobe and Flash are registered trademarks or trademarks of Adobe Systems Incorporated in the United States and other countries.
- Adobe, the Adobe logo, Acrobat, the Adobe PDF logo, and Reader are registered trademarks or trademarks of Adobe Systems Incorporated in the United States and other countries.
- Macintosh, Mac OS, AppleTalk, EtherTalk and LaserWriter are trademarks of Apple Inc., registered in the U.S. and other countries.
- Netscape Navigator is a trademark of Netscape Communications Corporation.
- Mozilla® and Firefox® are registered trademarks or trademarks of the Mozilla Foundation in the U.S.A. and other countries.
- PCL is a registered trademark of the Hewlett-Packard Company.
- IBM, PC/AT, and PowerPC are trademarks of International Business Machines Corporation.
- Sharpdesk is a trademark of Sharp Corporation.
- Sharp OSA is a trademark of Sharp Corporation.
- RealVNC is a trademark of RealVNC Limited.
- All other trademarks and copyrights are the property of their respective owners.

Candid and Taffy are trademarks of Monotype Imaging, Inc. registered in the United States Patent and Trademark Office and may be registered in certain jurisdictions. CG Omega, CG Times, Garamond Antiqua, Garamond Halbfett, Garamond Kursiv, Garamond and Halbfett Kursiv are trademarks of Monotype Imaging, Inc. and may be registered in certain jurisdictions. Albertus, Arial, Coronet, Gill Sans, Joanna and Times New Roman are trademarks of The Monotype Corporation registered in the United States Patent and Trademark Office and may be registered in certain jurisdictions. Avant Garde, ITC Bookman, Lubalin Graph, Mona Lisa, Zapf Chancery and Zapf Dingbats are trademarks of International Typeface Corporation registered in the United States Patent and Trademark Office and may be registered in certain jurisdictions. Clarendon, Eurostile, Helvetica, Optima, Palatino, Stempel Garamond, Times and Univers are trademarks of Heidelberger Druckmaschinen AG, which may be registered in certain jurisdictions, exclusively licensed through Linotype Library GmbH, a wholly owned subsidiary of Heidelberger Druckmaschinen AG. Apple Chancery, Chicago, Geneva, Monaco and New York are trademarks of Apple Inc. and may be registered in certain jurisdictions. HGGothicB, HGMinchoL, HGP GothicB and HGPMinchoL are trademarks of Ricoh Company, Ltd. and may be registered in some jurisdictions.

Wingdings is a registered trademark of Microsoft Corporation in the United States and other countries. Marigold and Oxford are trademarks of Arthur Baker and may be registered in some jurisdictions. Antique Olive is a trademark of Marcel Olive and may be registered in certain jurisdictions. Hoefler Text is a trademark of Johnathan Hoefler and may be registered in some jurisdictions. ITC is a trademark of International Typeface Corporation registered in the United States Patent and Trademark Office and may be registered in certain jurisdictions. Agfa is a trademark of the Agfa-Gevaert Group and may be registered in certain jurisdictions. Intellifont, MicroType and UFST are trademarks of Monotype Imaging, Inc. registered in the United States Patent and Trademark Office and may be registered in certain jurisdictions. Macintosh and TrueType are trademarks of Apple Inc. registered in the United States Patent and Trademark Office and other countries. PostScript is a trademark of Adobe Systems Incorporated and may be registered in some jurisdictions. HP, PCL, FontSmart and LaserJet are trademarks of Hewlett-Packard Company and may be registered in some jurisdictions. The Type 1 processor resident in Monotype Imaging's UFST product is under license from Electronics For Imaging, Inc. All other trademarks are the property of their respective owners.

MX-2610N/MX-3110N/MX-3610N

QUICK START GUIDE

SHARP[®]

SHARP ELECTRONICS CORPORATION

1 Sharp Plaza, Mahwah, New Jersey 07495-1163.

www.sharpsusa.com

SHARP ELECTRONICS OF CANADA LTD.

335 Britannia Road East, Mississauga, Ontario, L4Z 1W9

SHARP CORPORATION



This manual has been printed using a vegetable-based soy oil ink
to help protect the environment.

PRINTED IN CHINA

2010L KS1

TINSE4899FCZZ