

## Digital Full Color Production Printer

### BP-1200S/BP-1200C

#### Optional Units Manual

1	High Capacity Feeder .....	3
2	Air Suction Feeder .....	24
3	Interface Decurler Module .....	35
4	Insertter .....	39
5	Static Eliminator .....	44
6	High Capacity Stacker .....	47
7	Crease / Two-Sided Trimmer .....	55
8	Folder Unit .....	64
9	Finisher .....	67
10	Square Back Fold Trimmer .....	82

# Preface

A manual describing the operations for optional units, such as the Finisher.

## Refer

- Descriptions for the following optional products are provided in different guides.
  - Offset catch tray, Long catch tray: 'Printer Unit Manual'
  - Print server and related products: Manual included in the product

- This manual may not be edited, modified or copied in whole or in part without the written consent of the publisher.
- Some parts of this manual are subject to change without prior notice.
- The screen shots and the illustrations in this manual are used as examples. They may differ from yours depending on the model, the software, or the OS.

## Important

In this manual, safety instructions are preceded by the symbol . Always read and follow the instructions before performing the required procedures.

## Conventions

Regarding the notations and trademarks in this document, see the 'Printer User Interface Manual' (HTML).

Description in this manual such as feed capacity assumes 82 g/m<sup>2</sup> paper.

# 1 High Capacity Feeder

## Device Components / Caution Labels

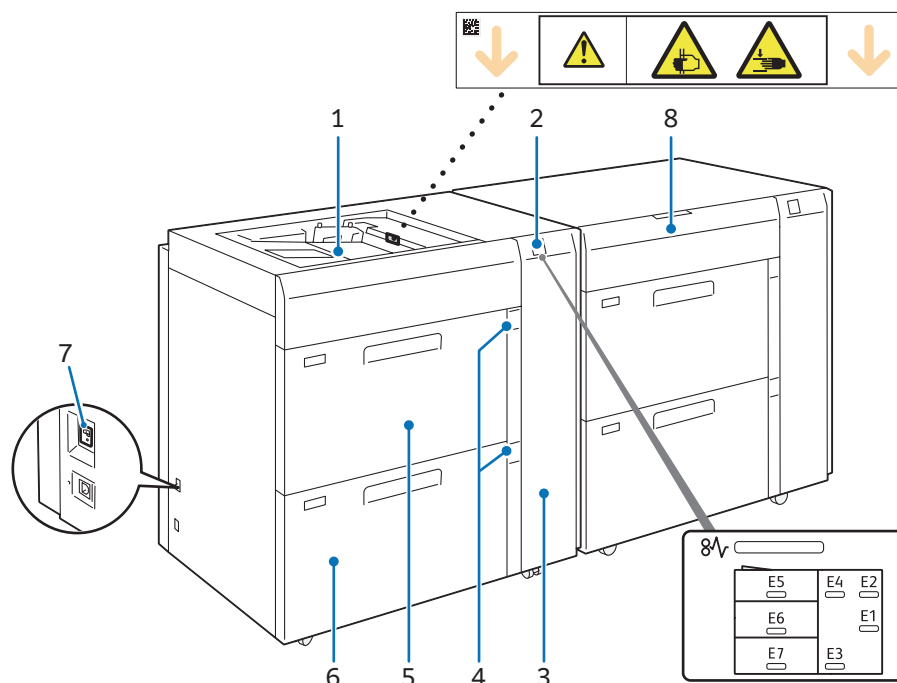

No.	Component	Function
1	Bypass Tray (Paper Tray A1/A2-3)	Load paper here.
2	Error Indicator	When paper jam occurs, the indicator is turned on. When the priority device indicator (top lamp) blinks, first of all perform the paper jam operation.
3	Right Cover	Open this cover to clear paper jams.
4	Remaining Volume Indicator	When the Paper Tray is in operation, the top lamp is turned on. You can check the remaining volume of paper with the 4 lamps (each lamp indicates 25%) at the center. When Paper Replenish Indicator is turned on, paper is empty.
5	High Capacity Trays (Paper Tray A1/A2-1)	Load paper here.
6	High Capacity Trays (Paper Tray A1/A2-2)	Load paper here.
7	Ground Fault Interrupter	A switch to automatically switch the machine off when a current leakage is detected.
8	Top cover	Pull out this cover to clear paper jams.

## Ground Fault Interrupter

When not using for an extended period or when moving the unit, set the switch to the lower position to turn the machine power off.

### Note

Do not operate the switch under normal circumstances because it is turned off when a current leakage is detected.  
For the current leakage, refer to 'Setup Manual'.

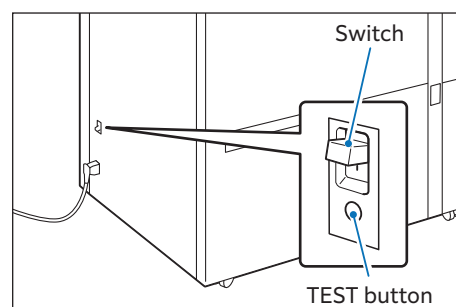

## Main Specifications

### High Capacity Feeder A3

Item		Description
Paper size	High Capacity Feeder <sup>*1</sup>	Standard Size: Max SRA3 (320 x 450 mm), 12.6×19.2" (320 x 488 mm), Min A6 Custom Size: 98 x 148 mm to 330 x 488 mm
	Bypass Tray <sup>*2</sup>	Standard Size: Max A3, 11 x 17", Min A6 Custom Size: 98 x 148 mm to 330 x 488 mm <sup>*3</sup>
Paper weight	High Capacity Feeder	52 to 350 g/m <sup>2</sup>
	Bypass Tray	52 to 300 g/m <sup>2</sup> <sup>*4</sup>
Feeding Capacity <sup>*5</sup> / Number of Tray	High Capacity Feeder	2100 sheets x 2-tray
	Bypass Tray	250 sheets
Power supply		AC 100-120 V +/- 10 %, 6 A, AC 220-240 V +/- 10 %, 4 A, 50/60 Hz common
Maximum power consumption		880 W
Dimensions		W 988 x D 762 x H 992 mm
Weight		211 kg <sup>*6</sup> / 241kg <sup>*7</sup>

\*1: When setting main scanning 98 to 182 mm paper, Post Card Kit is required.

\*2: Multi Bypass Tray or Multi Bypass Tray for Banner Print (Optional) is required.

\*3: Banner sheet printing of up to 330 x 1200 mm is available (Optional).

\*4: Banner sheet printing of 82 to 300 g/m<sup>2</sup> is available (Optional).

\*5: 82 g/m<sup>2</sup> paper

\*6: Weight 211 kg is with an optional Multi Bypass Tray or Multi Bypass Tray for Banner Print.

\*7: Weight 241 kg is with Paper Feeding Unit for the chained configuration

### 2nd High Capacity Feeder A3

Item		Description
Paper size	High Capacity Feeder <sup>*1</sup>	Standard Size: Max SRA3 (320 x 450 mm), 12.6×19.2" (320 x 488 mm), Min A6 Custom Size: 98 x 148 mm to 330 x 488 mm
Paper weight	High Capacity Feeder	52 to 350 g/m <sup>2</sup>
Feeding Capacity <sup>*2</sup> / Number of Tray	High Capacity Feeder	2100 sheets x 2-tray
Power supply		AC 100-120 V +/- 10 %, 5 A, AC 220-240 V +/- 10 %, 3 A, 50/60 Hz common
Maximum power consumption		660 W
Dimensions		W 988 x D 762 x H 992 mm
Weight		235 kg <sup>*3</sup> / 211 kg <sup>*4</sup>

\*1: When setting main scanning 98 to 182 mm paper, Post Card Kit is required.

\*2: 82 g/m<sup>2</sup> paper

\*3: Weight 235 kg is with Paper Feeding Unit on top of the High Capacity Feeder A3 (shipping configuration)

\*4: Weight 211 kg is with an optional Multi Bypass Tray or Multi Bypass Tray for Banner Print.

#### Note

Optional Multi Bypass Tray or Multi Bypass Tray for Banner Print is required.

# Loading Paper

## Loading to High Capacity Tray

Images are printed on the face side of the loaded paper.

### Important

Do not load paper above the maximum fill line. It may cause paper jams or machine malfunction.

### Note

- If the amount of the loaded paper is 100 sheets or less, the guides apply more pressure to the paper. It may cause the paper to be distorted, leading to paper jams.
- Position the guides correctly to match the paper size. Incorrectly positioned guides may cause misfeeding and paper jams.
- In the event power is disconnected while the Paper Tray's bottom plate is rising, the plate may not move up when the power is recovered. In this case, pull out the Paper Tray, make sure the plate is lowered, and then push the Paper Tray into the machine slowly and firmly.
- When paper sheets are loaded or fed, the Paper Tray makes a sound of supplying air. This is caused by the Air Assist function, and not an abnormal noise.

**1. Pull out the Paper Tray toward you until it stops.**

**2. Remove any paper remaining in the Paper Tray.**

**3. Fan the paper well and load about 100 to 500 sheets with the printed side facing up, and the paper edges aligned in the direction of the arrow (①).**

**4. Pinch the long-side paper guide grip and adjust to the correct paper size (②).**

**5. Load remaining sheets with the printed side facing up, and align the paper edges in the direction of the arrow (①).**

**6. Adjust the short-side paper guide to the correct paper size (②).**

To leave a space, pinch the paper guide grip to move.

To narrow, push the paper guide to move.

### Note

Make sure that Paper Feed Precision Lever is set to the Normal position. If printed image is still skewed (misalignment of image on prints) after you load paper in Paper Tray correctly, enable switching of paper feed precision.

### Refer

"Changing Paper Feeding Accuracy" (p.8)

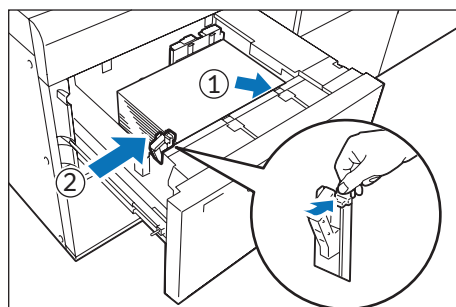
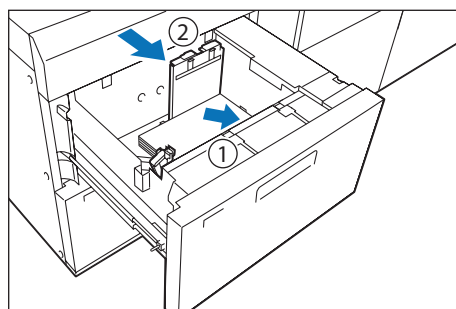
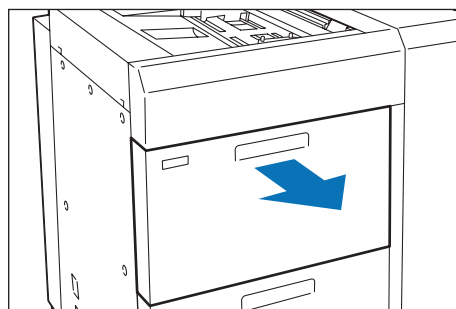

## 7. Push in the Paper Tray.

### Postcard Setting

Attach Post Card Kit to the Paper Tray to load paper with the width of 98 to 181.9 mm.

#### Note

Do not use Post Card Kit (which does not support 98 to 99.9 mm). Using it can cause misregistration or paper jam.

1. Pull out the Paper Tray toward you until it stops.
2. Remove any paper remaining in the Paper Tray.

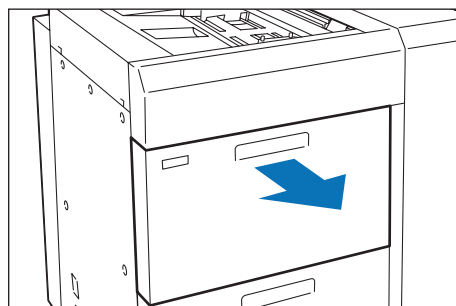

3. If the Kit is supplied with the Paper Tray, loosen the screw (①) on the left side of the Paper Tray to remove the Kit (②).

#### Note

The Postcard Kit is placed in the upper Paper Tray.

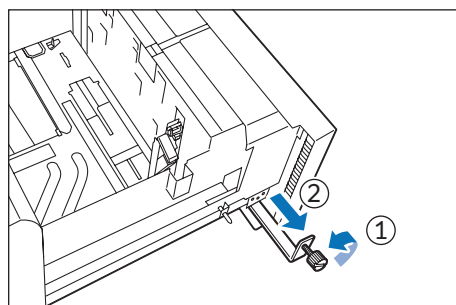

4. Insert the small protrusion of the Kit into the notch to the right side of the bottom of the Paper Tray (①). Align the hole of the Kit with the front Paper Tray hole and tighten the screw to fasten the Kit (②).

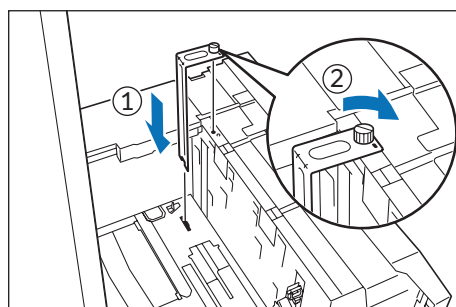

5. Load about 100 to 500 sheets of paper with the printed side facing up, and align the paper edges in the direction of the arrow (①).

#### Note

- Be sure to set them in short edge feed.
- The right side short edge of the set postcard will be the front edge.

6. Pinch the long-side paper guide grip and adjust to the correct paper size (②).

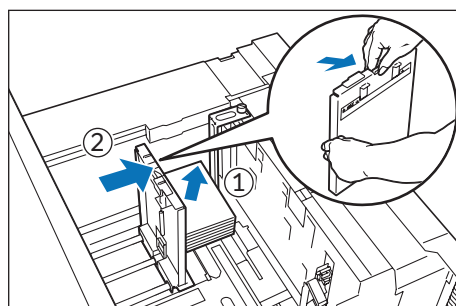

**7. Load remaining sheets with the printed side facing up, and align the paper edges in the direction of the arrow (①).**

**8. Adjust the short-side paper guide to the correct paper size (②).**

To leave a space, pinch the paper guide grip to move.

To narrow, push the paper guide to move.

**9. Push in the Paper Tray.**

**10. To remove the Kit from the Paper Tray, loosen the screw completely and then remove the Kit.**

**11. Store the Kit in place by inserting it from the left side of the Paper Tray (①) and tightening the screw (②).**

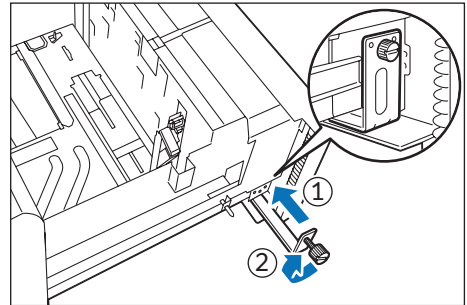
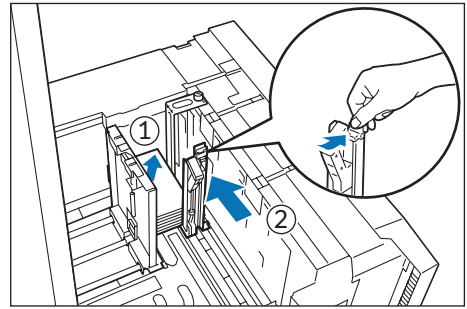

## Special Media Setting

### ■ Hole Punched Paper

Orientation: Place the holes of paper on the right side when you face the front side of machine.

### ■ Precut Tab

Orientation: Place the tabs of paper on the left side when you face the front side of machine.

## Changing Paper Feeding Accuracy

Enabling this function may improve print displacement when images are skewed (print position is displaced) even though plain paper with the paper weight of 220 g/m<sup>2</sup> or less is correctly loaded.

### Note

- If this function is enabled when paper other than thick paper and plain paper is used, the machine cannot feed the paper properly, resulting in paper jams.
- It is not effective when the Postcard Kit is used.

### 1. Pull out the Paper Tray until it stops.

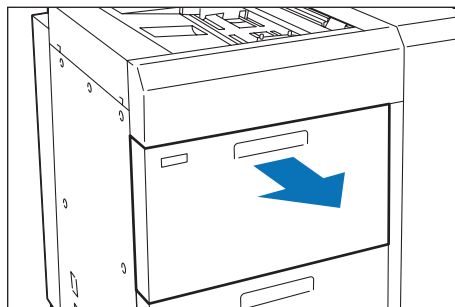

### 2. Move the lever at the top of the long-side paper guide to the rightmost position (<I> position) to enable the changing.

### Note

To reset the setting, move the lever to the leftmost position.

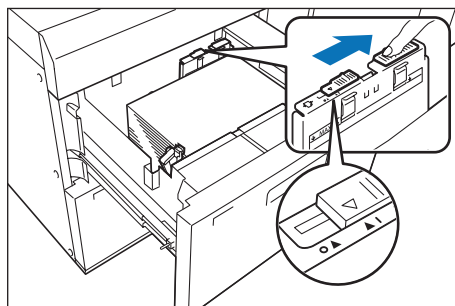

### 3. If the accuracy of paper feeding is not improved even if 2 is performed, move the lever at the right front to the rearmost position (<I> position) to enable the changing.

### Note

To reset the setting, move the lever to the foremost position.

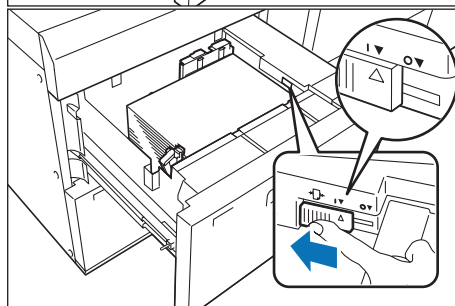

### 4. Push in the Paper Tray.

After using the paper in question, return the lever to the normal position <O>.

## Loading to Bypass Tray

Images are printed on the face side of the loaded paper.

### Important

Do not load paper above the maximum fill line. It may cause paper jams or machine malfunction.

### Note

- If the paper guide width is narrower or wider than the paper, it may cause paper jams.
- In the case of coated paper, only one sheet can be loaded.  
The image quality and paper feeding capability are not guaranteed when more than one sheet is loaded.

## Slide Type

1. Adjust the paper guide to the size of loaded paper.

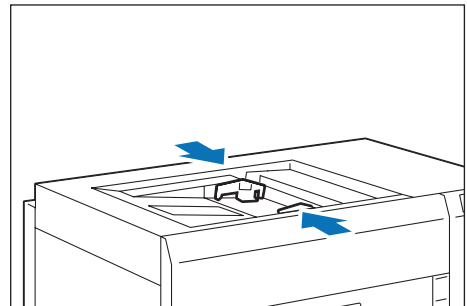

2. Fan the paper well and insert it along the paper guide all the way until it touches the back, with the printed side facing up.
3. When custom size paper is loaded, make fine-adjustment of the paper guide based on the paper size.

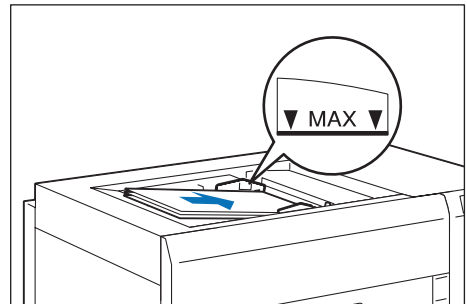

## Flexible Type (for Long Paper)

1. Loosen the 4 screws of the paper guide.

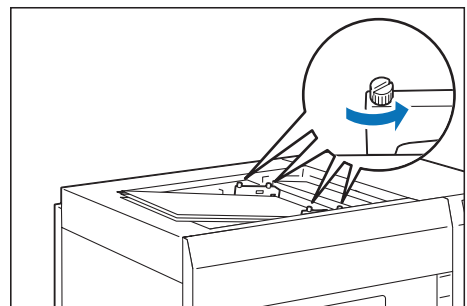

2. Hold the center of the paper guide and adjust it to the size of loaded paper.

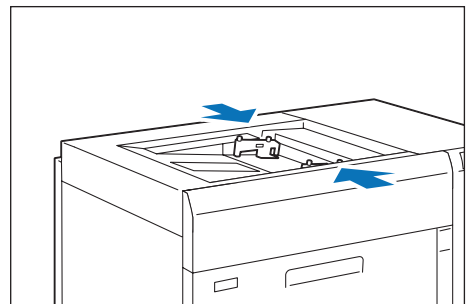

3. Fan the paper well and insert it along the paper guide all the way until it touches the back, with the printed side facing up.
4. Secure the 4 screws of the paper guide.

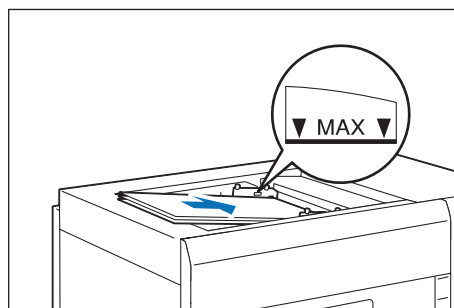

## Special Media Setting

### ■ Hole Punched Paper

Orientation: Place the holes of paper on the right side when you face the front side of machine.

### ■ Precut Tab

Orientation: Place the tabs of paper on the left side when you face the front side of machine.

### ■ Postcards

Orientation: SEF

## Bypass Tray for Long Paper

Load long paper in the Bypass Tray without its rear edge sticking out.

Paper size (mm)	Tray capacity (sheets)
Width: 210 to 330.2 Length: 488.1 to 1,200	Up to 729 mm: 150 More than 729.1 mm : 10
	<div style="border: 1px solid black; padding: 2px; display: inline-block;"><b>Note</b></div> <p>This value applies if 82 g/m<sup>2</sup> paper is used.</p>

### Important

When paper exceeding the tray capacity is loaded, the Extension Kit may get broken.

### ■ Extension Kit

- (1) Insert the extension tray all the way in.

#### Note

Insert it until it stops.

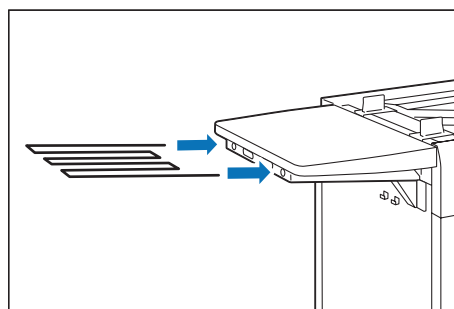

### ■ When not in use

Hang them on the holder at the side.

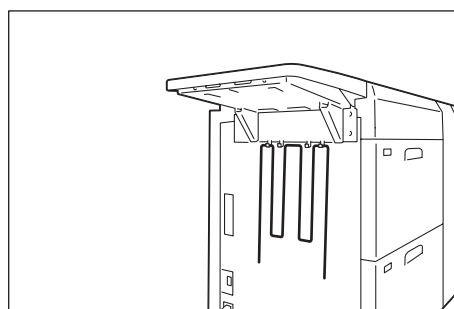

## ■ Loading Paper

1. Loosen the 4 screws of the front paper guide.

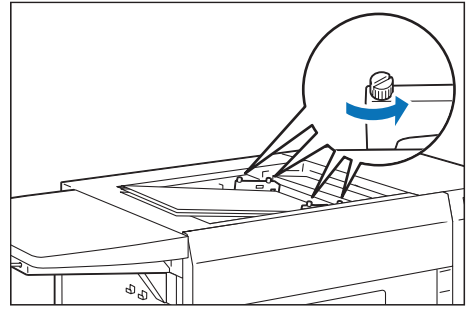

2. Hold the center of the front paper guide and adjust it to the size of loaded paper.

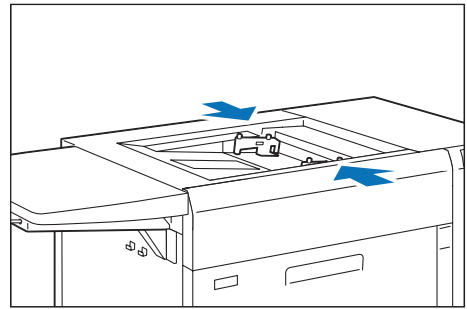

3. Fan the paper well and insert it along the front paper guide all the way until it touches the back, with the printed side facing up.

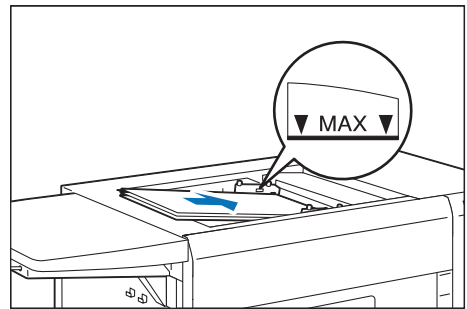

4. Fasten the 4 screws of the front paper guide, and then finetune the rear paper guide to match the paper size.

### Note

The rear paper guide is removable. Also, it can be used irrespective of the top and bottom orientation. Install it in the direction such that the metal surface touches paper.

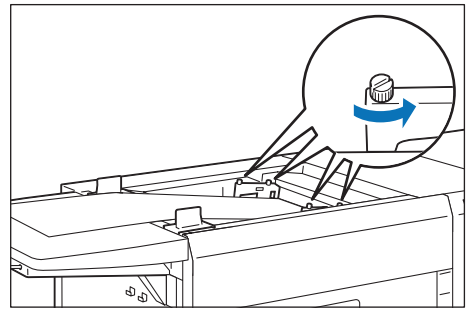

## ■ Alignment

When using long paper with the length of 729 mm or less, auto alignment adjustment can be performed by means of Inline Sensor.

### Note

If auto alignment ends abnormally (image skew angle is 5 mm or more), you need to mitigate the image skew by using Individual Settings before proceeding with auto alignment.

When using long paper with the length of 729 mm or more, auto alignment adjustment cannot be performed, and therefore adjust alignment by using Individual Settings.

When using long paper with the length of 729 mm or more, if the image skew angle is large (8 mm or more), first mitigate the image skew by adjusting paper guide position, and then proceed with alignment adjustment with Individual Settings.

### ■ Image skew angle is large (8 mm or more)

### Note

- Load a single sheet of paper only before proceeding with the adjustment.
- Load paper so that the front edge touches the guide.
- If the paper you use is curled, skew adjustment may not be correctly applied. If paper is curled, first perform curl correction using Media Library before you can perform skew adjustment.

**1. Fasten the 4 screws of the front paper guide, and then fine tune the rear paper guide to match the paper size.**

**2. Print a sample file whose paper size is near to the one you want to use.**

Sample files are stored in the "D:\PrtSrvPublic\UtilityFiles\TKOR\skew" folder for Print Server.

**3. Check the skew of the sample image you printed.**



Use the graduation at the point of "606 mm" in the rear edge of paper or at the center of paper to measure the amount of skew against the paper sheet.

No adjustment is needed if the graduation is at right angle against the paper sheet.

4. Loosen the 4 screws of the front paper guide.

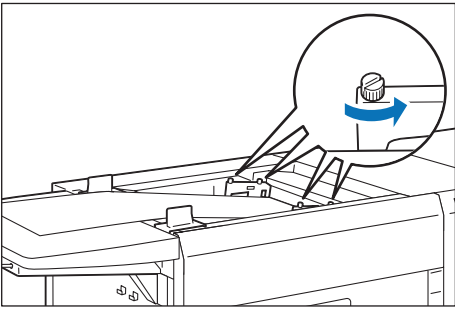

5. Use the right/left front edge of paper as the pivot point (right front edge if the skew is oriented leftward, or left front edge if the skew is oriented rightward) to move the rear edge of paper to the position corresponding to the skew amount.

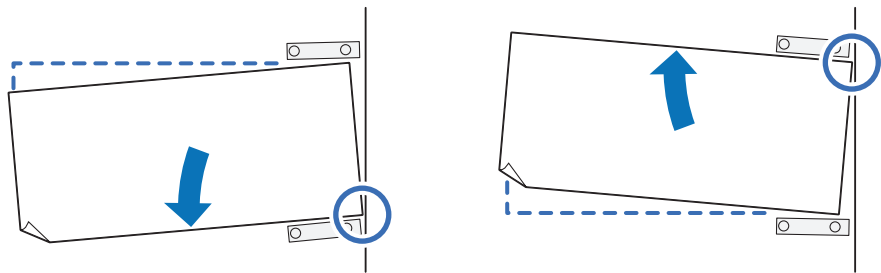

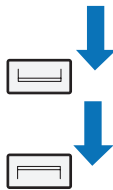

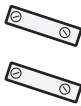
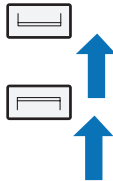

Image	Front paper guide	Rear paper guide
Skew is oriented leftward 		
	Right side is upper Left side is lower	Move downward
Skew is oriented rightward 		
	Right side is lower Left side is upper	Move upward

6. Fasten the 4 screws of the front paper guide, and then fine tune the rear paper guide to match the paper size.

7. Print a sample file whose paper size is near to the one you want to use.

8. If the quality of the printed output is satisfactory, load the required number of paper sheets in the Paper Ttray. If adjustment is required, repeat Steps 3 to 7.

**Note**

In preparation for the next time you use the same paper, it is recommended you note the skew amount.

# Paper Jams

## Note

The error indicator at the top of the machine is turned on. When the priority device indicator (top lamp) blinks, first of all perform the paper jam operation.

If paper is jammed, the machine stops and an alarm sounds. Follow the instructions displayed on the screen to remove the jammed paper.

Gently remove the paper being careful not to tear it. If paper is torn while it is being removed from the machine, remove all the torn pieces making sure that none remain inside the machine.

When you have finished clearing the paper jam, printing is resumed from the state before the paper jam occurred.

## Note

Clear the paper jams while the machine is on.

## Paper Tray

### 1. Remove the jammed paper.

When Indicator E5 is Turned on.....	p.14
When Indicator E6 is Turned on.....	p.14
When Indicator E7 is Turned on.....	p.15

#### ■ When Indicator E5 is Turned on

- (1) Open the Upper Cover and remove all the jammed papers and papers loaded on the tray.
- (2) Close the cover.
- (3) Align the 4 corners of the removed papers and load them again.

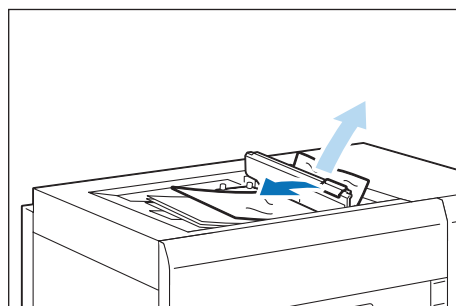

#### ■ When Indicator E6 is Turned on

- (1) Pull out the Paper Tray A1/A2-1 toward you until it stops.

## Note

Confirm that no paper is jammed inside the Right Cover before pulling it out.

- (2) Remove the jammed paper.
- (3) Confirm the paper guide position and push in the Paper Tray.

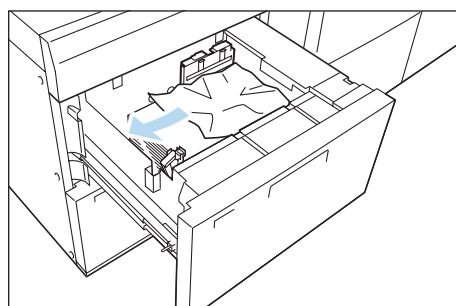

## ■ When Indicator E7 is Turned on

- (1) Pull out the Paper Tray A1/A2-2 toward you until it stops.

### Note

Confirm that no paper is jammed inside the Right Cover before pulling it out.

- (2) Remove the jammed paper.
- (3) Confirm the paper guide position and push in the Paper Tray.

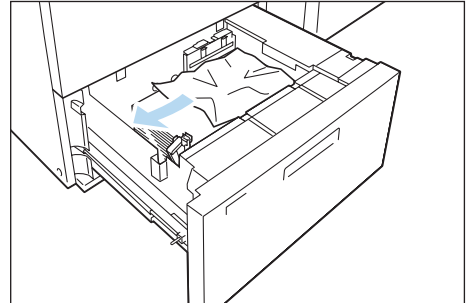

## Inside of the Right Cover (at Single or Right Side at Continuous Feed Configuration)

1. Open the Right Cover.
2. Remove the jammed paper.

When Indicator E1 is Turned on.....	p.15
When Indicator E2 is Turned on.....	p.15
When Indicator E3 is Turned on.....	p.16
When Indicator E4 is Turned on.....	p.16

## ■ When Indicator E1 is Turned on

- (1) Open lever [1d] upward (①), turn knob [1c] clockwise (②), and remove the jammed paper (③).
- (2) Return lever [1d].

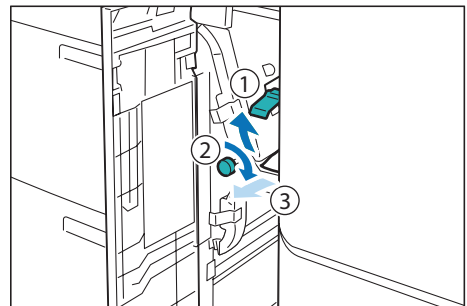

## ■ When Indicator E2 is Turned on

- (1) Open lever [1a] to the right (①), turn knob [1c] clockwise (②), and remove the jammed paper (③).

### Note

Turn knob [1c] 3 times or more.

- (2) Return lever [1a].

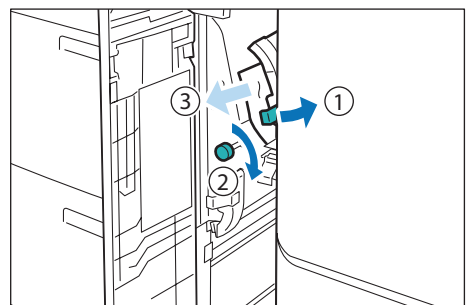

.....

■ **When Indicator E3 is Turned on**

- (1) Open lever [1b] to the right (①), turn knob [1c] clockwise (②), and remove the jammed paper (③).
- (2) Return lever [1b].

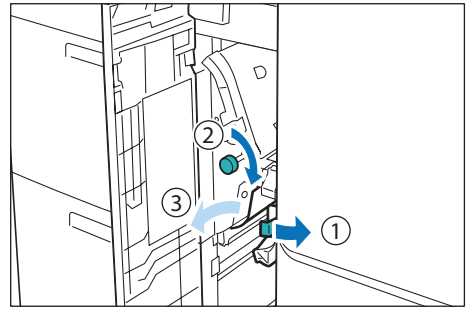

.....

■ **When Indicator E4 is Turned on**

- (1) Open lever [1a] to the right (①), turn knob [1c] clockwise (②), and remove the jammed paper (③).

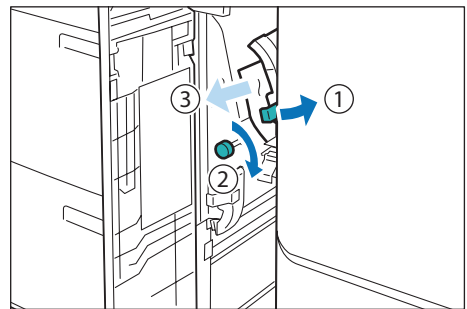

- (2) If you have difficulty in removing the papers, open the Upper Cover and remove the jammed paper.
- (3) Return lever [1a].

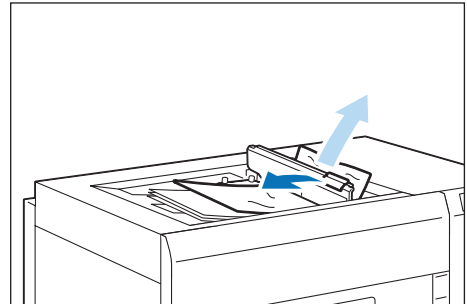

- .....
3. Close the cover.

## Inside of the Right Cover (Left Side at Continuous Feed Configuration)

### 1. Open the Right Cover.

### 2. Remove the jammed paper.

When Indicator E1 is Turned on.....	p.17
When Indicator E2 is Turned on.....	p.17
When Indicator E3 is Turned on.....	p.18
When Indicator E4 is Turned on.....	p.18

#### ■ When Indicator E1 is Turned on

(1) Open lever [1a] to the right (①), turn knob [1c] counter-clockwise (②), and remove the jammed paper (③).

(2) Return lever [1a].

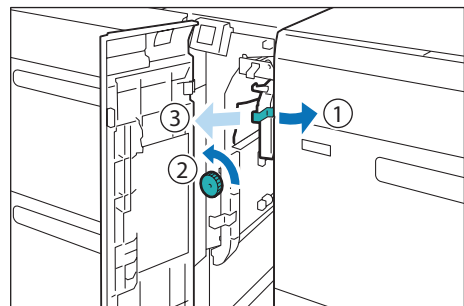

#### ■ When Indicator E2 is Turned on

(1) Open lever [1d] downward (①), turn knob [1c] counter-clockwise (②), and remove the jammed paper (③).

(2) Return lever [1d].

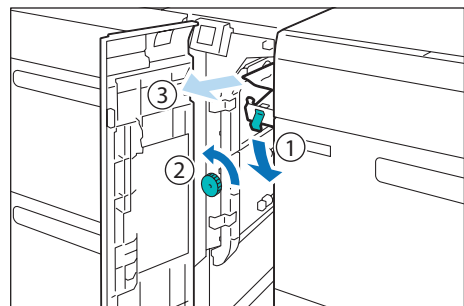

(3) Open lever [1a] to the right (①), lever [1b] to the right (②), and remove the jammed paper (③).

(4) Return lever [1a] and [1b].

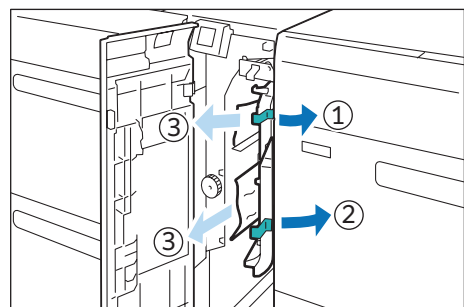

.....

■ **When Indicator E3 is Turned on**

- (1) Open lever [1b] to the right (①), turn knob [1c] counter-clockwise (②), and remove the jammed paper (③).
- (2) Return lever [1b].

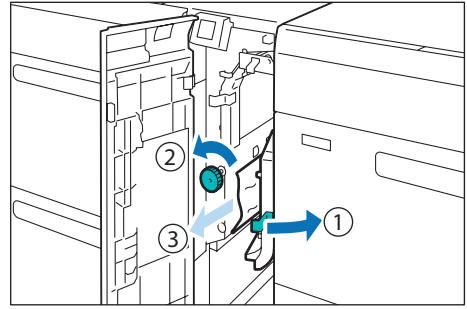

.....

■ **When Indicator E4 is Turned on**

- (1) Open lever [1d] downward (①), turn knob [1c] counter-clockwise (②), and remove the jammed paper (③).
- (2) If you have difficulty in removing the papers, open the Upper Cover and remove the jammed paper.
- (3) Return lever [1d].

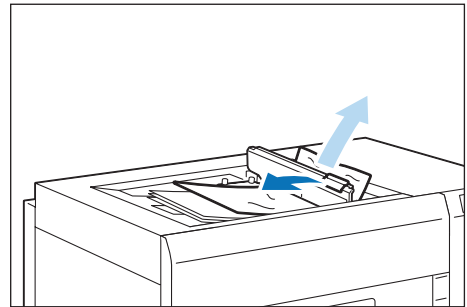
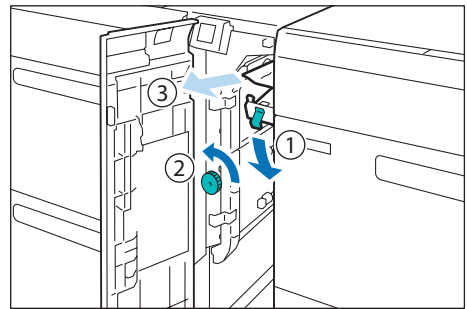

.....

3. Close the cover.

## Paper Feeding Unit (Right Side at Continuous Feed Configuration)

### ■ When Indicator E5 is Turned on

- (1) Pull out the top cover toward you until it stops.

**Note**

Confirm that no paper is jammed inside the Right Cover before pulling it out.

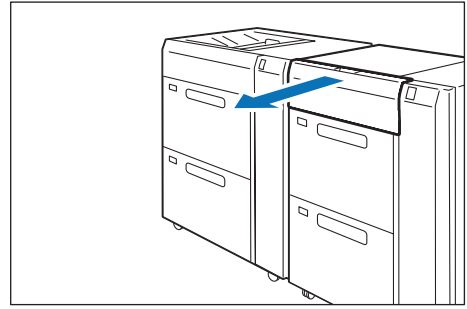

- (2) Open lever [2a] to the right (①), lever [2b] upward (②), and remove the jammed paper (③).

- (3) Return lever [2a] and [2b].

- (4) Push the cover.

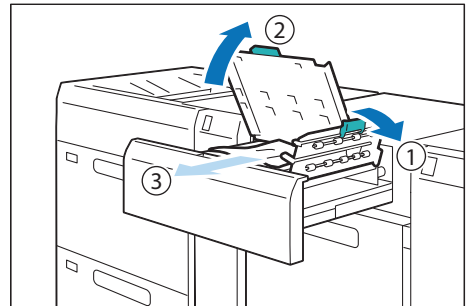

## Cleaning Machine

- When you clean machine products, use the cleaning materials designated in every step.
- To wipe with a wet cloth, use the soft cloth tightly wrung out of water. If the parts are not completely dry, the machine may malfunction.
- Using commercially available non-woven dry type fabric is effective for cleaning paper dust. Choose Non-woven fabric with soft and highly adsorptive that can easily wipe dirt and dust off. Do not use nonwoven fabric containing organic solvents or a polishing agent.
- Do not use benzene, paint thinner, or other organic solvents. Doing so might damage paint or coating on plastic parts.

### Note

After cleaning, be sure to close the cover. Leaving the cover open will not be able to continue to jobs.

## Running Paper

Cleaning may temporarily cause a number of white dots to appear on the output. After cleaning, feed paper through the machine to ensure effectiveness of the cleaning.

1. Create image data consisting C100% and M100% for SRA3 or A3 size.
2. Run a 2-sided job to print this image on about 20 sheets of paper.

## Cleaning inside the Machine

No.	Work	Frequency	Page
1	Cleaning High Capacity Trays	Every week (When collected paper dust is found in the paper guide or roller in the feeder cover)	p.20
2	Cleaning the Paper Feeding Unit in the High Capacity Tray	Every week	p.22

### Note

When you have finished cleaning, make sure the roller and the surface of paper path are free from foreign objects.

## Cleaning High Capacity Trays

1. Pull out the Paper Tray toward you until it stops.
2. Clean the roller in the feeder cover located on the right side of the Paper Tray.
  - (1) Press down the roller 1 holder to the direction of the arrow, and remove roller 1 by picking up the both ends of its pin with fingers.

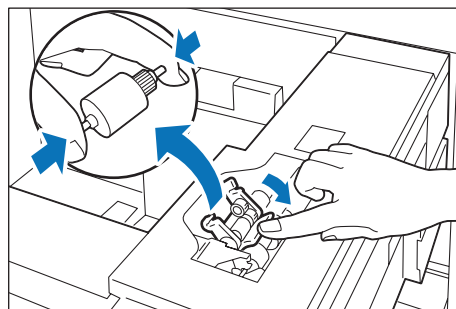

- (2) Wipe the surface of roller 1 with the soft cloth tightly wrung out of water.

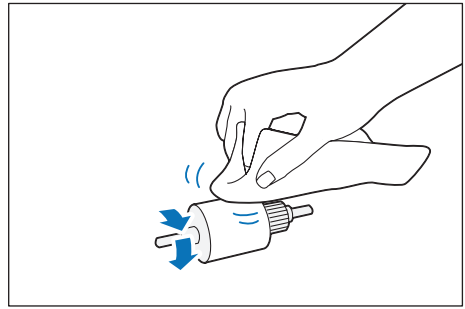

- (3) Reinstall roller 1.

**Note**

Make sure that roller 1 is installed in the holder completely.

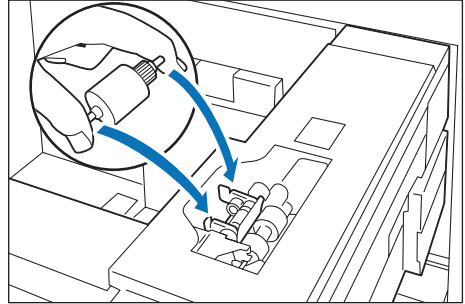

- (4) Remove roller 2 by picking up the both ends of its pin.

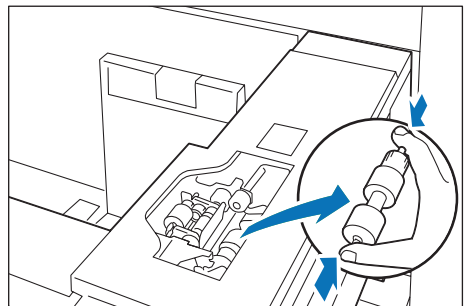

- (5) Wipe the surface of roller 2.

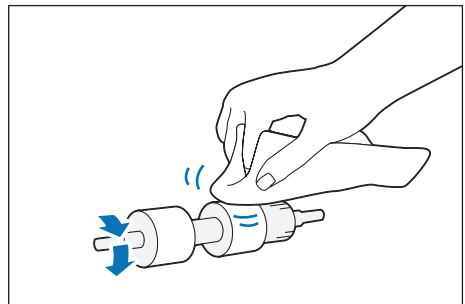

- (6) Rotate the shaft of roller 3 with one hand, and wipe the surface of roller 3 with the other hand.

**Note**

Clean roller 3 without reinstalling roller 2.

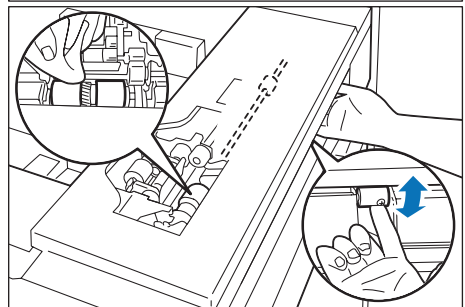

- (7) Reinstall roller 2.

3. Push in the Paper Tray.

4. Clean also the other Paper Tray with the steps 1 to 3.

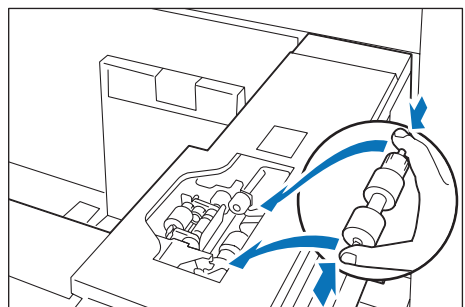

## Cleaning the Paper Feeding Unit in the High Capacity Tray

### Note

- Do not press a roller during the cleaning, otherwise the roller may drop off.
- Non-woven dry type fabric can be used effectively for cleaning paper dust.

1. Open the Right Cover.
2. Open lever [1a] to the right.

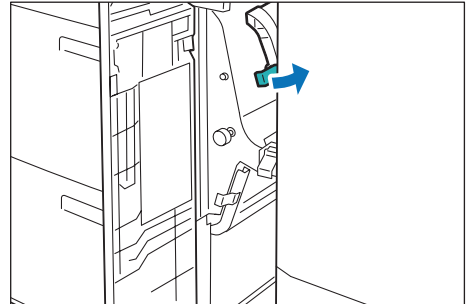

3. Clean behind lever [1a].
  - (1) Wipe the roller surface with the soft cloth tightly wrung out of water.
  - (2) Lightly wipe paper dust off on the surface of the paper path.
4. Return lever [1a].

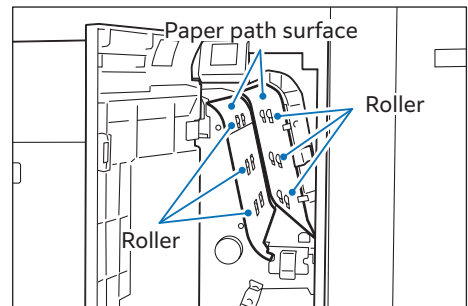

5. Open lever [1b] to the right.

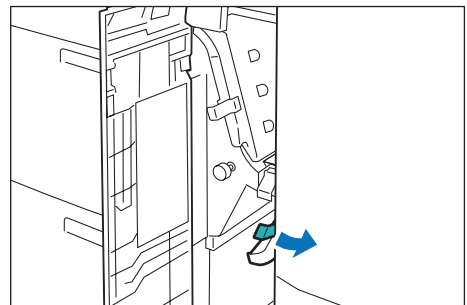

6. Clean behind lever [1b].
  - (1) Wipe the roller surface with the soft cloth tightly wrung out of water.
  - (2) Lightly wipe paper dust off on the surface of the paper path.
7. Return lever [1b].

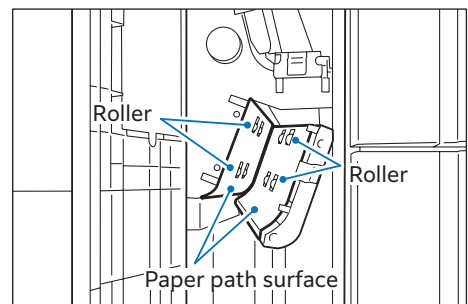

**8. Open lever [1d] upward.**

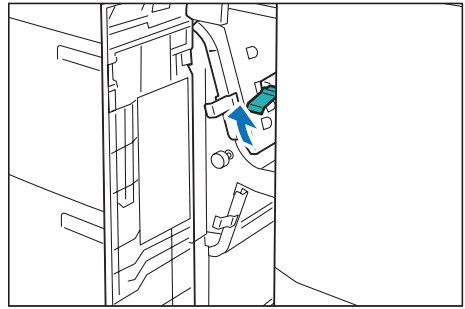

**9. Clean behind lever [1d].**

- (1) Wipe the roller surface with the soft cloth tightly wrung out of water.**
- (2) Lightly wipe paper dust off on the surface of the paper path.**

**10. Return lever [1d].**

**11. Close the cover.**

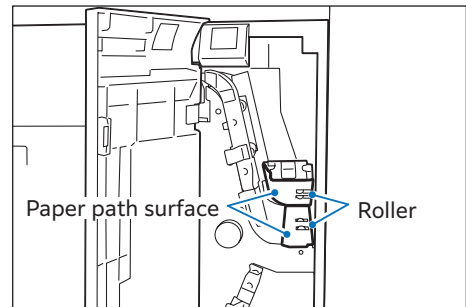

## 2 Air Suction Feeder

### Device Components

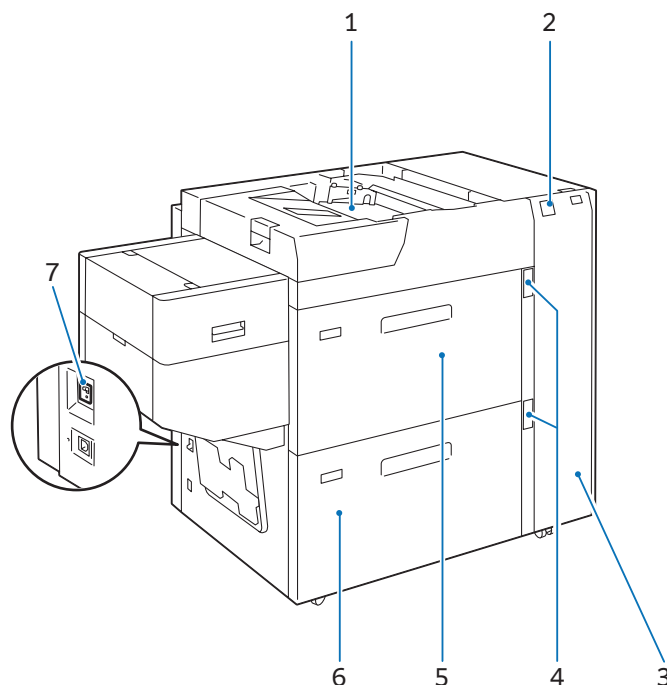

No.	Component		Function
1	Bypass Tray (Paper Tray A1/A2-3)		Load paper here.
2	Error Indicator		When paper jam occurs, the indicator is turned on. When the priority device indicator (top lamp) blinks, first of all perform the paper jam operation.
3	Right Cover		Open this cover to clear paper jams.
4	Remaining Volume Indicator		When the Paper Tray is in operation, the top lamp is turned on. You can check the remaining volume of paper with the 4 lamps (each lamp indicates 25%) at the center. When Paper Replenish Indicator is turned on, paper is empty.
5	Air Tray Long Paper Tray	Paper Tray A1/A2-1	Load paper here.
6	Air Tray	Paper Tray A1/A2-2	
7	Ground Fault Interrupter		A switch to automatically switch the machine off when a current leakage is detected.

#### Note

The Caution Labels, Ground Fault Interrupter, Bypass Tray, Paper Jams and Cleaning the Paper Feeding Unit in the High Capacity Tray are the same as the "1 High Capacity Feeder" (p.3).

## Main Specifications

### Air Suction Feeder A3 / Air Suction Feeder A3 for Banner

Item	Description	
	Air Suction Feeder A3	Air Suction Feeder A3 + Banner Unit for Air Suction Feeder
Paper size <sup>*1</sup>	Standard size: Max SRA3 (320 x 450 mm), 12.6×19.2" (320 x 488 mm), Min A6	
	Custom size: 98 x 148 mm to 330 x 488 mm	Custom size: 210 x 210 mm to 330 x 1200 mm <sup>*2</sup> (Upper tray), 98 x 148 mm to 330 x 488 mm (Lower tray)
Paper weight	52 to 400 g/m <sup>2</sup> <sup>*3</sup>	
Feeding Capacity / Number of Tray <sup>*4</sup>	2200 sheets x 2-tray + 250 sheets	900 sheets <sup>*5</sup> + 2200 sheets + 250 sheets
Power supply	AC 100-120 V +/- 10 %, 6 A, AC 220-240 V +/- 10 %, 4 A, 50/60 Hz common	
Maximum power consumption	880 W	
Dimensions	W 988 x D 762 x H 992 mm	W 1580 x D 762 x H 992 mm
Weight <sup>*6</sup>	194 kg	213 kg

\*1: When setting main scanning 98 to 182 mm paper, Post Card Kit for Air Suction Feeder is required.

\*2: Duplex Automatic Print supports paper size up to 330 x 729 mm.

\*3: For long paper from 330 x 488 mm to 330 x 660 mm: 52 to 350 g/m<sup>2</sup>; for paper up to 330 x 729 mm: 52 to 300 g/m<sup>2</sup>; for paper up to 330 x 1200 mm: 52 to 256 g/m<sup>2</sup>. Duplex Automatic Print supports paper weight up to 300 g/m<sup>2</sup>.

\*4: 82 g/m<sup>2</sup> paper

\*5: 100 sheets for paper longer than 729 mm (82 g/m<sup>2</sup>).

\*6: Including Multi Bypass Tray for Banner Print.

#### Note

- Multi Bypass Tray for Banner Print is included.
- Air Suction Feeder A3 for Banner and Banner Unit for Air Suction Feeder are required as a set.
- Air Suction Feeder A3 for Banner can feed long paper only from the Upper tray.

## Chained Air Suction Feeder A3 R / Chained Air Suction Feeder A3 L / Chained Air Suction Feeder A3 L for Banner / Banner Unit for Air Suction Feeder

Item	Description	
	Chained Air Suction Feeder A3 R + Chained Air Suction Feeder A3 L	Chained Air Suction Feeder A3 R + Chained Air Suction Feeder A3 L for Banner + Banner Unit for Air Suction Feeder
Paper size <sup>*1</sup>	Standard size: Max SRA3 (320 x 450 mm), 12.6×19.2" (320 x 488 mm), Min A6	
	Custom size: 98 x 148 mm to 330 x 488 mm	Custom size: 98 x 148 mm to 330 x 488 mm, 210 x 210 mm to 330 x 1200 mm <sup>*2</sup> (Upper tray of the left module)
Paper weight	52 to 400 g/m <sup>2*3</sup>	
Feeding Capacity / Number of Tray <sup>*4</sup>	2200 sheets x 2-tray x 2-connection + 250 sheets	2200 sheets x 2-tray + 900 sheets <sup>*5</sup> + 2200 sheets + 250 sheets
Power supply	AC 100-120 V +/- 10 %, 6 A, AC 220-240 V +/- 10 %, 4 A, 50/60 Hz common x 2 power	
Maximum power consumption	880 W x 2 power	
Dimensions	W 1980 x D 762 x H 992 mm	W 2572 x D 762 x H 992 mm
Weight <sup>*6</sup>	403 kg	420 kg

\*1: When setting main scanning 98 to 182 mm paper, Post Card Kit for Air Suction Feeder is required.

\*2: Duplex Automatic Print supports paper size up to 330 x 729 mm.

\*3: For long paper from 330 x 488 mm to 330 x 660 mm: 52 to 350 g/m<sup>2</sup>; for paper up to 330 x 729 mm: 52 to 300 g/m<sup>2</sup>; for paper up to 330 x 1200 mm: 52 to 256 g/m<sup>2</sup>. Duplex Automatic Print supports paper weight up to 300 g/m<sup>2</sup>.

\*4: 82 g/m<sup>2</sup> paper

\*5: 100 sheets for paper longer than 729 mm (82 g/m<sup>2</sup>).

\*6: Including Multi Bypass Tray for Banner Print.

### Note

- Multi Bypass Tray for Banner Print is included.
- Chained Air Suction Feeder A3 R and A3 L are required as a set.
- Chained Air Suction Feeder A3 R, Chained Air Suction Feeder A3 L for Banner and Banner Unit for Air Suction Feeder are required as a set.
- Chained Air Suction Feeder A3 L for Banner can feed long paper only from the Upper tray.

# Loading Paper

## Important

Do not load paper above the maximum fill line. It may cause paper jams or machine malfunction.

## Note

- Position the guides correctly to match the paper size. Incorrectly positioned guides may cause misfeeding and paper jams.
- In the event power is disconnected while the Paper Tray's bottom plate is rising, the plate may not move up when the power is recovered. In this case, pull out the Paper Tray, make sure the plate is lowered, and then push the Paper Tray into the machine slowly and firmly.
- When paper sheets are loaded or fed, the Paper Tray makes a sound of supplying air. This is caused by the Air Assist function, and not an abnormal noise.

## Loading to Air Tray

Images are printed on the face side of the loaded paper.

## Note

If the amount of the loaded paper is 100 sheets or less, the guides apply more pressure to the paper. It may cause the paper to be distorted, leading to paper jams.

**1. Pull out the Paper Tray toward you until it stops.**

**2. Remove any paper remaining in the Paper Tray.**

**3. Fan the paper well and load about 100 to 500 sheets with the printed side facing up, and the paper edges aligned in the direction of the arrow (①).**

**4. Pinch the long-side paper guide grip and adjust to the correct paper size (②).**

**5. Load remaining sheets with the printed side facing up, and align the paper edges in the direction of the arrow (①).**

**6. Adjust the short-side paper guide to the correct paper size (②).**

To leave a space, pinch the paper guide grip to move.  
To narrow, push the paper guide to move.

**7. Push in the Paper Tray.**

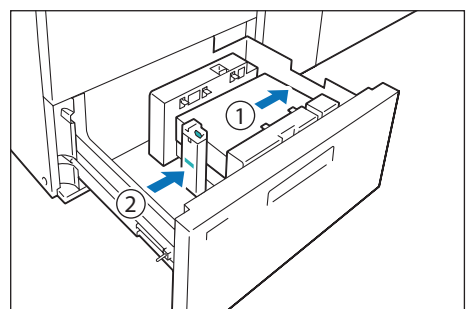
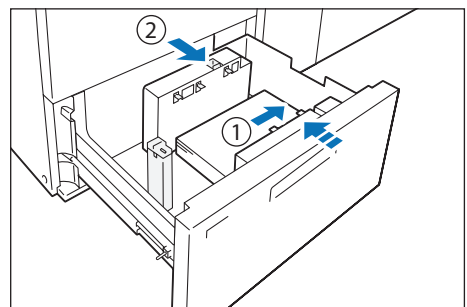
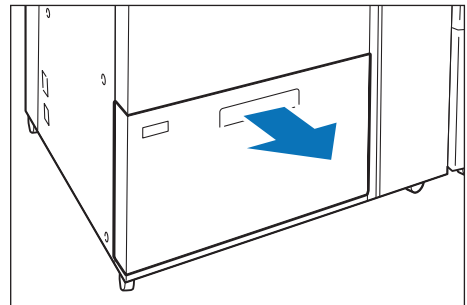

## Postcard Setting

Attach Postcard Kit for Air Suction Feeder to the Paper Tray to load paper with the width of 98 to 181.9 mm.

1. Pull out the Paper Tray toward you until it stops.
2. Remove any paper remaining in the Paper Tray.

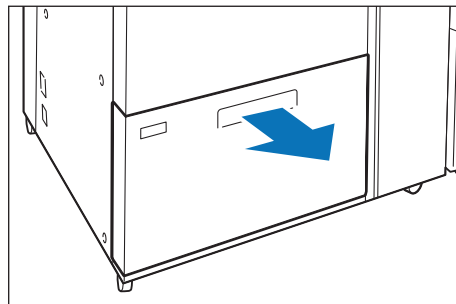

### 3. Remove the shutters.

- (1) Fold the shutters.
- (2) Hold the shutters up and remove them.

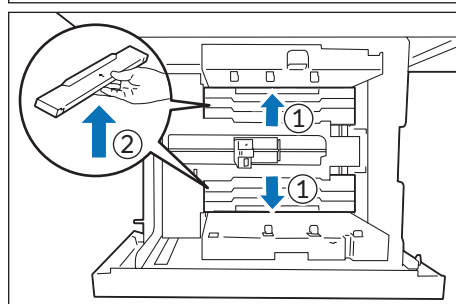

4. Insert the guide A into the slit on the interior side (①) and the slit on the bottom (②), and then tighten the screw of the guide to fix (③).

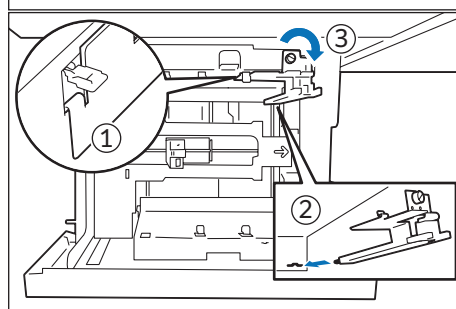

5. Insert the guide B into the slit on your side (①) and the slit on the bottom (②), and then tighten the screw of the guide to fix (③).

### Important

If the screw is not tighten well, it may hit on the transport device to result in break.

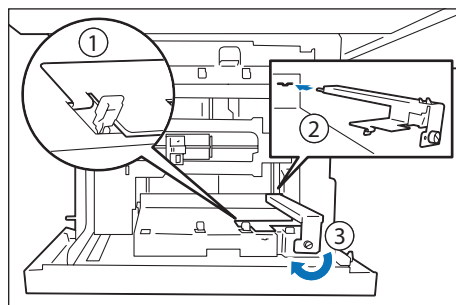

6. Load about 100 to 500 sheets of paper with the printed side facing up, and align the paper edges in the direction of the arrow (①).

### Note

- Be sure to set them in short edge feed.
- The right side short edge of the set postcard will be the front edge.

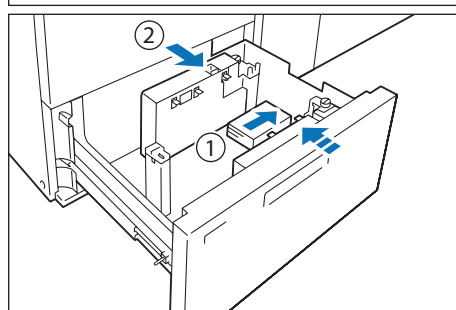

7. Pinch the long-side paper guide grip and adjust to the correct paper size (②).

8. Load remaining sheets with the printed side facing up, and align the paper edges in the direction of the arrow (①).

9. Adjust the short-side paper guide to the correct paper size (②).

To leave a space, pinch the paper guide grip to move.

To narrow, push the paper guide to move.

10. Push in the Paper Tray.

11. To remove the Kit from the Paper Tray, loosen the screw completely and then remove the Kit.

12. To mount the shutters, place the shutters on the original positions and expand them.

Hang the edges of the shutters on the protrudes. Confirm that they are firmly fixed.

#### Note

Align the △ marks so that the shutters can be mounted in the correct orientation. The △ mark on the guide at the top edge of paper is not viewed, and the △ mark on the guide at the bottom edge of paper is viewed in the correct state.

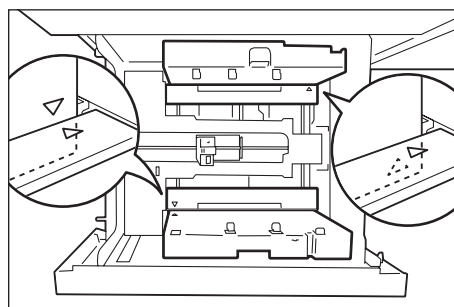
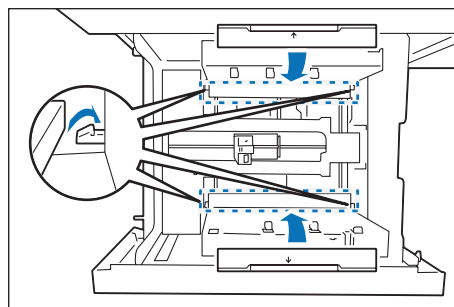
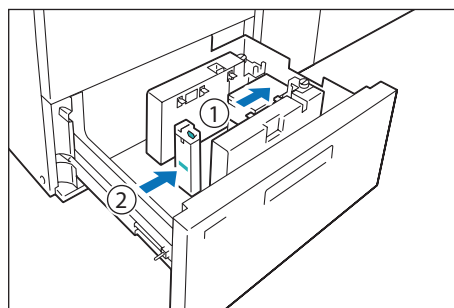

## Special Media Setting

### ■ Hole Punched Paper

Orientation: Place the holes of paper on the right side when you face the front side of machine.

### ■ Precut Tab

Orientation: Place the tabs of paper on the left side when you face the front side of machine.

After loading paper, mount the tab guide (for A5 or A4) on the short-side paper guide.

#### Note

Make sure that the rear edges (tab parts) of the precut tab fit the notch of the tab guide.

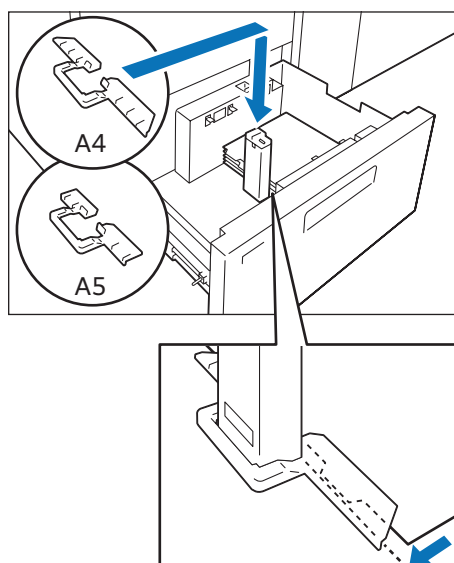

## Loading to Long Paper Tray

Images are printed on the face side of the loaded paper.

### Note

- If the amount of the loaded paper is 100 sheets or less (10 to 20 sheets for 864 mm or more paper), the guides apply more pressure to the paper. It may cause the paper to be distorted, leading to paper jams.
- Postcard Kit for Air Suction Feeder cannot be used with the long paper tray.

### 488 mm or Less Paper

1. Remove the paper loaded on the Bypass Tray.
2. Open two covers.

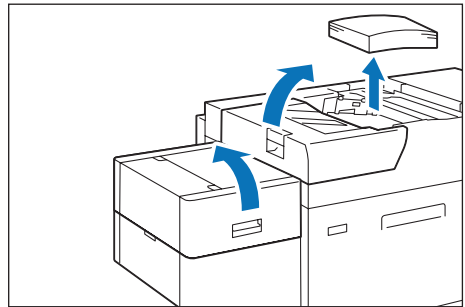

3. Turn the lever on the left of the long-side paper guide downward.
4. Remove any paper remaining in the Tray.

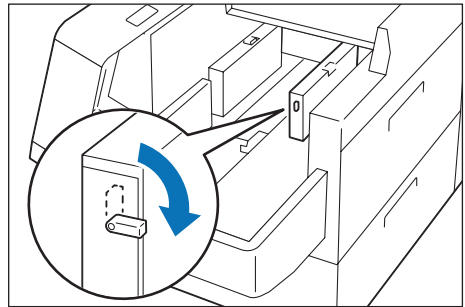

5. If the short-side paper guide is stored, pull the short-side guide up.

- (1) Open the shutter while pinching the lever.
- (2) Hold the paper guide and pull it up. Pull the paper guide until it clicks to be fixed.
- (3) Close the shutter while pinching the lever.

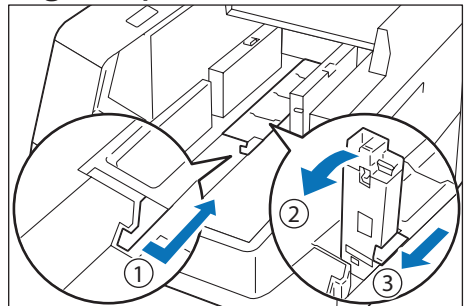

### Important

Do not hold the paper guide grip to pull up. The paper guide grip may break.

6. Fan the paper well and load about 100 to 500 sheets with the printed side facing up, and the paper edges aligned in the direction of the arrow (①).
7. Pinch the right side long-side paper guide grip and adjust to the correct paper size (②).

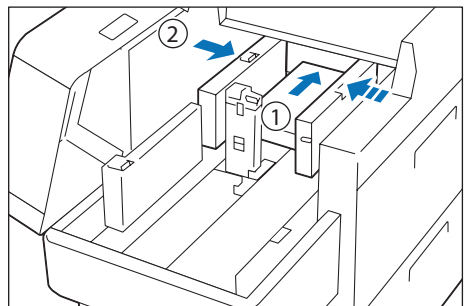

8. Load remaining sheets with the printed side facing up, and align the paper edges in the direction of the arrow (①).

9. Adjust the short-side paper guide to the correct paper size (②).

To leave a space, pinch the paper guide grip to move.

To narrow, push the paper guide to move.

10. Close two covers.

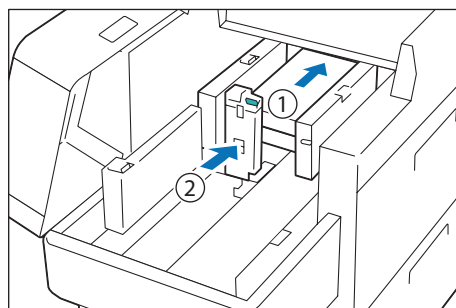

## 488.1 to 864 mm Paper

1. Remove the paper loaded on the Bypass Tray.

2. Open two covers.

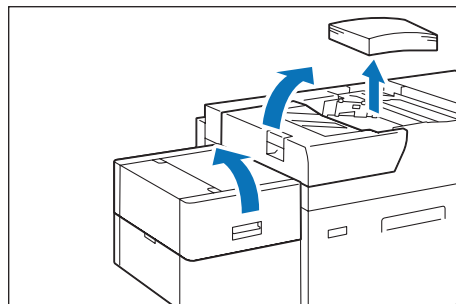

3. Turn the lever on the left of the long-side paper guide upward.

4. Remove any paper remaining in the Tray.

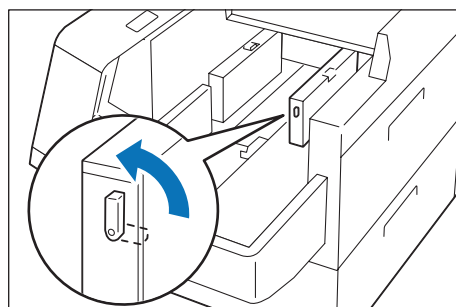

5. If the short-side paper guide is standing, store it.

- (1) Open the shutter while pinching the lever.

- (2) Lay the paper guide down while holding the release lever.

- (3) Close the shutter while pinching the lever.

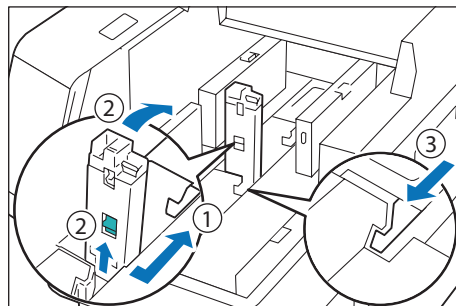

6. Fan the paper well and load about 100 sheets with the printed side facing up, and the paper edges aligned in the direction of the arrow (①).

7. Pinch the right side long-side paper guide grip and adjust to the correct paper size (②).

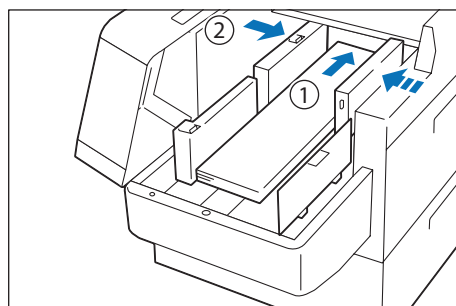

**8. Pinch the left side long-side paper guide grip and adjust to the correct paper size (①).**

**9. Place the bottom edge paper guide to fit the loaded paper (②).**

**Note**

The bottom edge guide is removable. Install it in the direction such that the metal surface touches paper.

**10. Load remaining sheets with the printed side facing up, and align the paper edges in the direction of the arrow.**

**11. Place the rear edge paper guide to fit the loaded paper.**

**Note**

The rear edge guide is removable. Install it in the direction such that the metal surface touches paper.

**12. Close two covers.**

### 864.1 mm or More Paper

Up to 100 sheets can be loaded.

**1. Unfasten the screws and remove the left side cover.**

**2. Remove the paper loaded on the Bypass Tray.**

**3. Open two covers.**

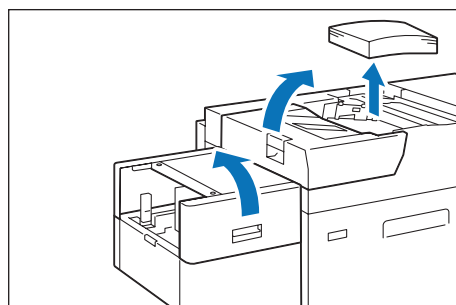
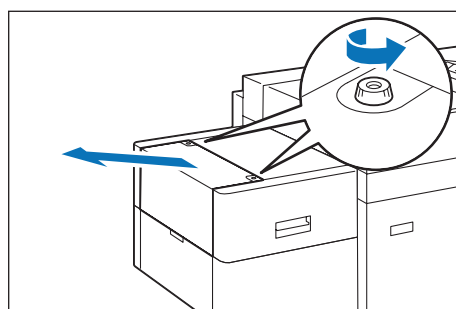
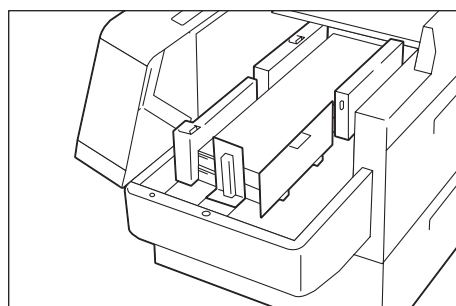
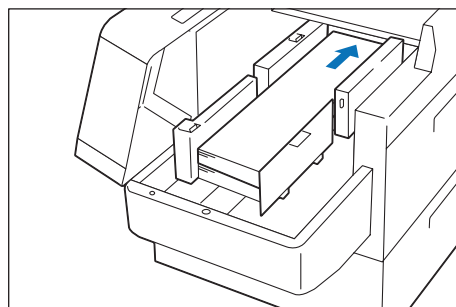
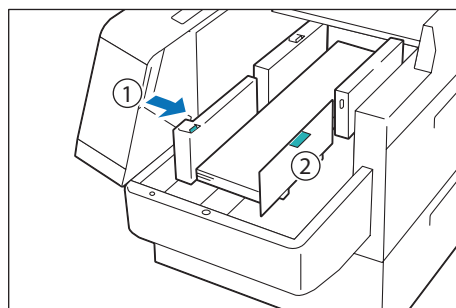

**4. Attach the extension tray and the supporting plate.**

**(1) Insert the extension tray and tighten the screws to fix.**

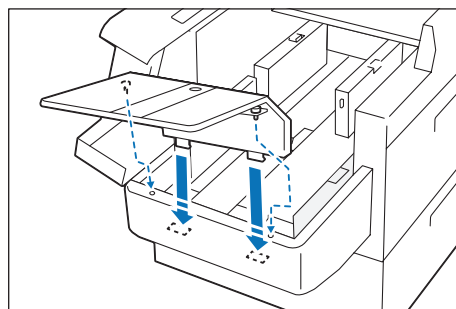

**(2) Insert the supporting plate.**

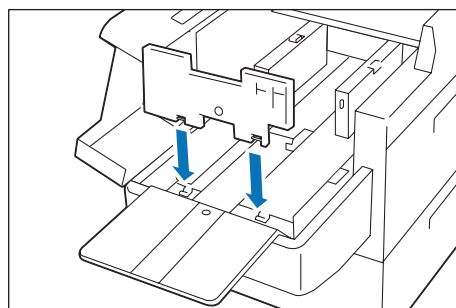

When not in use, hang the parts on the holder of the lower part.

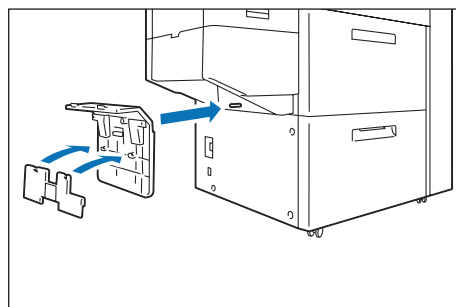

**5. Turn the lever on the left of the long-side paper guide upward.**

**6. Remove any paper remaining in the Tray.**

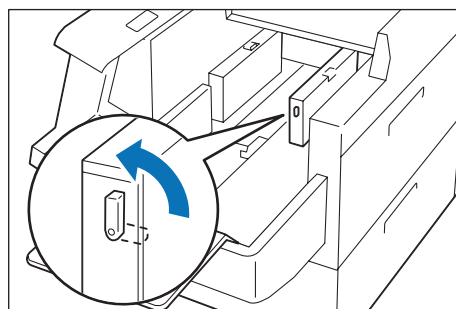

**7. If the short-side paper guide is standing, store it.**

**(1) Open the shutter while pinching the lever.**

**(2) Lay the paper guide down while holding the release lever.**

**(3) Close the shutter while pinching the lever.**

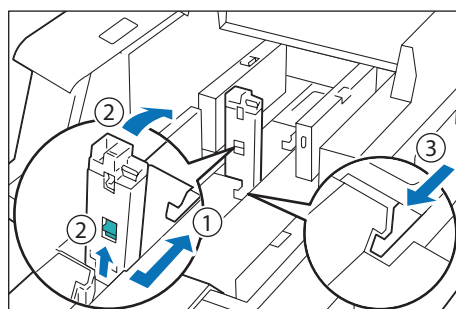

8. Fan the paper well and load sheets with the printed side facing up, and the paper edges aligned in the direction of the arrow (①).

9. Pinch the right side long-side paper guide grip and adjust to the correct paper size (②).

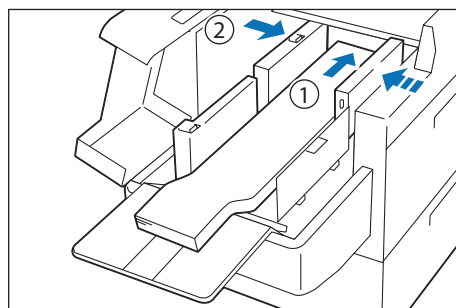

10. Pinch the left side long-side paper guide grip and adjust to the correct paper size (①).

11. Place the bottom edge paper guide to fit the loaded paper (②).

**Note**

The bottom edge guide is removable. Install it in the direction such that the metal surface touches paper.

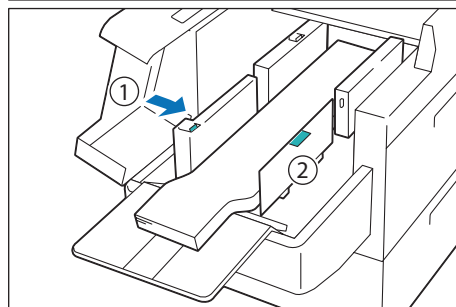

12. Close two covers (①) and wait until the bottom plate rises.

13. Place the rear edge paper guide to fit the loaded paper (②).

**Note**

The rear edge guide is removable. Install it in the direction such that the metal surface touches paper.

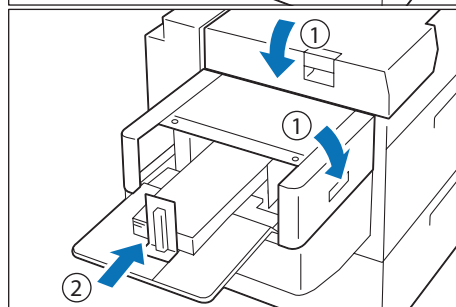

## 3 Interface Decurler Module

### Device Components

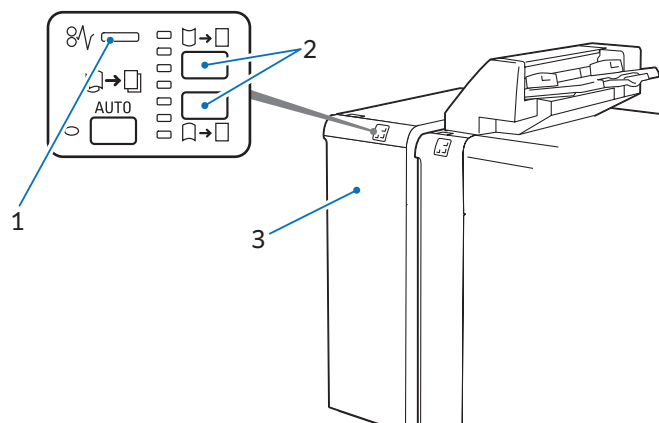

No.	Component	Function
1	Error Indicator	When paper jam occurs, the indicator is turned on. When the indicator blinks, first of all perform the paper jam operation.
2	Curl correction button	Press the button to correct paper curl. This curl correction function can be used during printing.
3	Cover	Open this cover to clear paper jams.

### Main Specifications

Item	Description
Power supply	AC 100-240 V +/- 10 %, 2.5 A (100 V) / 1 A (240 V), 50/60 Hz common
Maximum power consumption	250 W
Dimensions	W 340 x D 725 x H 992 mm
Weight	40 kg

#### Note

Interface Decurler Module is necessary for connecting High Capacity Stacker, Finisher, or Finisher with Booklet Maker, to the printer.

## Curl Correction

The curl correction button is used to correct paper curl caused by heat and/or pressure. The curl correction button can be operated regardless of the machine state when the machine is ON.

### Note

- This curl correction function can be used during printing. Fine correction according to the paper properties can be made from Printer User Interface.
- Since staples are likely to be affected by curl, make sure to perform curl correction by checking the curl direction of output paper.
- When correction is performed while the machine is in operation, it is applied to the paper output immediately after the button is pressed.

### 1. Check the curl direction of paper.

### 2. Confirm that the curl correction indicator is lit, and then press the button.

### Note

- When paper is fed in the [AUTO] mode, the indicator showing the present direction and intensity of curl correction turns on only for a brief moment. When manually applying the curl correction, make adjustments while using this indicator lighting as a guide.
- After applying the curl correction by upward curl correction button or downward curl correction button, when feeding thick paper, embossed paper, or OHP film, the [AUTO] is entered automatically, and the curl correction is applied using standard correction value.

You can also change to a setting that the mode does not change to [AUTO] mode even when using these paper types. Please contact your local dealer for more information.

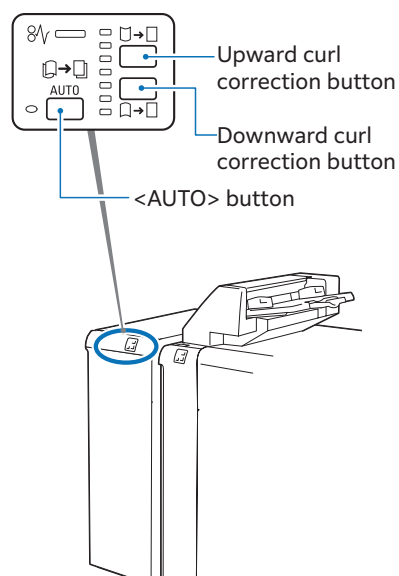

## Operations and Functions of Curl Correction

Press the AUTO button to enter the [AUTO] mode.

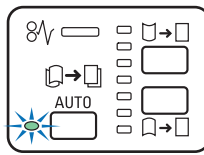

Indicator	Mode	Function
	AUTO	Curl correction is automatically performed. It is recommended to use this mode basically. Optimum curl correction is performed according to the paper size and output direction.
	OFF	Curl correction is not performed.
	Upward curl	Upward curl correction is performed when output paper is curled upward. Every time the upward curl correction button is pressed, the degree of correction is changed. The higher the indicator's position, the stronger the correction.
	Downward curl	Downward curl correction is performed when output paper is curled downward. Every time the downward curl correction button is pressed, the degree of correction is changed. The lower the indicator's position, the stronger the correction.

# Paper Jams

## Note

The error indicator at the top of the machine is turned on. When the indicator blinks, first of all perform the paper jam operation.

If paper is jammed, the machine stops and an alarm sounds. Follow the instructions displayed on the screen to remove the jammed paper.

Gently remove the paper being careful not to tear it. If paper is torn while it is being removed from the machine, remove all the torn pieces making sure that none remain inside the machine.

When you have finished clearing the paper jam, printing is resumed from the state before the paper jam occurred.

## Note

Clear the paper jams while the machine is on.

### 1. Open the Cover.

### 2. Open lever [1a] downward (①), turn knob [1b] counterclockwise (②), and remove the jammed paper (③).

## Note

- Make sure to turn knob 10 times or more.
- When removing paper, make sure to remove it as pulling it out slowly.
- Jammed paper may be hidden at the upper section.

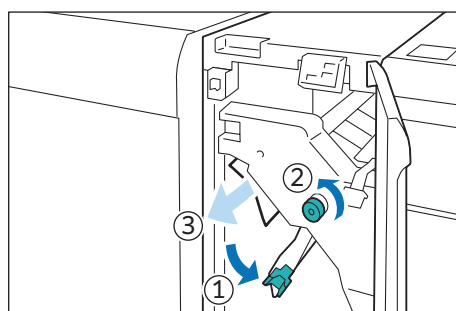

### 3. Return lever [1a].

### 4. If you have difficulty in removing the papers, open lever [1c] upward (①) and remove the jammed paper (②).

### 5. Return lever [1c].

### 6. Close the cover.

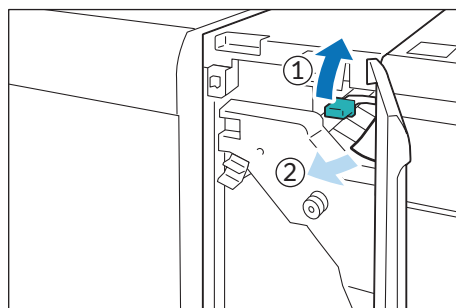

## 4 Inserter

### Device Components

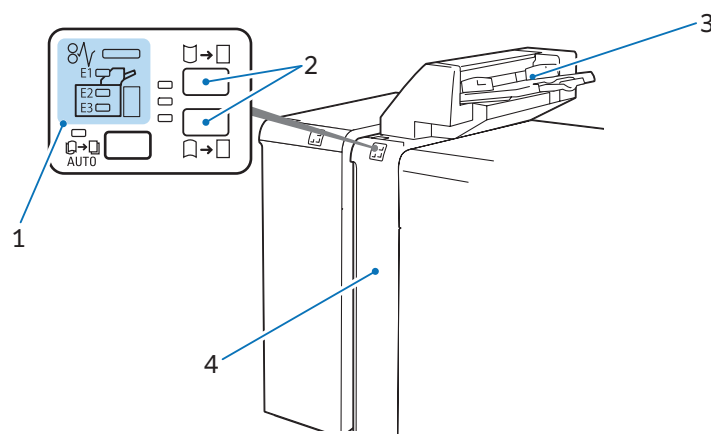

No.	Component	Function
1	Error Indicator	When paper jam occurs, the indicator is turned on. When the priority device indicator (top lamp) blinks, first of all perform the paper jam operation.
2	Curl correction button	Use this button when curl cannot be corrected even if the highest correction (or lowest correction) of Interface Decurler Module is performed. The correction method is the same as the Interface Decurler Module. The 3 correction levels are available: OFF, upward, and downward.  <b>Refer</b> "Curl Correction" (p.36)
3	Inserter Tray (Paper Tray T1)	Load paper to be used as an interleaf or cover.
4	Cover	Open this cover to clear paper jams.

## Main Specifications

Item	Description
Paper size	Standard size: Max SRA3 (320 x 450 mm), 12.6×19.2" (320 x 488 mm), Min A5 Custom size: 182 x 148 mm to 330 x 488 mm
Paper weight	52 to 350 g/m <sup>2</sup>
Paper capacity* <sup>1</sup>	250 sheets
Power supply	Supplied from Interface Decurler Module
Dimensions	W 700* <sup>2</sup> x D 725 x H 1235 mm
Weight	37 kg

\*1: 82 g/m<sup>2</sup> paper

\*2: The width of the paper transfer part only when connected to the device is 165 mm.

<b>Note</b>
-------------

High Capacity Stacker, Finisher, or Finisher with Booklet Maker is required.

# Loading Paper

Load paper (blank paper or printed paper) to be used as an interleaf or cover.  
Insertor Tray is used to load paper used as an interleaf or cover, and print cannot be performed.

## Note

- After removing all the paper from the Tray, and then load the paper again together with the paper you want to add.
- Saddle stitch / single fold is available only when the same paper size is used as with the body (paper output from the printer main unit).
- Load paper first before starting the job.

1. Fan the paper well and insert it along the paper guide all the way until it touches the back.

## Important

Do not load paper above the maximum fill line. It may cause paper jams or machine malfunction.

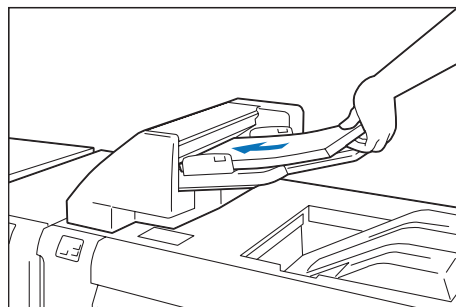

2. Adjust the paper guide to the size of loaded paper.

## Note

If the paper guide width is narrower or wider than the paper, it may cause paper jams.

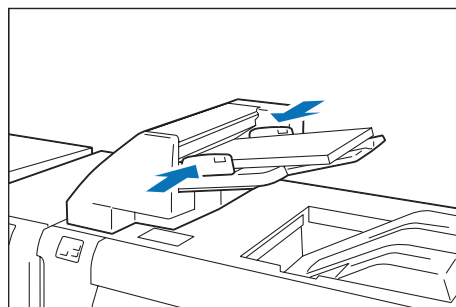

## Special Media Setting

### ■ Hole Punched Paper

Orientation: Place the holes of paper on the right side when you face the front side of machine.

### ■ Precut Tab

Orientation: Place the tabs of paper on the left side when you face the front side of machine.

## Purge Function

The printer stops printing when paper runs out. When this happens, sheets of paper being fed are delivered to the optional unit's output tray.

## Note

- Do not reuse the sheets ejected by the Purge function, as this may cause paper jams.
- You can also set so that purging does not occur when paper runs out.

# Paper Jams

## Note

The error indicator at the top of the machine is turned on. When the priority device indicator (top lamp) blinks, first of all perform the paper jam operation.

If paper is jammed, the machine stops and an alarm sounds. Follow the instructions displayed on the screen to remove the jammed paper.

Gently remove the paper being careful not to tear it. If paper is torn while it is being removed from the machine, remove all the torn pieces making sure that none remain inside the machine.

When you have finished clearing the paper jam, printing is resumed from the state before the paper jam occurred.

## Note

Clear the paper jams while the machine is on.

### 1. Remove the jammed paper.

When Indicator E1 is Turned on.....p.42

When Indicator E2 is Turned on.....p.42

When Indicator E3 is Turned on.....p.43

#### ■ When Indicator E1 is Turned on

- (1) Open the Upper Cover and remove all the jammed papers and papers loaded on the tray.
- (2) Close the cover.
- (3) Align the 4 corners of the removed papers and load them again.

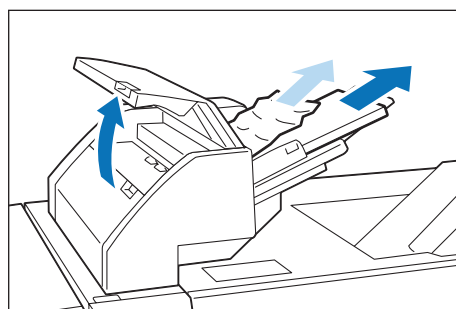

#### ■ When Indicator E2 is Turned on

- (1) Open the Cover.
- (2) Open lever [1a] upward (①), turn knob [1b] counter-clockwise (②), and remove the jammed paper (③).
- (3) Return lever [1a].

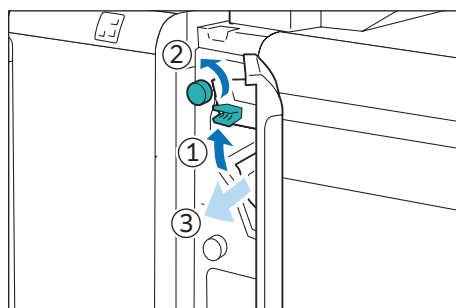

- (4) If you have difficulty in removing the papers, open lever [1c] to the right (①), turn knob [1b] counterclockwise (②), and remove the jammed paper (③).

- (5) Return lever [1c].

- (6) Close the cover.

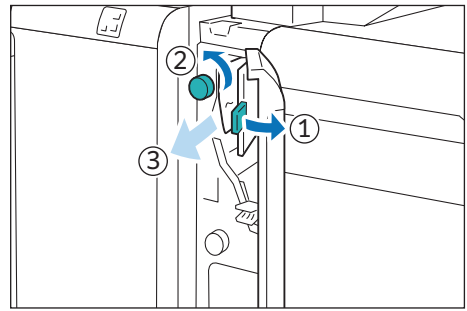

## ■ When Indicator E3 is Turned on

- (1) Open the Cover.

- (2) Open lever [1d] downward (①), turn knob [1e] counterclockwise (②), and remove the jammed paper (③).

### Note

Jammed paper may be hidden at the upper section.

- (3) Return lever [1d].

- (4) If you have difficulty in removing the papers, open lever [1a] upward (①), turn knob [1e] clockwise (②), and remove the jammed paper (③).

- (5) Return lever [1a].

- (6) Close the cover.

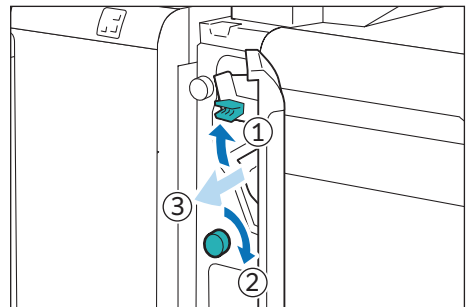
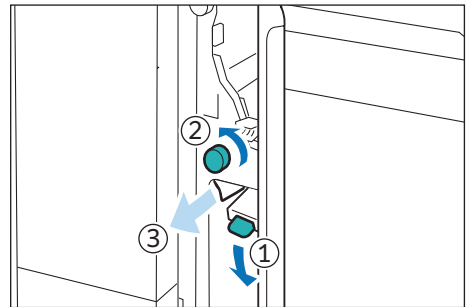

## 2. Check the curl direction of the jammed paper and correct the curl.

### Refer

"Curl Correction" (p.36)

## 5 Static Eliminator

### Device Components

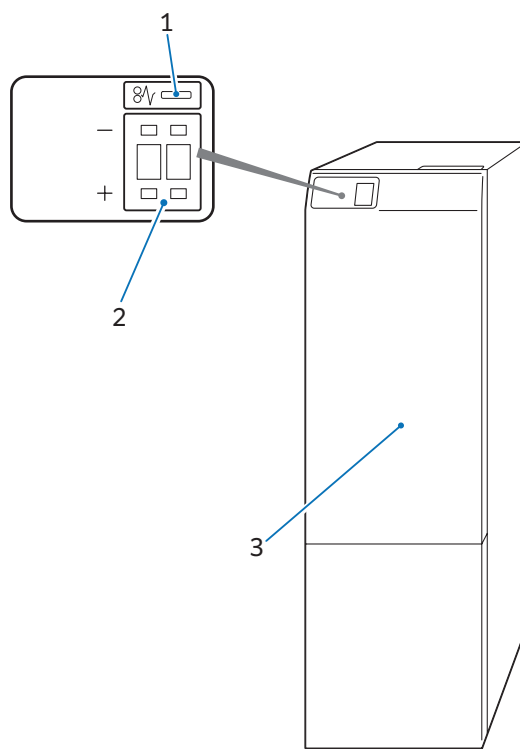

No.	Component	Function
1	Error Indicator	When paper jam occurs, the indicator is turned on. When the indicator blinks, first of all perform the paper jam operation.
2	Applied voltage count	Set applied voltage according to the media to feed. Set "00" for media that do not need static electricity discharge. <b>Important</b> If media are fed as applied voltage is set, it may cause a failure according to the media.
3	Cover	Open this cover to clear paper jams.

### Main Specifications

Item	Description
Power supply	AC 100-127 V +/- 10 %, 3A, AC 200-240 V +/- 10 %, 1.8 A, 50/60 Hz common
Maximum power consumption	300 W
Dimensions	W 232 x D 725 x H 992 mm
Weight	37 kg

#### Note

Interface Decurler Module is required.

## Setting Voltage

### 1. Enter a value according to the media to use.

Humidity	Media	Standard value	Upper limit
Low humidity (15% or less)	PET	65	to 90
	Surface layer: Resin Inner layer: Paper	65	to 99
Normal humidity (16 to 55%)	PET	50	to 70
	Surface layer: Resin Inner layer: Paper	60	to 99
High humidity (56% or more)	PET	40	to 60
	Surface layer: Resin Inner layer: Paper	65	to 99

#### Note

- Static electricity may not be discharged sufficiently according to the media.
- Applied voltage of multiple-layer media that consist of resin and paper is higher than that of single-layer media.
- Adherence may remain in the case of multi-layer media.

### 2. Make test prints (about 3 to 5 prints) and check the degree of adherence.

### 3. When adherence occurs, change the value by +1 (when the degree of adherence is small) to +10 (when the degree of adherence is large) as checking the degree of adherence.

Do not enter a value exceeding the upper limit. Do not increase the value by +11 or more at once.

#### Note

If the value is increased too much, it also causes adherence of media.

## Paper Jams

### Note

The error indicator at the top of the machine is turned on. When the indicator blinks, first of all perform the paper jam operation.

If paper is jammed, the machine stops and an alarm sounds. Follow the instructions displayed on the screen to remove the jammed paper.

Gently remove the paper being careful not to tear it. If paper is torn while it is being removed from the machine, remove all the torn pieces making sure that none remain inside the machine.

When you have finished clearing the paper jam, printing is resumed from the state before the paper jam occurred.

### Note

Clear the paper jams while the machine is on.

1. Open the Cover.
2. Open lever [1a] downward (①), turn knob [1b] clockwise (②), and remove the jammed paper (③).
3. Return lever [1a].
4. Close the cover.

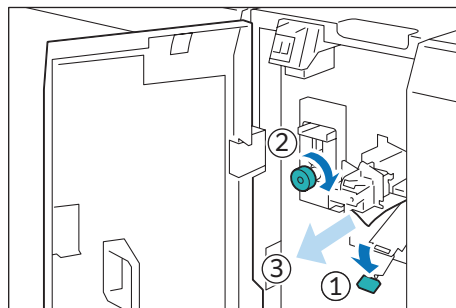

## 6 High Capacity Stacker

### Device Components

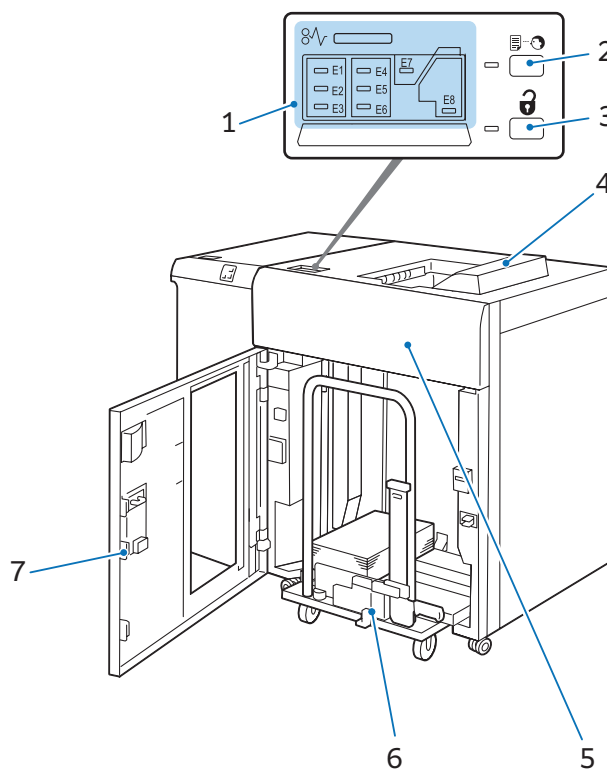

No.	Component	Function
1	Error Indicator	When paper jam occurs, the indicator is turned on. When the priority device indicator (top lamp) blinks, first of all perform the paper jam operation.
2	Sample button	Press the button to output a sample to the Top Output Tray.
3	Paper eject button	Press the button to stop printing and take out outputs.
4	Top Output Tray	Outputs are delivered here. A sample is delivered here.
5	Front Upper Cover	Open this cover to clear paper jams.
6	Stacker Tray (Stacker cart)	When the paper eject button is pressed, paper is moved to the stacker cart and ejected.
7	Lower Front Cover	Open this cover to take out outputs.

#### Note

The installed first and second High Capacity Stackers are the same one.

## Main Specifications

Item		Description
Paper capacity*1	Output Tray	500 sheets*2
	High Capacity Stacker – Stacker Cart	5000 sheets
Paper size	Output Tray	Standard size: Max SRA3 (320 x 450 mm), 12.6×19.2" (320 x 488 mm), Min A6 Custom size: 98 x 148 mm to 330 x 488 mm*3
	High Capacity Stacker – Stacker Cart	Standard size: Max SRA3 (320 x 450 mm), 12.6×19.2" (320 x 488 mm), Min JIS B5 Custom size: 203 x 182 mm to 330 x 488 mm
Paper weight	Output Tray	52 to 400 g/m <sup>2</sup>
	High Capacity Stacker – Stacker Cart	52 to 300 g/m <sup>2</sup>
Power supply		AC 100-240 V +/- 10 %, 1.5 A (100 V) / 0.8 A (240 V), 50/60 Hz common
Maximum power consumption		192 W
Dimensions		W 800 x D 725 x H 1042 mm
Weight*4		155 kg

\*1: 82 g/m<sup>2</sup> paper

\*2: When the optional High Capacity Stacker Top Tray Extension Kit is installed, 250 sheets. For paper longer than 330 x 488 mm, the capacity is not guaranteed. 100 sheets of long paper up to 330 x 729 mm; 10 sheets of long paper up to 330 x 1200 mm can be stacked.

\*3: When the optional High Capacity Stacker Top Tray Extension Kit is installed, maximum 330 x 1200 mm.

\*4: Including Stacker Cart.

### Note

Interface Decurler Module is required.

# Outputting Paper

## Top Output Tray

### Banner Print Extension Kit

Long paper can be loaded without its lead edge sticking out.

Paper size (mm)	Tray capacity (sheets)
Width: 210 to 330.2 Length: 488.1 to 1,200	Up to 729 mm: 100 More than 729.1 mm: 10
	<b>Note</b> This value applies if 82 g/m <sup>2</sup> paper is used.

#### Important

When paper exceeding the tray capacity is loaded, the Extension Tray may get broken.

#### Note

When the extension kit is installed, 250 sheets of paper (82 g/m<sup>2</sup> paper) of which length is 488 mm or less can be loaded.

### ■ Extension Tray

Insert 2 extension trays until they stop.

#### Note

Pass them through over the guide at the rear side of the tray until they stop.

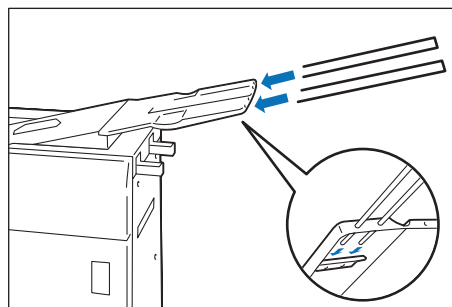

### ■ Lightweight paper housing wire

When it is difficult to load thin paper, install the wire.

#### Note

- The tray capacity is 10 sheets.
- Paper of which width is 256 mm or less cannot be used.
- The supported paper weights are from 82 to 127 g/m<sup>2</sup>.

- (1) Remove the 2 Extension Trays and insert the wire mounting U-shaped bar until it stops.

#### Note

Pass them through over the guide at the rear side of the tray until they stop.

- (2) Install the wires on the U-shaped bar.

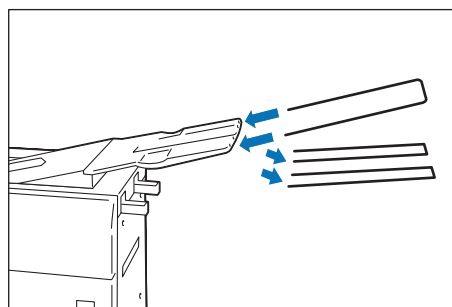

**Note**

As holding the U-shaped bar with a hand, insert the fixing devices firmly, and check that the wires will not come off from the U-shaped bar.

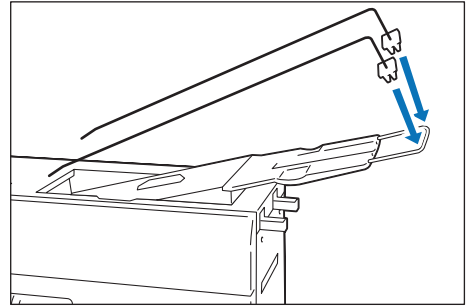

**(3) Adjust the wire positions according to the size of paper to be output.**

**Note**

Install the wires in parallel.

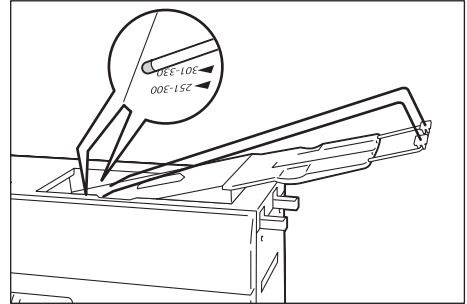

▪ **When not using the kit**

(When Finisher is installed)

Store the kit in the storage case at the rear side of Finisher.

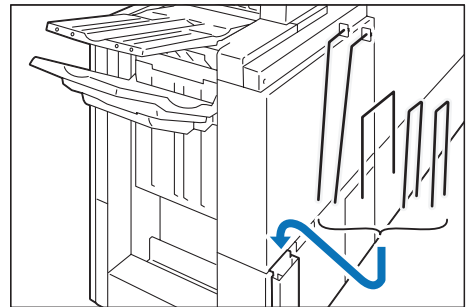

(When Finisher is not installed)

Hang the kit on the holder at the side of the stacker.

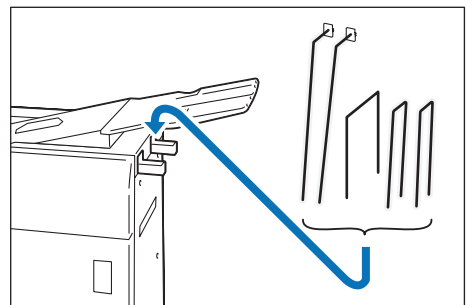

# Paper Jams

## Note

The error indicator at the top of the machine is turned on. When the priority device indicator (top lamp) blinks, first of all perform the paper jam operation.

If paper is jammed, the machine stops and an alarm sounds. Follow the instructions displayed on the screen to remove the jammed paper.

Gently remove the paper being careful not to tear it. If paper is torn while it is being removed from the machine, remove all the torn pieces making sure that none remain inside the machine.

When you have finished clearing the paper jam, printing is resumed from the state before the paper jam occurred.

## Note

Clear the paper jams while the machine is on.

### 1. Remove the jammed paper.

When Indicator E1 is Turned on.....	p.51
When Indicator E2 is Turned on.....	p.51
When Indicator E3 is Turned on.....	p.52
When Indicator E4 is Turned on.....	p.52
When Indicator E5 is Turned on.....	p.52
When Indicator E6 is Turned on.....	p.53
When Indicator E7 is Turned on.....	p.53
When Indicator E8 is Turned on.....	p.54

#### ■ When Indicator E1 is Turned on

- (1) Open the front upper cover.
- (2) Open lever [1b] upward (①) and remove the jammed paper (②).
- (3) Return lever [1b].
- (4) Close the cover.

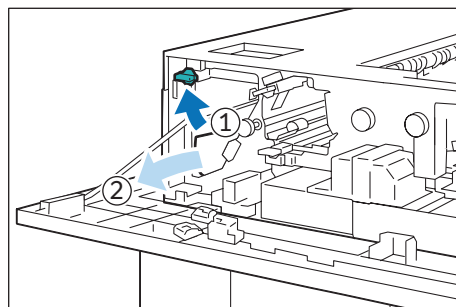

#### ■ When Indicator E2 is Turned on

- (1) Open the front upper cover.
- (2) Open lever [1b] upward (①), turn knob [1a] counter-clockwise (②), and remove the jammed paper (③).
- (3) Return lever [1b].
- (4) Close the cover.

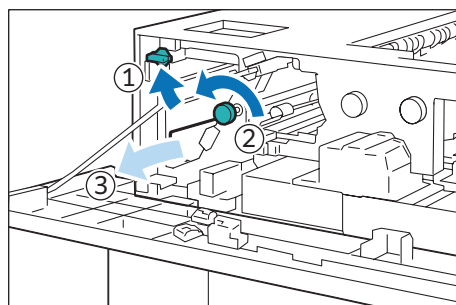

.....

### ■ When Indicator E3 is Turned on

- (1) Open the front upper cover.
- (2) Open lever [1b] upward (①), turn knob [1a] counter-clockwise (②), and remove the jammed paper (③).
- (3) Return lever [1b].

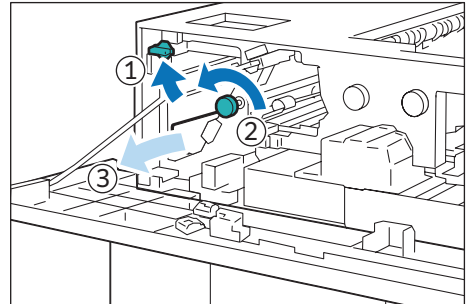

- (4) Open lever [2b] upward (①), turn knob [2c] counter-clockwise (②), and remove the jammed paper (③).
- (5) Return lever [2b].
- (6) Close the cover.

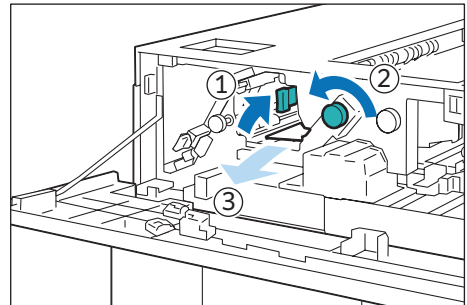

.....

### ■ When Indicator E4 is Turned on

- (1) Open the front upper cover.
- (2) Open lever [2a] downward (①) and remove the jammed paper (②).
- (3) Return lever [2a].
- (4) Close the cover.

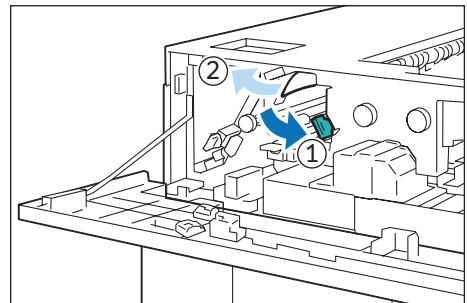

.....

### ■ When Indicator E5 is Turned on

- (1) Open the front upper cover.
- (2) Open lever [2b] upward (①), turn knob [2c] counter-clockwise (②), and remove the jammed paper (③).
- (3) Return lever [2b].
- (4) Close the cover.

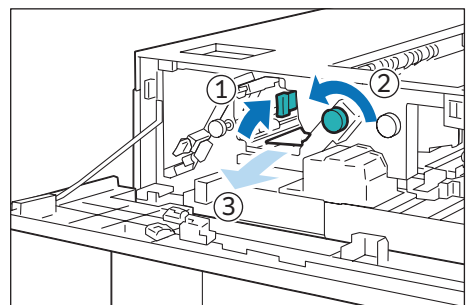

.....

### ■ When Indicator E6 is Turned on

- (1) Press the paper eject button.
- (2) When lock is released, open the front lower cover.
- (3) Pull out the stacker cart slowly and remove the jammed paper.
- (4) Return the stacker cart slowly.
- (5) Close the cover.

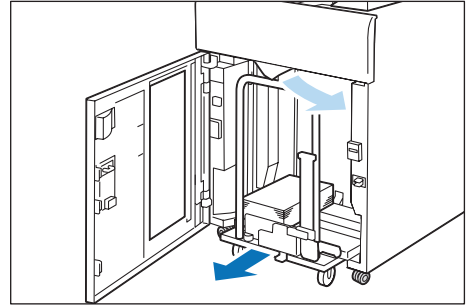

.....

### ■ When Indicator E7 is Turned on

- (1) Remove the jammed paper that sticks out from the exit of the Top Output Tray.
- (2) Open the front upper cover.

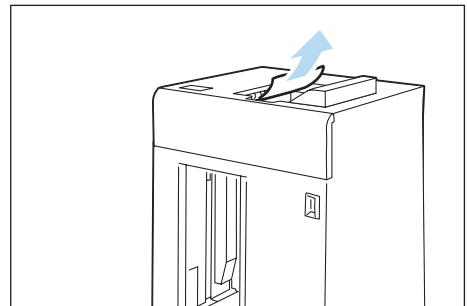

- (3) Open lever [1b] upward (①) and remove the jammed paper (②).
- (4) Return lever [1b].

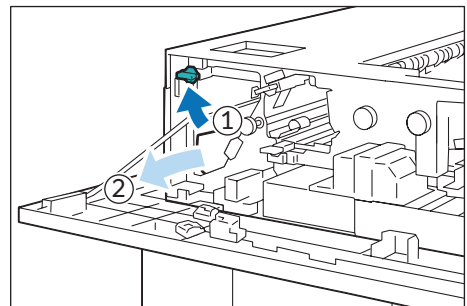

- (5) Open lever [2a] downward (①) and remove the jammed paper (②).
- (6) Return lever [2a].
- (7) Close the cover.

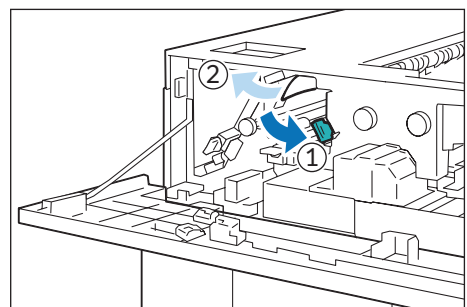

.....

### ■ When Indicator E8 is Turned on

- (1) Open the front upper cover.
- (2) Open lever [3b] upward (①), turn knob [3a] clockwise (②), and remove the jammed paper (③).
- (3) Return lever [3b].
- (4) Close the cover.

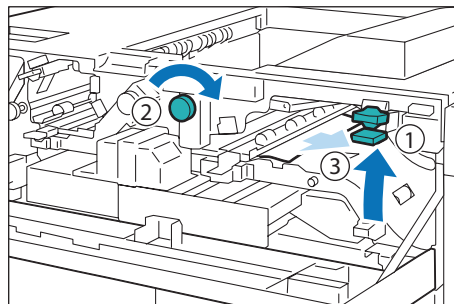

.....

## 2. Check the curl direction of the jammed paper and correct the curl.

### Refer

"Curl Correction" (p.36)

## 7 Crease / Two-Sided Trimmer

### Device Components / Caution Labels

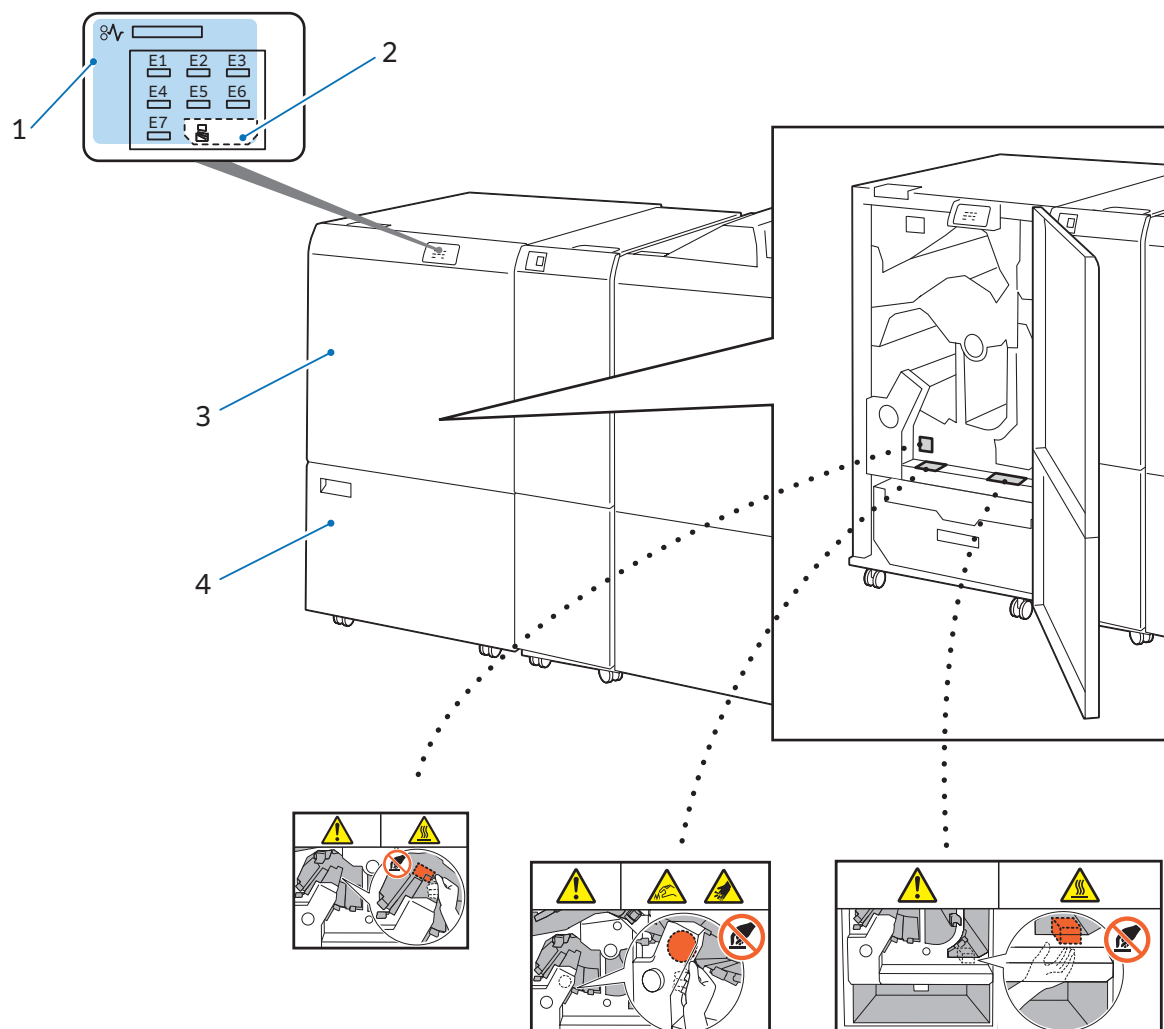

No.	Component	Function
1	Error Indicator	When paper jam occurs, the indicator is turned on. When the priority device indicator (top lamp) blinks, first of all perform the paper jam operation.
2	Waste full indicator	When cut pieces need to be disposed, the indicator is turned on. When cut pieces become full, the indicator blinks.
3	Upper Cover	Open this cover to clear paper jams.
4	Lower Cover	Open this cover to dispose cut pieces.

## Main Specifications

Item		Description
Two-sided Trim	Paper size	Standard size: Max SRA3 (320 x 450 mm), 12.6×19.2" (320 x 488 mm), Min A4, Letter Custom size: 194 x 210 mm to 330 x 488 mm
	Paper weight	52 to 350 g/m <sup>2</sup>
	Trim dimensions	One side: 6 to 25 mm
Crease	Paper size	Standard size: Max SRA3 (320 x 450 mm), 12.6×19.2" (320 x 488 mm), M Min JIS B5 Custom size: 182 x 210 mm to 330 x 488 mm
	Paper weight <sup>*1</sup>	60 to 350 g/m <sup>2</sup>
	Number of lines <sup>*2</sup>	1 to 5
Power supply		AC 100-240 V +/- 10 %, 4 A (100 V) / 2 A (240 V), 50/60 Hz common
Maximum power consumption		480 W
Dimensions		W 605 x D 725 x H 992 mm
Weight		128 kg

\*1: When using the booklet finishing, 157 g/m<sup>2</sup> or more is supported for single sheet.

\*2: The continuous print speed will decrease significantly as the number of lines increases.

### Note

Finisher or Finisher with Booklet Maker is required.

## Cutting and Crease Area

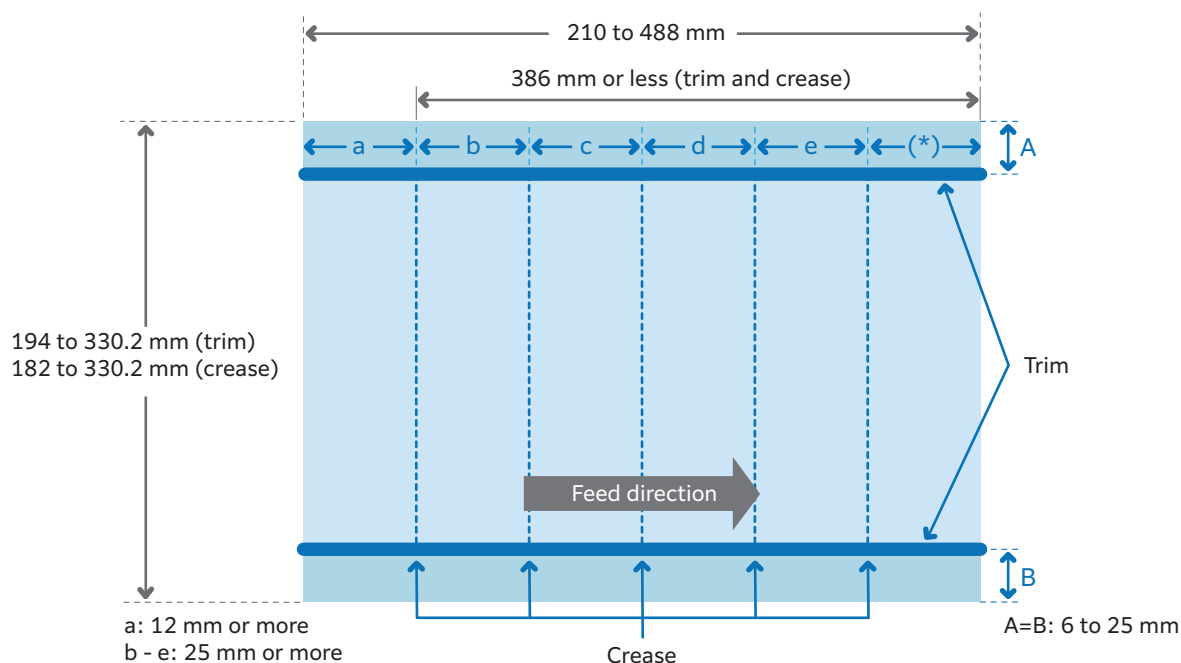

Printing is not possible when less than 45 mm from the front edge. Also, the paper feeding capability is not guaranteed when 62 mm or less from the front edge.

## Waste Container

When cut pieces need to be disposed, the waste full indicator is turned on. When it is turned on, dispose cut pieces.

### Note

- Cut pieces can be disposed even during printing.
- When cut pieces in the waste container become full, the waste full indicator changes from ON to blinking.

1. Open the lower cover.
2. Pull out the waste container.
3. Dispose all cut pieces.

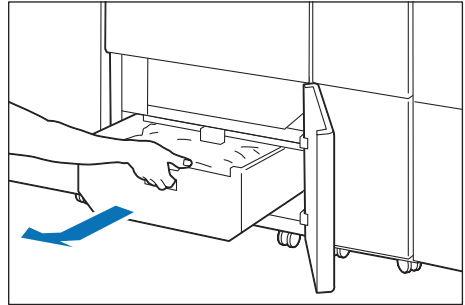

Confirm that there are no cut pieces at the bottom of the frame at the rear of the waste container.

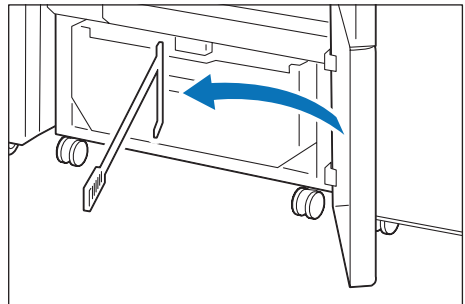

Remove cut pieces using a waste collecting bar, if any.

4. Insert the Waste Container into the original position.

### Note

Push it until its arrow comes to the frame face.

5. Close the cover.

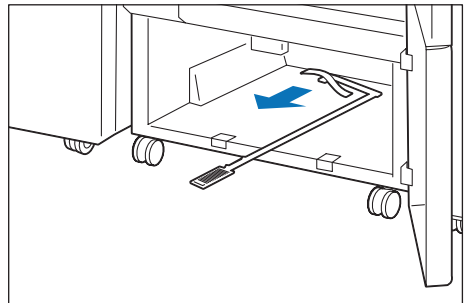

# Paper Jams

## Note

The error indicator at the top of the machine is turned on. When the priority device indicator (top lamp) blinks, first of all perform the paper jam operation.

If paper is jammed, the machine stops and an alarm sounds. Follow the instructions displayed on the screen to remove the jammed paper.

Gently remove the paper being careful not to tear it. If paper is torn while it is being removed from the machine, remove all the torn pieces making sure that none remain inside the machine.

When you have finished clearing the paper jam, printing is resumed from the state before the paper jam occurred.

## Note

Clear the paper jams while the machine is on.

### 1. Open the upper cover.

### 2. Remove the jammed paper.

When Indicator E1 is Turned on.....	p.58
When Indicator E2 is Turned on.....	p.59
When Indicator E3 is Turned on.....	p.60
When Indicator E4 is Turned on.....	p.60
When Indicator E5 is Turned on.....	p.61
When Indicator E6 is Turned on.....	p.61
When Indicator E7 is Turned on.....	p.62

### ■ When Indicator E1 is Turned on

- (1) Open lever [1a] downward (①), open lever [1b] downward (②), open lever [1d] upward (③), and remove the jammed paper (④).

## Note

Jammed paper may be hidden at the upper section.

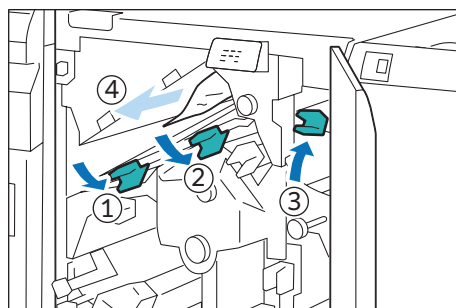

- (2) If you have difficulty in removing the papers, turn knob [1c] clockwise (①) and remove the jammed paper (②).

- (3) Return lever [1a], lever [1b], and lever [1d].

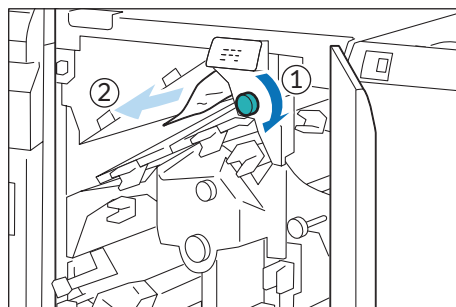

.....

■ When Indicator E2 is Turned on

(1) Turn knob [2] counterclockwise and align the marks.

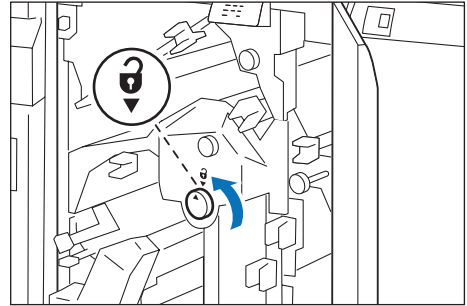

(2) Open lever [1a] downward (①) and open lever [1b] downward (②).

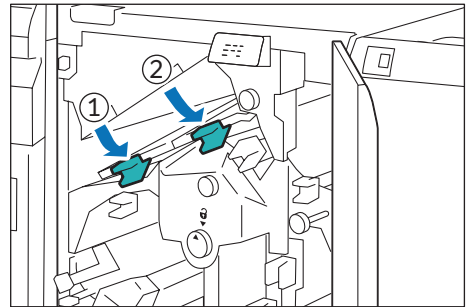

(3) Turn knob [1c] clockwise (①) and remove the jammed paper (②).

(4) Return lever [1a] and lever [1b].

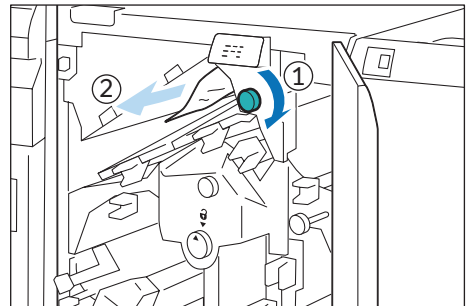

(5) If you have difficulty in removing the papers, open lever [1d] upward (①) and open lever [2a] to the left (②).

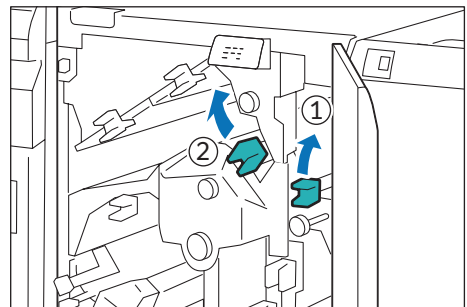

(6) Turn knob [2b] counterclockwise (①) and remove the jammed paper (②).

(7) Return lever [1d] and lever [2a].

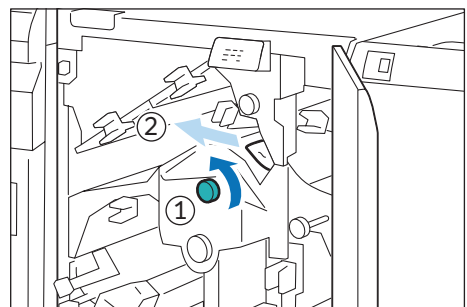

### ■ When Indicator E3 is Turned on

- (1) Turn knob [2] counterclockwise and align it with the mark position.

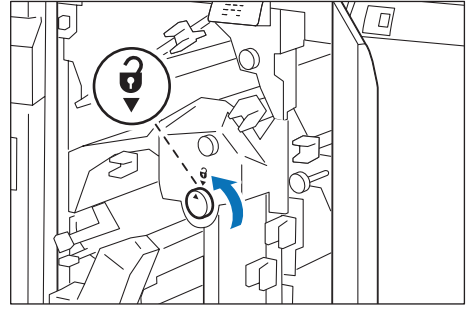

- (2) Open lever [2c] downward (①) and remove the jammed paper (②).

#### Note

Jammed paper may be hidden at the upper section.

- (3) Return lever [2c].

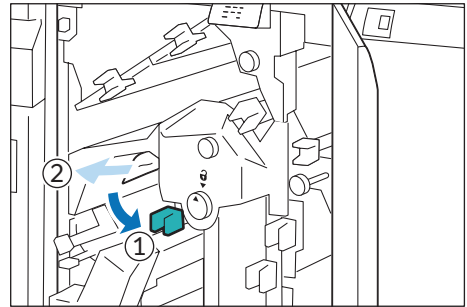

### ■ When Indicator E4 is Turned on

- (1) Open lever [2c] downward (①), open lever [2d] upward (②), and open lever [2e] to the right (③).

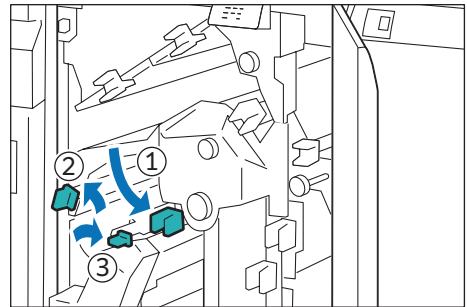

- (2) Hold the lead edge of paper, turn knob [2f] clockwise (①), and remove the jammed paper (②).

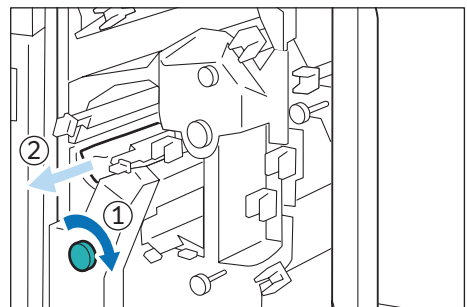

If you have difficulty in removing the papers, hold the trail edge of the paper and remove it.

- (3) Return lever [2e], lever [2d], and lever [2c].

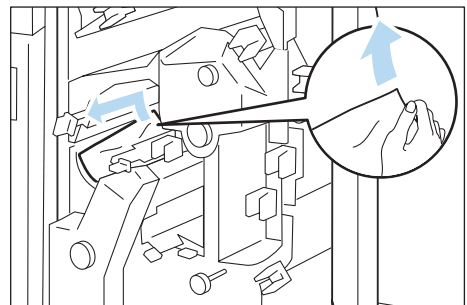

.....

### ■ When Indicator E5 is Turned on

- (1) Open lever [3a] to the right (①) and open lever [3b] to the left (②).

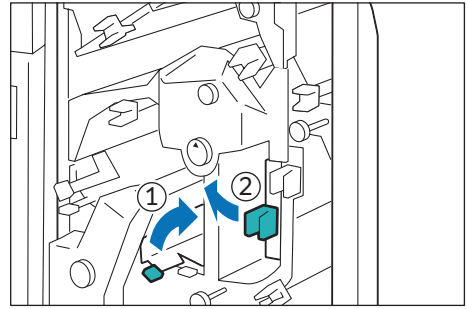

- (2) Turn knob [3c] clockwise (①) and remove the jammed paper (②).

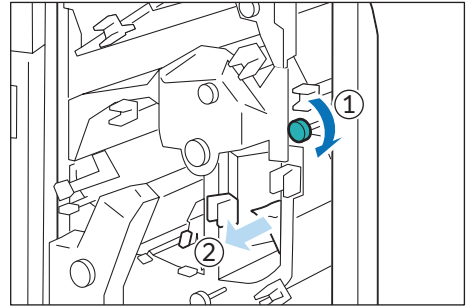

- (3) Turn knob [2f] counterclockwise (①) and remove the jammed paper (②).

- (4) Return lever [3a] and lever [3b].

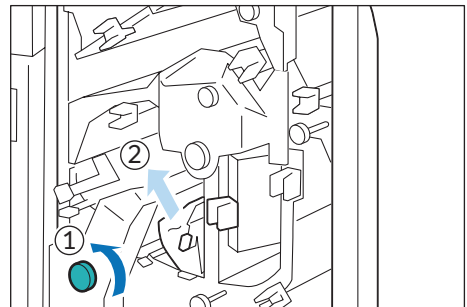

.....

### ■ When Indicator E6 is Turned on

- (1) Open lever [3a] to the right (①), open lever [4b] downward (②), open lever [4c] to the right (③), and remove the jammed paper (④).

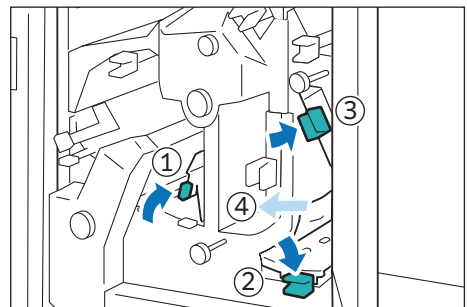

- (2) Turn knob [4d] counterclockwise (①) and remove the jammed paper (②).

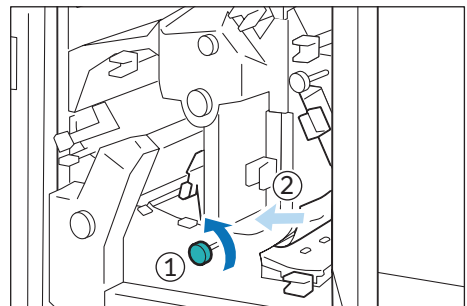

- (3) Open lever [4a] to the right (①), turn knob [2f] counter-clockwise (②), and remove the jammed paper (③).

**Note**

As holding the lever [4a] with a hand, turn knob [2f] and remove the paper.

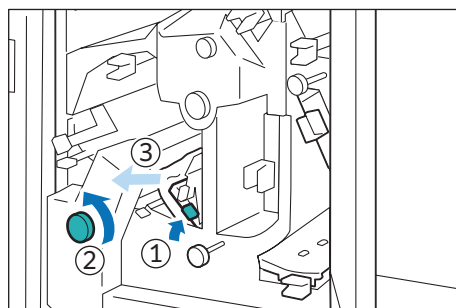

- (4) Turn knob [3c] clockwise (①) and remove the jammed paper (②).

- (5) Return lever [3a], lever [4b], and lever [4c].

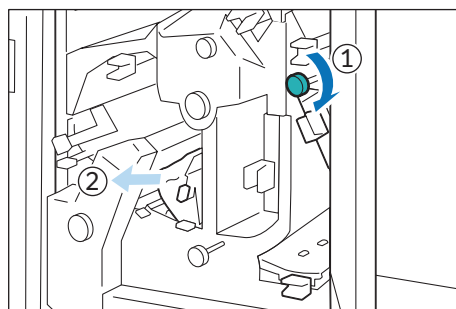

.....

■ **When Indicator E7 is Turned on**

- (1) Open lever [3a] to the right (①) and turn knob [2f] counter-clockwise (②).

**Note**

Make sure to turn knob 5 times or more.

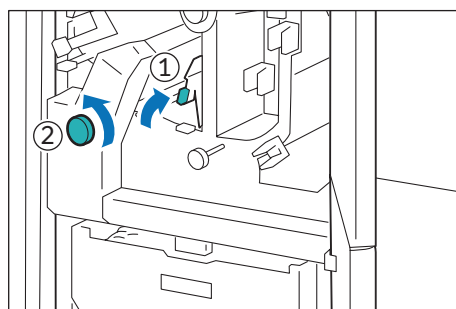

- (2) Pull out and insert the Waste Container 3 times.

- (3) Return lever [3a].

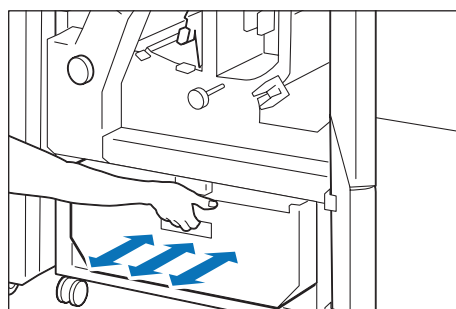

■ **When the indicator is not turned off**

- (1) Remove the waste collecting bar in the cover.

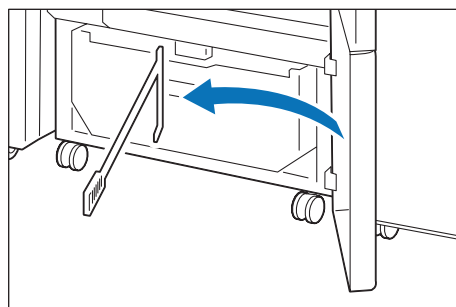

- (2) Open lever [3a] to the right (①) and open lever [3d] to the right (②).

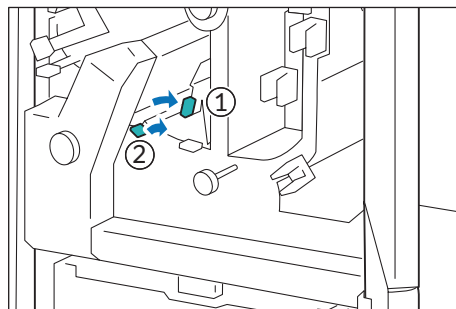

- (3) Collect cut pieces around the trimmer unit in the waste container using the waste collecting bar.

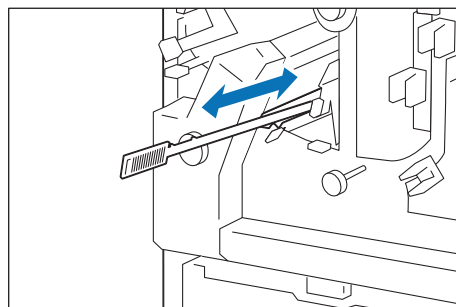

- (4) If cut pieces cannot be collected in the waste container, move them by the waste collecting bar and remove them with hands.

- (5) Return lever [3a] and lever [3d].

- (6) Confirm that there are no cut pieces at the bottom of the frame at the rear of the waste container. Remove cut pieces using a waste collecting bar, if any.

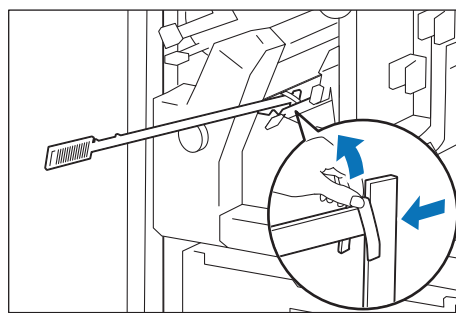

#### Refer

"Waste Container" (p.57)

### 3. Close the cover.

4. Check the curl direction of the jammed paper and correct the curl.

#### Refer

"Curl Correction" (p.36)

## 8 Folder Unit

### Device Components / Caution Labels

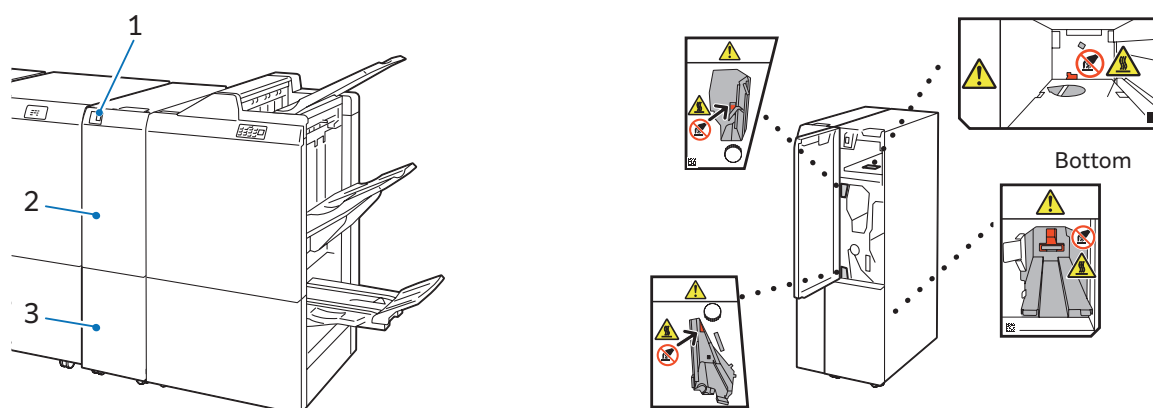

No.	Component	Function
1	Tri-Fold Output Tray Button	Press the button to remove paper from the Tri-Fold Output Tray. The Tri-Fold Output Tray is opened when the lamp stops blinking and comes on and the lock is released.
2	Cover	Open this cover to clear paper jams.
3	Tri-Fold Output Tray	Paper is ejected only to this tray in case of inner C Fold/Z Fold sheets.

### Main Specifications

Item		Description
Z-Fold Half Sheet	Paper size	A3, 11 x 17", JIS B4
	Paper weight	60 to 90 g/m <sup>2</sup>
Tri-fold	Paper size	A4, Letter
	Paper weight	60 to 90 g/m <sup>2</sup>
	Paper capacity*1	30 sheets
Power supply		AC 100-127 V +/- 10 %, 1 A, AC 200-240 V +/- 10 %, 0.6 A, 50/60 Hz common
Maximum power consumption		120 W
Dimensions		W 232 x D 725 x H 992 mm
Weight		48 kg

\*1: 82 g/m<sup>2</sup> paper

#### Note

Folder Unit is an option for Finisher and Finisher with Booklet Maker.

# Paper Jams

## Note

The error indicator at the top of the Finisher is turned on. When the priority device indicator (top lamp) blinks, first of all perform the paper jam operation.

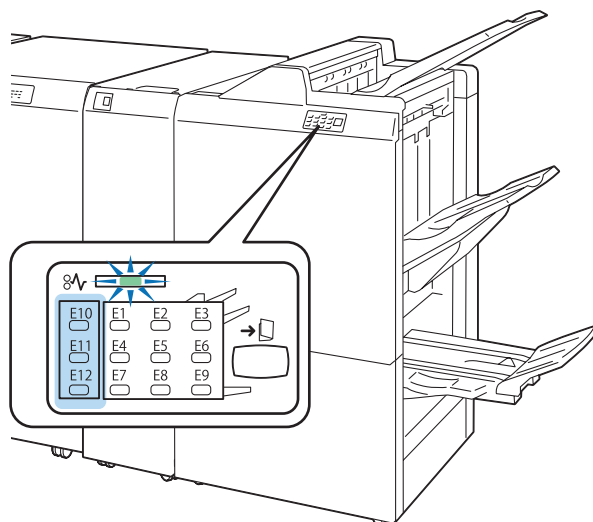

If paper is jammed, the machine stops and an alarm sounds. Follow the instructions displayed on the screen to remove the jammed paper.

Gently remove the paper being careful not to tear it. If paper is torn while it is being removed from the machine, remove all the torn pieces making sure that none remain inside the machine.

When you have finished clearing the paper jam, printing is resumed from the state before the paper jam occurred.

## Note

Clear the paper jams while the machine is on.

### 1. Open the Cover.

### 2. Remove the jammed paper.

When Indicator E10 is Turned on.....p.65

When Indicator E11 is Turned on.....p.66

When Indicator E12 is Turned on.....p.66

#### ■ When Indicator E10 is Turned on

(1) Open lever [2a] upward (①), open lever [2b] to the left (②), and remove the jammed paper (③).

(2) Return lever [2a] and lever [2b].

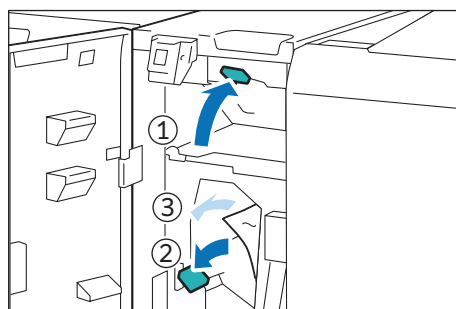

.....

### ■ When Indicator E11 is Turned on

- (1) Open lever [2g] to the right (①), turn knob [2c] counter-clockwise (②), and remove the jammed paper (③).
- (2) Return lever [2g].

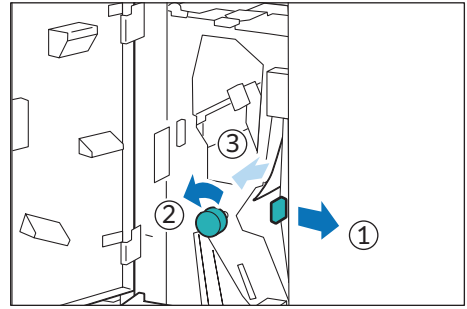

.....

### ■ When Indicator E12 is Turned on

- (1) Pull out the Tri-Fold Output Tray [2d].
- (2) Open lever [2e] to the right (①), turn knob [2c] counter-clockwise (②), and remove the jammed paper (③).
- (3) Return lever [2e].

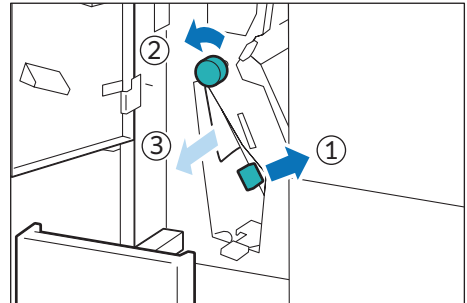

- (4) If you have difficulty in removing the papers, open lever [2f] to the right (①), turn knob [2c] counterclockwise (②), and remove the jammed paper (③).
- (5) Return lever [2f].
- (6) Return the Tri-Fold Output Tray [2d] to the original position.

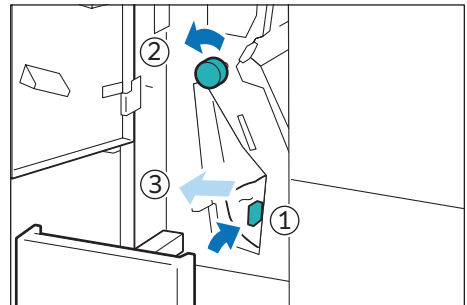

.....

### 3. Close the cover.

### 4. Check the curl direction of the jammed paper and correct the curl.

#### Refer

"Curl Correction" (p.36)

## 9 Finisher

In this guide, “Finisher” and “Finisher with Booklet Maker” are generally referred to as “Finisher”.

### Device Components / Caution Labels

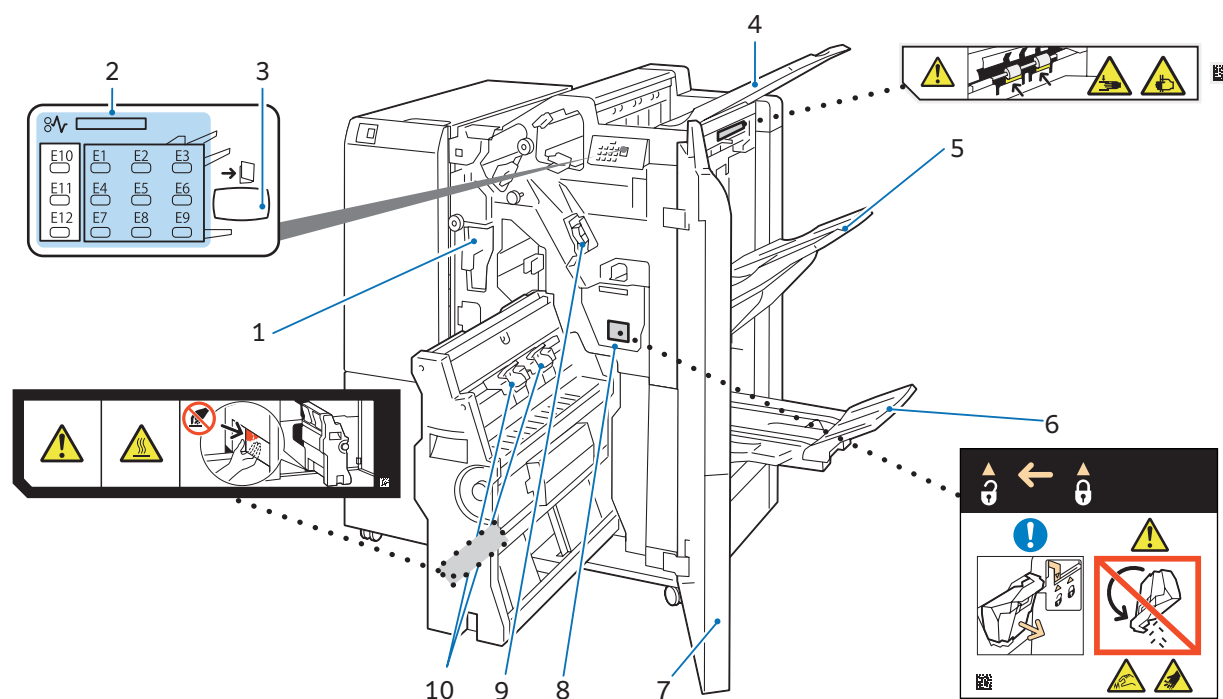

No.	Component	Function
1	Hole Punch Waste Container	<p>Punched pieces go in here.</p> <p><b>Refer</b></p> <p>For the discard method of waste in the waste container, refer to the label affixed on the machine.</p>
2	Error Indicator	<p>When paper jam occurs, the indicator is turned on.</p> <p>When the priority device indicator (top lamp) blinks, first of all perform the paper jam operation.</p>
3	Booklet output button	<p>When the button is pressed, paper output in the Booklet Tray is moved to the collecting position.</p> <p><b>Note</b></p> <p>When the Square Back Fold Trimmer is equipped, pressing of button moves to the Booklet Tray removal position of the Square Back Fold Trimmer.</p>
4	Top Output Tray	<p>Outputs are delivered here.</p>
5	Finisher Tray	<p>Side stitch paper is ejected.</p> <p><b>Note</b></p> <p>When 2,000 sheets or more of paper with large downward curl are output, a stack of output sheets may fall.</p> <p>In this case, set the lowest curl correction of Interface Decurler Module and downward curl correction of Insertter.</p>

No.	Component	Function
6	Booklet Tray	Saddle stitch and single fold paper is ejected. <div><b>Note</b> When the Square Back Fold Trimmer is equipped, it is installed to the Square Back Fold Trimmer.</div>
7	Cover	Open this cover to clear paper jams, replace the Staple Cartridge, remove jammed staples or dispose of cut pieces for punched holes.
8	Staple Waste Container	Staple waste goes in here.
9	Staple Cartridge for side stitch	This unit is used to replace staples for side stitch.
10	Staple Cartridges for saddle stitch	This unit is used to replace staples for saddle stitch. There are two.

## Main Specifications

Item		Description	
		Finisher	Finisher with Booklet Maker
Type	Output Tray	Sort / Stack	
	Finishing Tray	Sort (Offset available) / Stack (Offset available)	
	Booklet Tray	-	Sort / Stack
Paper size	Output Tray	Standard Size: Max SRA3 (320 x 450 mm), 12.6×19.2" (320 x 488 mm), Min A6 Custom Size: 98 x 148 mm to 330 x 1200 mm* <sup>1</sup>	
	Finishing Tray	Standard Size: Max SRA3 (320 x 450 mm), 12.6×19.2" (320 x 488 mm), Min A5 Custom Size: 148 x 148 mm to 330 x 488 mm	
Paper weight	Output Tray	52 to 400 g/m <sup>2</sup>	
	Finishing Tray	52 to 350 g/m <sup>2</sup>	
Paper capacity* <sup>2</sup>	Output Tray	500 sheets (A4)	
	Finishing Tray	[Without Stapling] A4: 3000 sheets JIS B4 or larger: 1500 sheets Mixed Size Stacking* <sup>3</sup> : 350 sheets [With Stapling] A4: 200 sets or 3000 sheets JIS B4 or larger: 100 sets or 1500 sheets	[Without Stapling] A4: 2000 sheets JIS B4 or larger: 1500 sheets Mixed Size Stacking* <sup>3</sup> : 350 sheets [With Stapling] A4: 200 sets or 2000 sheets JIS B4 or larger: 100 sets or 1500 sheets
	Booklet Tray	-	20 sets* <sup>4</sup>
Staple	Capacity	100 sheets (90 g/m <sup>2</sup> or less)* <sup>5</sup>	
	Paper size* <sup>6</sup>	Standard Size: Max A3, 11 x 17", Min JIS B5 Custom Size: 182 x 182 mm to 297 x 432 mm	
	Paper weight	52 to 350 g/m <sup>2</sup>	
	Position	Single stapling* <sup>7</sup> , Dual stapling, 4 stapling	
Punch* <sup>8</sup>	Number of Holes	2-hole / 4-hole punch or 2-hole / 3-hole punch	
	Paper size* <sup>9</sup>	Standard Size: Max A3, 11 x 17", Min JIS B5 (2-hole punch, 3-hole punch), A4 (4-hole punch) Custom Size: 203 x 182 mm to 297 x 431 mm	
	Paper weight	52 to 220 g/m <sup>2</sup>	

Item		Description	
		Finisher	Finisher with Booklet Maker
Booklet Finishing	Capacity* <sup>10</sup>	-	Saddle Staple: 30 sheets (90 g/m <sup>2</sup> or less) Single Fold: 5 sheets (220 g/m <sup>2</sup> or less)
	Paper size	-	Standard Size: Max SRA3 (320 x 450 mm), 12.6×19.2" (320 x 488 mm), Min JIS B5 Custom Size: 182 x 257 mm to 330 x 488 mm
	Paper weight	-	60 to 350 g/m <sup>2</sup>
Power supply		AC 100-127 V +/- 10 %, 3 A, AC 200-240 V +/- 10 %, 1.8 A, 50/60 Hz common	
Maximum power consumption		360 W	
Dimensions		W 855 x D 725 x H 1204 mm With Folder Unit: W 1092 x D 725 x H 1204 mm	With Folder Unit: W 1129 x D 725 x H 1204 mm
Weight		82 kg	102 kg

\*1: For paper longer than 330 x 488 mm, the capacity is not guaranteed. When the optional Banner Print Extension Kit is installed, 150 sheets of long paper up to 330 x 660 mm; 100 sheets of long paper up to 330 x 729 mm; 10 sheets of long paper up to 330 x 1200 mm can be stacked.

\*2: 82 g/m<sup>2</sup> paper

\*3: When larger size sheets are stacked on top of smaller size sheets.

\*4: 16 sets (17-20 sheets per print), 12 sets (21-25 sheets per print), 10 sets (26-30 sheets per print).

\*5: 65 sheets for sizes exceeding A4.

\*6: Available staple positions vary depending on the paper size.

\*7: One place rear angled stapling is supported on A4 and A3.

\*8: Optional.

\*9: Available number of punch holes varies depending on the paper size.

\*10: The maximum number of sheets varies depending on the paper weight. Booklet may not be tightly closed depending on the size or type of the paper.

#### Note

Interface Decurler Module is required.

## Number of Sheets That can be Stapled (Approximation)

Paper weight (g/m <sup>2</sup> )	Side stitch				Saddle stitch	
	When A4 size or less		When exceeding A4 size		Uncoated	Coated
	Uncoated	Coated	Uncoated	Coated		
52 to 59	100	35*	65	35*	30*	25*
60 to 71		35		35	30	25
72 to 80						
81 to 90						
91 to 105	50	30*	50	30*	20	20*
106 to 128		30	45	30	15	
129 to 150	20	20	20	20	10	
151 to 176					5	
177 to 220						
221 to 256						
257 to 350	10	10	10	10	3	

\*: Although staple is available, the stitch accuracy and paper feeding capability are not guaranteed.

\*: Although staple is available, the stitch accuracy and paper feeding capability are not guaranteed.

# Outputting Paper

## Top Output Tray

### Loading Guide

Place it on the Top Output Tray when using an envelope.

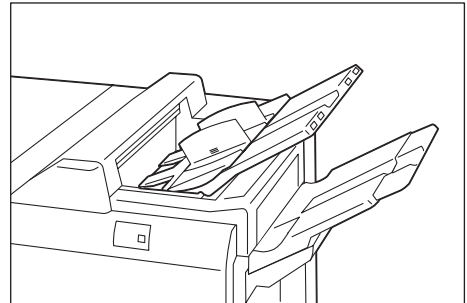

### Changing Angle

Change the angle when output paper remains at the exit and paper full is detected immediately. Especially in the following case, paper full is likely to be detected, change the angle to the B position.

- Thin coated paper
- Coated paper with the length of 364 mm or more
- Long paper

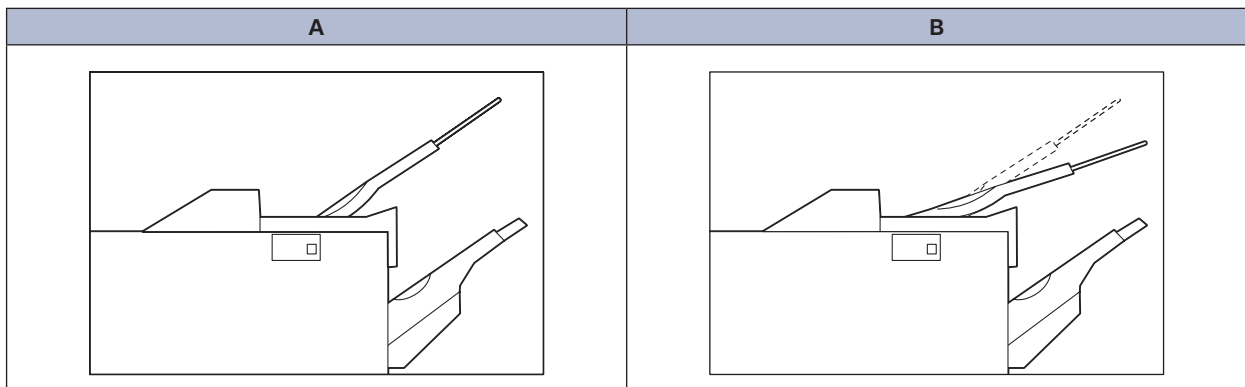

Pull the Top Output Tray to the right, remove it from the lower fixed position (A), and insert the claws at the front edge of the tray to the upper fixed position (B).

#### Note

- Normally set the tray at the lower fixed position.  
If the tray is at the upper fixed position of the exit, paper may fall from the Top Output Tray and a paper jam may occur when paper is output to the Finisher tray.
- If paper is curled, the effectiveness of angle change cannot be obtained.

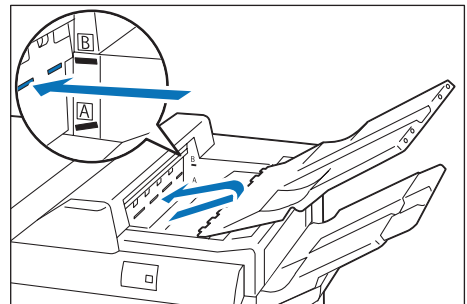

## ■ Banner Print Extension Kit

Long paper can be loaded without its lead edge sticking out.

Paper size (mm)	Tray capacity (sheets)
Width: 210 to 330.2 Length: 488.1 to 1,200	Up to 660 mm: 150 Up to 729 mm: 100 More than 729.1 mm: 10
	<div>Note</div> <p>This value applies if 82 g/m<sup>2</sup> paper is used.</p>

### Important

When paper exceeding the tray capacity is loaded, the Extension Tray may get broken.

## ■ Extension Tray

- (1) Push the Top Output Tray from the rear side as pinching the cap and remove the 4 caps at the front edge of the Top Output Tray.

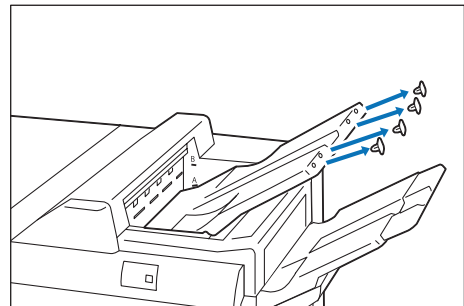

- (2) Change the angle of the Top Output Tray to the upper fixed position (B).

### Note

Change the angle to the lower fixed position (A) for paper with the width of 256 mm or less.

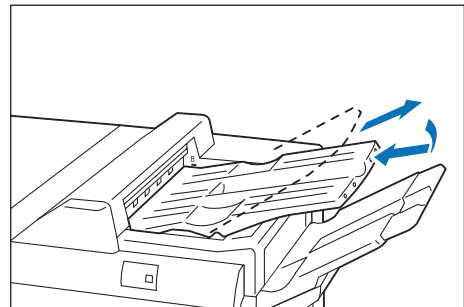

- (3) Insert 2 extension trays until they stop.

### Note

Pass them through over the guide at the rear side of the tray until they stop.

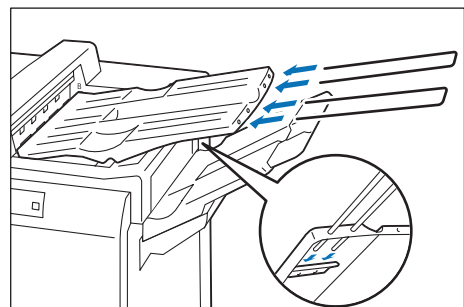

## ■ Lightweight paper housing wire

When it is difficult to load thin paper, install the wire.

### Note

- The tray capacity is 10 sheets.
- Paper of which width is 256 mm or less cannot be used.
- The supported paper weights are from 82 to 209 g/m<sup>2</sup>.

- (1) Change the angle of the Top Output Tray to the lower fixed position (A).

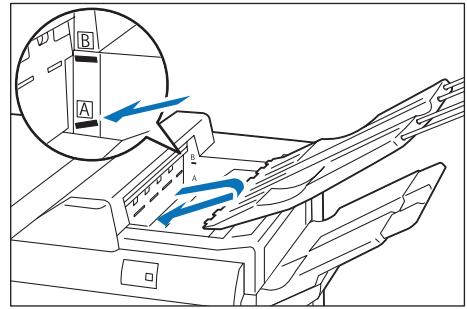

- (2) Install the wires on the extension trays.

**Note**

As holding the extension tray with a hand, insert the fixing devices firmly, and check that the wires will not come off from the extension tray.

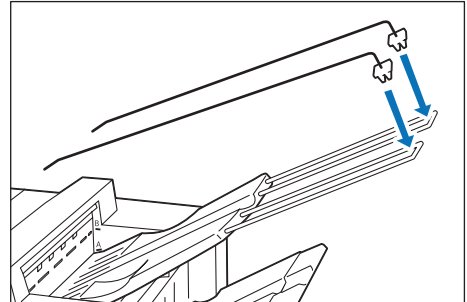

- (3) Adjust the wire positions as aligning the wires with the "▲" marks.

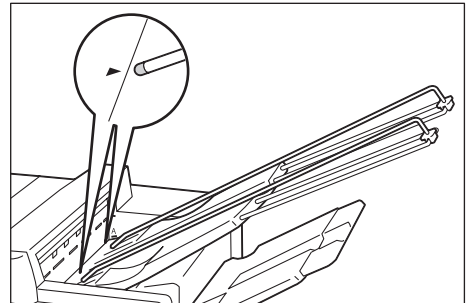

▪ **When not using the kit**

Store the kit in the storage case at the rear side of Finisher.

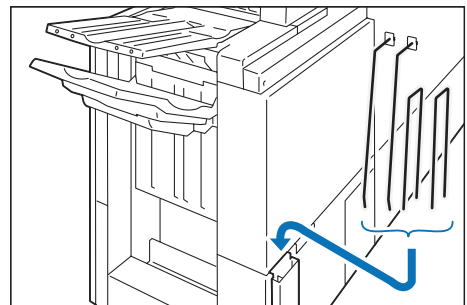

**Paper Curl**

- If A5<sub>LP</sub> is curled upward, a paper jam may occur.

Set the highest curl correction of Interface Decurler Module and upward curl correction of Inserter.

- If thick paper is curled downward, a paper jam may occur.  
Set the lowest curl correction of Interface Decurler Module and downward curl correction of Inserter.
- If paper of 157 g/m<sup>2</sup> or more is curled upward, a paper jam may occur.  
Set the highest curl correction of Interface Decurler Module and upward curl correction of Inserter.

**Refer**

"Curl Correction" (p.36)

# Staple Cartridge

---

## Replacing Staple Cartridge / Staple Waste Container

Consumables recommended by SHARP are manufactured under the standards suitable for this machine. Using consumables not recommended by SHARP may affect print quality or performance provided by the product. Use consumables that SHARP recommends for this machine. To place orders for consumables, take a note of the part number and contact your dealer or nearest SHARP Service Department.

When the end of life for a consumable is reached, a message appears on the Printer User Interface. Replace the consumable indicated in the message.

For the replacement method, refer to the steps provided on the box of the consumable (or label).

### Important

Proper disposal is required for consumables no longer needed. Do not open consumables. Return them to your dealer or nearest SHARP Service Department.

### Note

- Replacing consumable while the machine is on.
- Use up the staples before replacing.

### ■ Staple Cartridge for Side Stitch

You can check the existence of the staples in the residual quantity window.

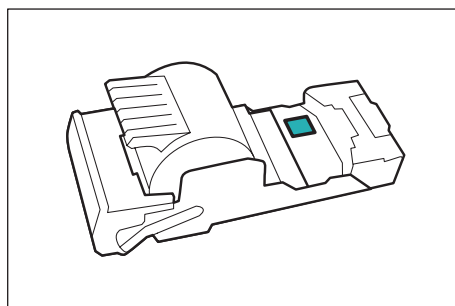

## Staple Jams

If paper is not being stapled or if staples are bent, follow the procedures mentioned in the following pages.

If the issue isn't resolved even after the procedure, contact your dealer or nearest SHARP Service Department.

Paper is not stapled

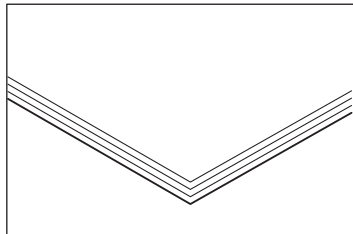

Staple is bent

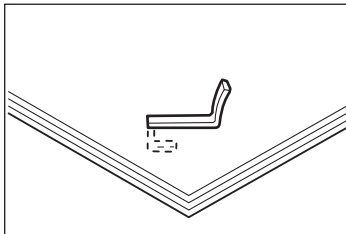

If the staple looks like any of the following images, contact your dealer or nearest SHARP Service Department.

One side of the staple is loose

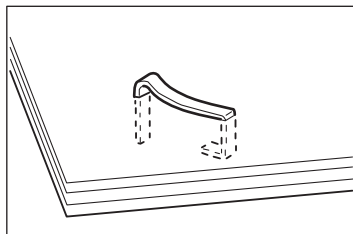

Staple is bent in the wrong direction

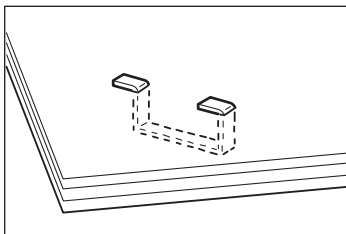

Staple is collapsed

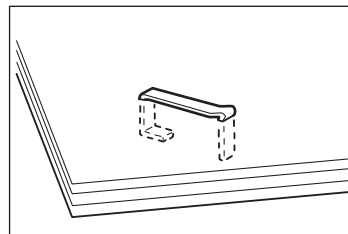

Staple is loose

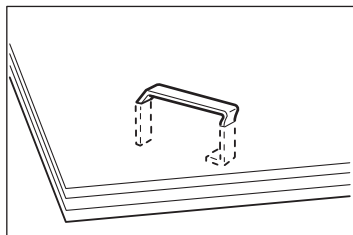

Staple is loose, and the center sinks

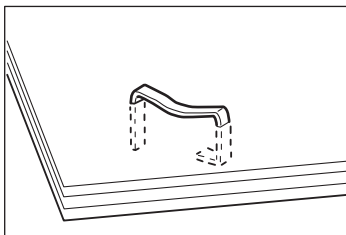

### Caution

Please be very careful not to hurt your fingers, etc. when removing the jammed staple.

#### Note

- Depending on the usage condition, such as the paper type, staples may be bent or bent staples may be caught inside of the unit, causing paper jamming.
- If you open the Staple Cartridge cover, be sure to remove all bent staples. Not removing bent staples may cause staple jamming. Only open the Staple Cartridge cover when you are removing the jammed staples.

## Staple Cartridge for Side Stitch

1. Confirm that the machine is not operating, and open the Cover.

2. Pull out [R1].

### Note

After removing the Staple Cartridge, check to make sure that there is no staple inside of the Finisher.

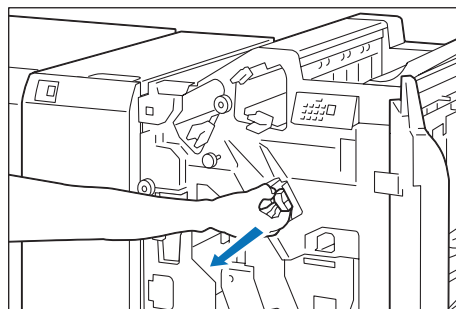

3. Open the cover of the unit and remove the jammed staples.

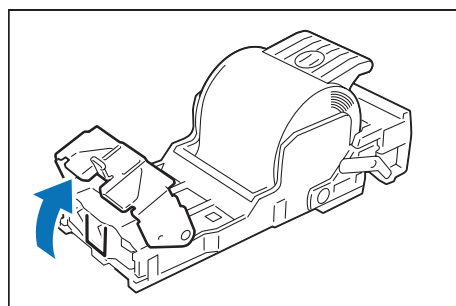

4. Insert the unit into the original position.

5. Close the cover.

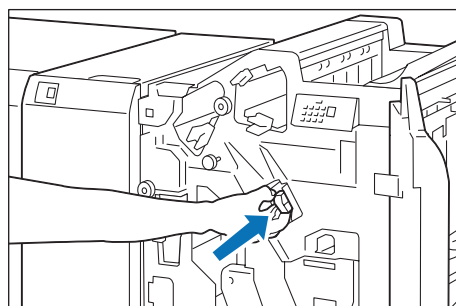

## Staple Cartridges for Saddle Stitch

1. Confirm that the machine is not operating, and open the Cover.

2. Pull out Booklet Maker [3].

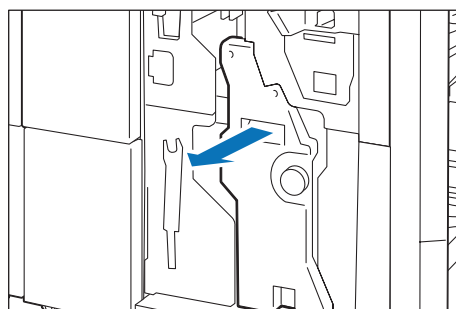

3. Hold the handle of the Staple Cartridge (R2)(R3) and pull it out.

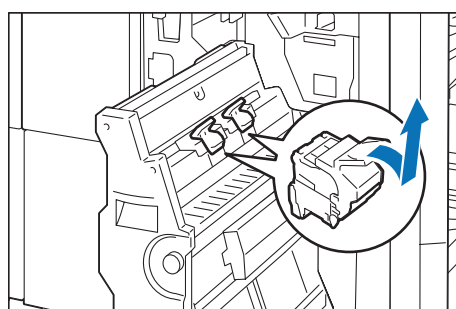

**4. Remove the jammed staples.**

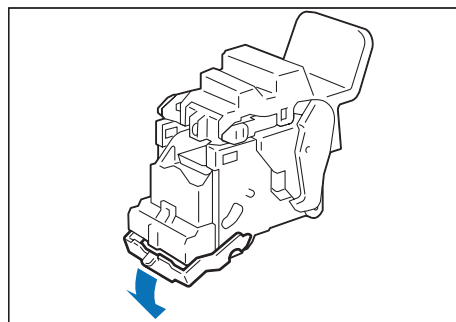

**5. Insert the Staple Cartridge into the original position.**

Hold the handle and lightly press it up until you hear a click.

**Note**

Align the “▲” marks.

**6. Push in the Booklet Maker [3].**

**7. Close the cover.**

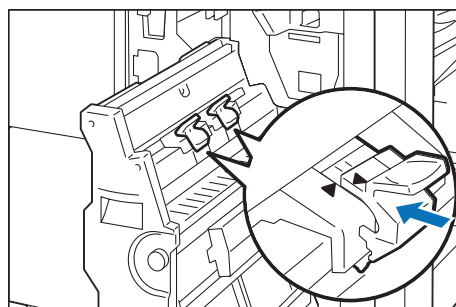

## When Staple Cartridge for Side Stitch Comes off

If the Staple Cartridge comes off from the unit due to fall during operation, etc., perform the following steps.

**⚠ Caution**

Please be very careful not to hurt your fingers, etc. when removing the deformed staples.

**Note**

Perform the same steps as well when the Staple Cartridge is separated from the unit.

**1. Open the cover of the unit and remove all the deformed staples.**

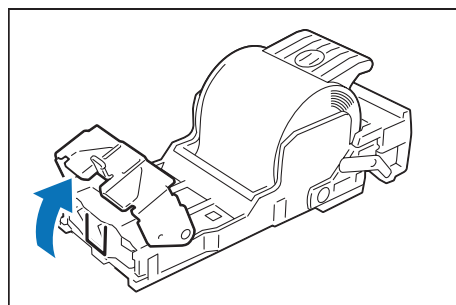

**2. Move the handle on the rear side of the unit in the arrow direction.**

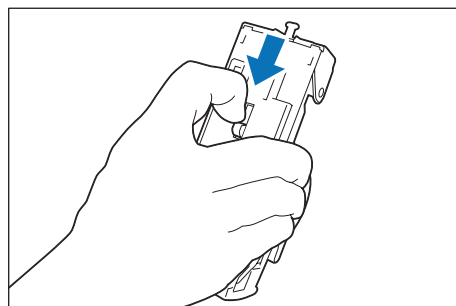

- 3. Turn it over as the handle is at the moved position and take out the Staple Cartridge from the unit.**

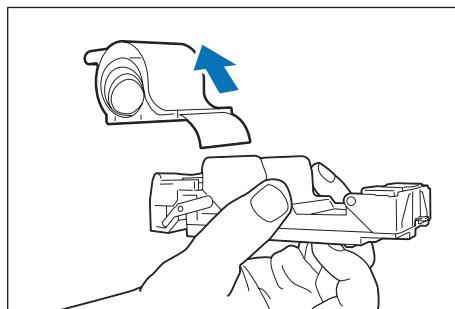

- 4. Remove the staples that stick out from the Staple Cartridge.**

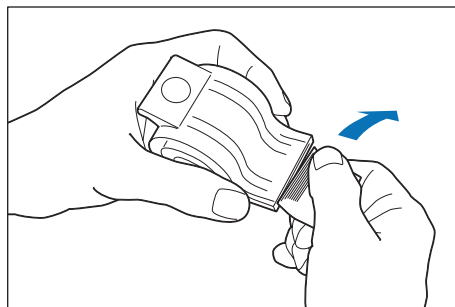

### **Caution**

Please be very careful not to hurt your fingers, etc. when separating staples.

- 5. Insert the Staple Cartridge into the unit.**

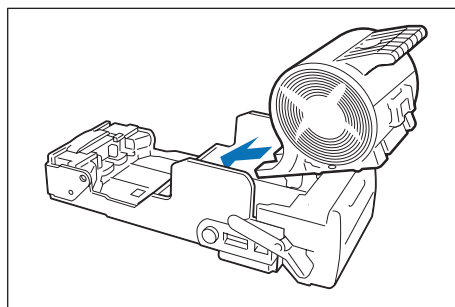

# Paper Jams

## Note

The error indicator at the top of the machine is turned on. When the priority device indicator (top lamp) blinks, first of all perform the paper jam operation.

If paper is jammed, the machine stops and an alarm sounds. Follow the instructions displayed on the screen to remove the jammed paper.

Gently remove the paper being careful not to tear it. If paper is torn while it is being removed from the machine, remove all the torn pieces making sure that none remain inside the machine.

When you have finished clearing the paper jam, printing is resumed from the state before the paper jam occurred.

## Note

Clear the paper jams while the machine is on.

## Finisher

### 1. Open the Cover.

### 2. Remove the jammed paper.

When Indicator E1 is Turned on.....	p.78
When Indicator E2 is Turned on.....	p.79
When Indicator E3 is Turned on.....	p.79
When Indicator E4 is Turned on.....	p.79
When Indicator E5 is Turned on.....	p.79
When Indicator E6 is Turned on.....	p.80

### ■ When Indicator E1 is Turned on

- (1) Open lever [1a] to the left (①) and remove the jammed paper (②).

## Note

Hold the lead edge of the paper and remove it.

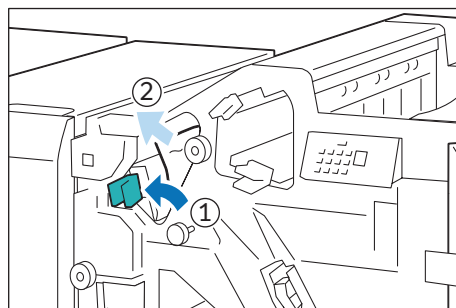

- (2) If you have difficulty in removing the papers, turn knob [1b] clockwise (①) and remove the jammed paper (②).

- (3) Return lever [1a].

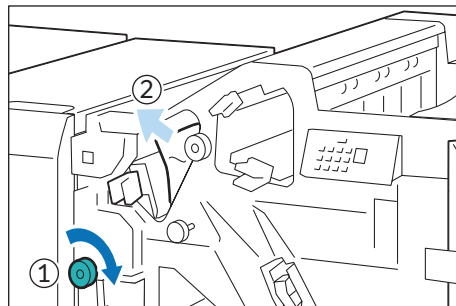

.....

### ■ When Indicator E2 is Turned on

- (1) Open lever [1c] to the right (①), turn knob [1e] clockwise (②), and remove the jammed paper (③).

**Note**

Jammed paper may be hidden at the upper section.

- (2) Return lever [1c].

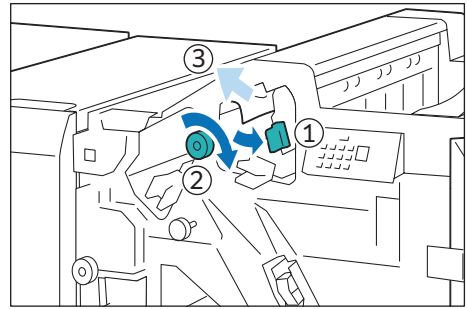

.....

### ■ When Indicator E3 is Turned on

- (1) Remove the jammed paper that sticks out from the exit of the Top Output Tray.
- (2) Open and close the cover.

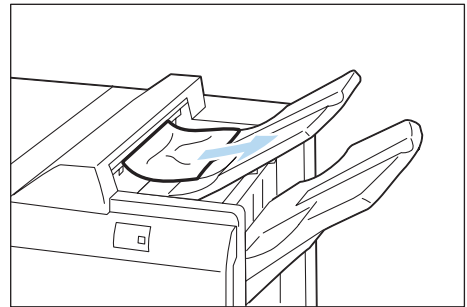

.....

### ■ When Indicator E4 is Turned on

- (1) Open lever [1d] to the right (①), turn knob [1e] clockwise (②), and remove the jammed paper (③).
- (2) Return lever [1d].

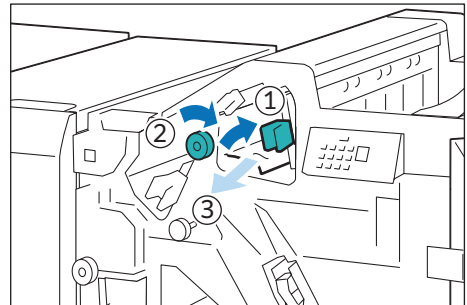

.....

### ■ When Indicator E5 is Turned on

- (1) Open lever [1d] to the right (①), turn knob [1f] counter-clockwise (②), and remove the jammed paper (③).
- (2) Return lever [1d].

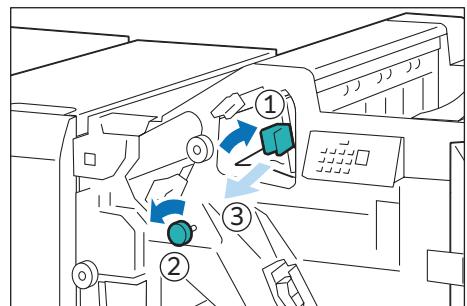

## ■ When Indicator E6 is Turned on

- (1) Remove the jammed paper that sticks out from the exit of the Finisher Tray.
- (2) Open and close the cover.

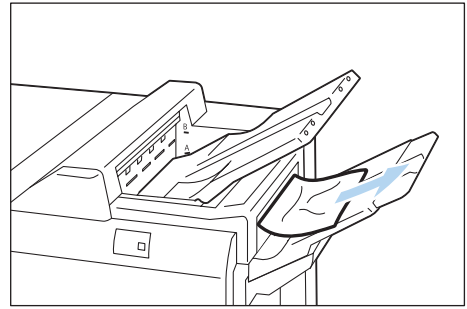

## 3. Close the cover.

## 4. Check the curl direction of the jammed paper and correct the curl.

### Refer

"Curl Correction" (p.36)

## Booklet Maker

### 1. Open the Cover.

### 2. Remove the jammed paper.

When Indicator E7 is Turned on.....	p.80
When Indicator E8 is Turned on.....	p.81
When Indicator E9 is Turned on.....	p.81

## ■ When Indicator E7 is Turned on

- (1) Open lever [3a] to the left (①) and remove the jammed paper (②).

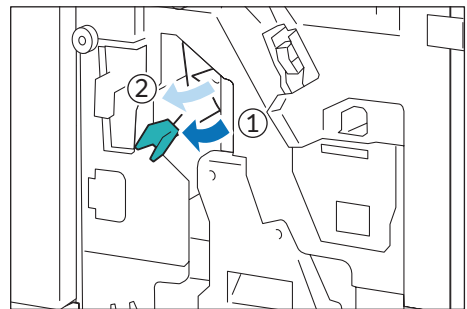

- (2) If you have difficulty in removing the papers, pull out Booklet Maker [3] (①), and remove the jammed paper (②).

### (3) Return lever [3a].

### (4) Push in the Booklet Maker [3].

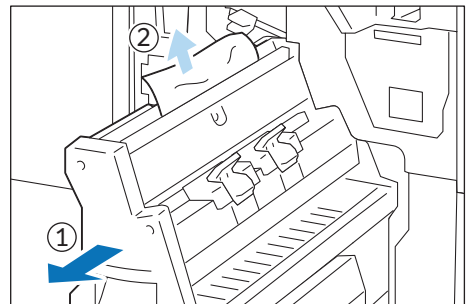

.....

### ■ When Indicator E8 is Turned on

- (1) Pull out Booklet Maker [3].

**Note**

Confirm that paper is not jammed at the lever [3a] before pulling it out.

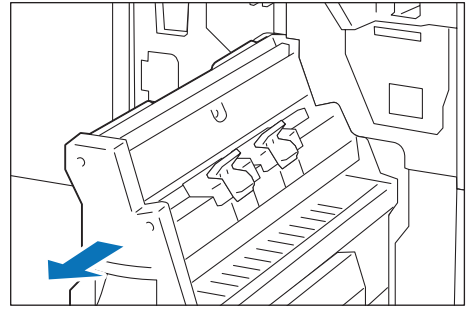

- (2) Turn knob [3b] counterclockwise (①) and remove the jammed paper (②).

- (3) Push in the Booklet Maker [3].

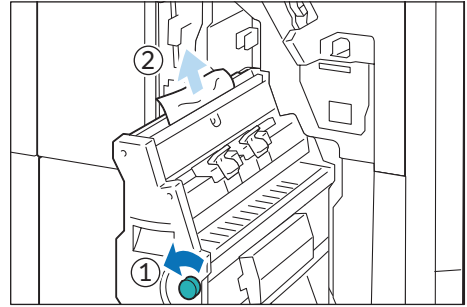

.....

### ■ When Indicator E9 is Turned on

- (1) Turn knob [3b] clockwise (①) and remove the jammed paper that sticks out from the exit of the Booklet Tray (②).

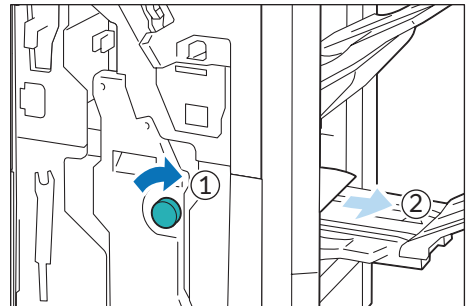

- .....
3. Close the cover.

4. Check the curl direction of the jammed paper and correct the curl.

**Refer**

"Curl Correction" (p.36)

# 10 Square Back Fold Trimmer

## Device Components / Caution Labels

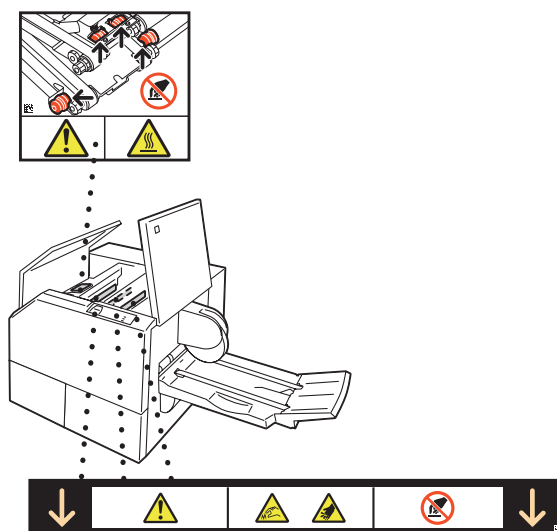
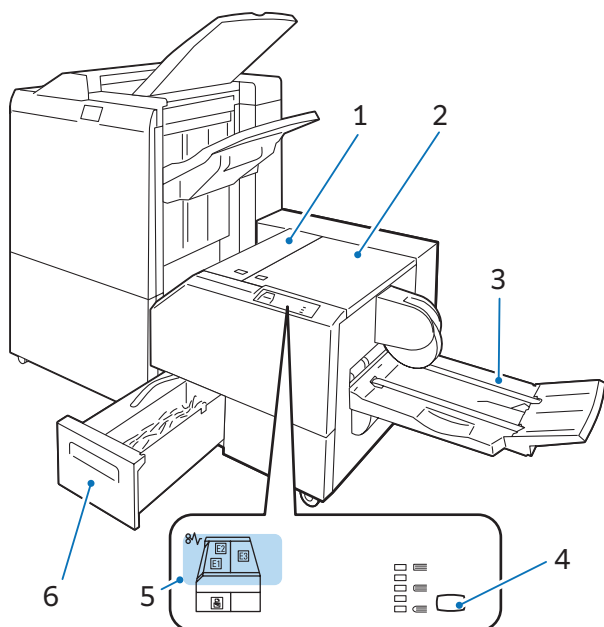

No.	Component	Function
1	Left Cover	Open this cover to clear paper jams.
2	Right Cover	Open this cover to clear paper jams.
3	Booklet Tray	Outputs are delivered here.  <b>Note</b>  When Square Back is performed, a thin press mark parallel to the back is made. If Fore Edge Trim is performed, a thin press mark parallel to the fore edge may be made. In either case, a press mark becomes outstanding as a booklet becomes thicker.
4	Back Pressing Level Button	Press this button to change the roundness of the back of a saddle stitched booklet. The higher the indicator, the higher the pressing force. The lower the indicator, the lower the pressing force.
5	Error Indicator	When paper jam occurs, the indicator is turned on.
6	Trimmer Waste Box	Cut pieces go in here.

## Main Specifications

Item		Description
Paper size		Same as the paper size of the Finisher Booklet Finishing.
Paper weight		Same as the paper weight of the Finisher Booklet Finishing.
Booklet Tray capacity <sup>*1</sup>		20 sets <sup>*2</sup>
Face Trim	Capacity <sup>*2</sup>	Saddle Staple: 30 sheets, Single Fold: 5 sheets
	Trim dimensions	2 to 20 mm
Square Back capacity <sup>*3*4</sup>		30 sheets
Power supply		AC 100-240 V +/- 10 %, 0.8 A (100 V) / 0.4 A (240 V), 50/60 Hz common
Maximum power consumption		96 W
Dimensions		W 1066 x D 725 x H 552 mm
Weight		97 kg

\*1: Storing may not be possible up to this value depending on your use conditions, such as of paper type.

\*2: 16 sets (17-20 sheets per print), 12 sets (21-25 sheets per print), 10 sets (26-30 sheets per print).

\*3: The capacity can decrease depending on type and weight of paper being used and other conditions.

\*4: Square back finishing is not supported for single-folding and saddle stapling of less than 5 sheets.

### Note

Finisher with Booklet Maker is required.

## Waste Container

### Note

Dispose cut pieces while the machine is on.

1. Confirm that the machine is not operating, and pull out the waste container.

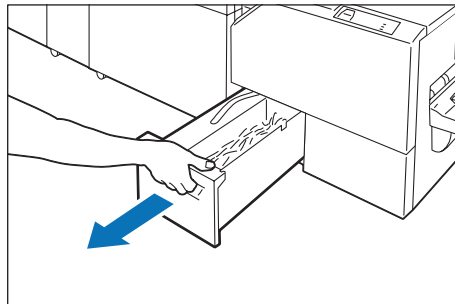

2. Hold the belt of the waste container and pull it out with both hands.

### Note

Do not apply excessive load on the belt by twirling the container as holding the belt, etc. Otherwise, the belt may get broken.

3. Dispose all cut pieces.

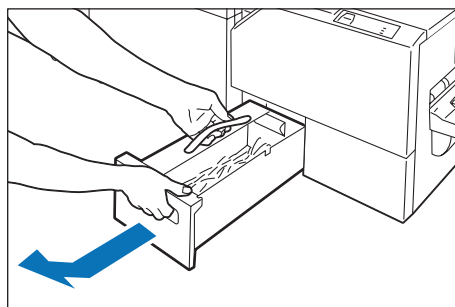

### ⚠ Caution

Do not collect cut pieces with hands. You may get injured with cutting edges.

4. Insert the Waste Container into the original position.

# Paper Jams

## Note

The error indicator at the top of the machine is turned on.

If paper is jammed, the machine stops and an alarm sounds. Follow the instructions displayed on the screen to remove the jammed paper.

Gently remove the paper being careful not to tear it. If paper is torn while it is being removed from the machine, remove all the torn pieces making sure that none remain inside the machine.

When you have finished clearing the paper jam, printing is resumed from the state before the paper jam occurred.

## Note

Clear the paper jams while the machine is on.

### 1. Remove the jammed paper.

When Indicator E1 is Turned on.....p.85

When Indicator E2 is Turned on.....p.86

When Indicator E3 is Turned on.....p.86

## Note

The left and Right Covers cannot be opened at the same time. Remove paper in one cover and close it. Then open the other cover.

### ■ When Indicator E1 is Turned on

#### (1) Open the Left Cover.

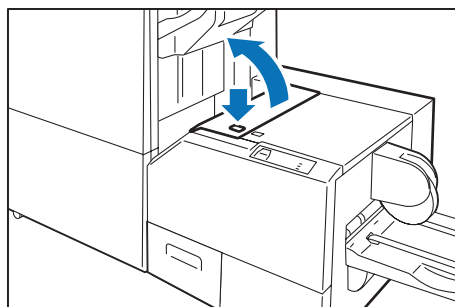

#### (2) Remove the jammed paper.

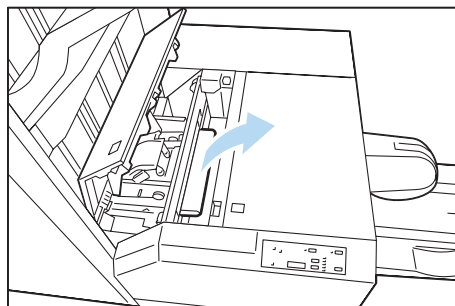

#### (3) If you have difficulty in removing the papers, open the Finisher cover.

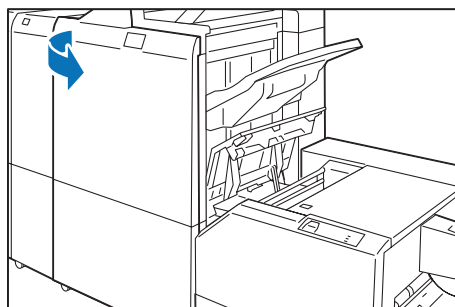

(4) Turn knob [3b] clockwise and remove the paper.

(5) Close the Left Cover.

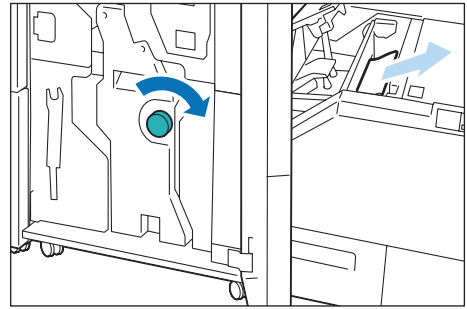

.....

■ When Indicator E2 is Turned on

(1) Open the Left Cover.

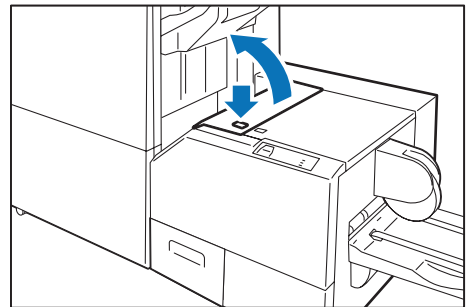

(2) Remove the jammed paper.

(3) Close the Left Cover.

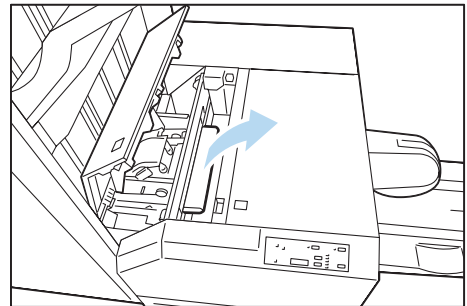

.....

■ When Indicator E3 is Turned on

(1) Open the Right Cover.

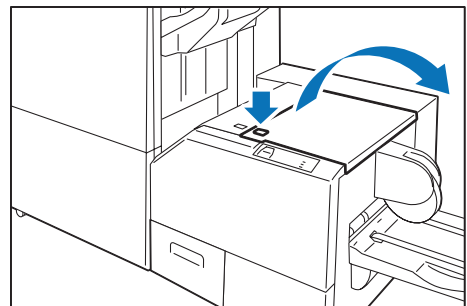

(2) Remove the jammed paper.

(3) Close the Right Cover.

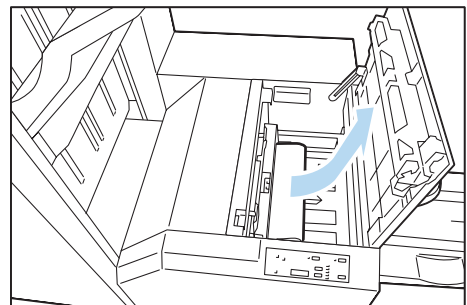

# **SHARP**

## **SHARP CORPORATION**

December 2023 Edition 1

GM1876E5-1